



N64W23760 Main Street
Sussex, Wisconsin 53089
Phone (262) 246-5200
Email: info@sussexwi.gov
Website: www.sussexwi.gov

VILLAGE BOARD AGENDA
VILLAGE OF SUSSEX
6:00 PM TUESDAY, OCTOBER 22, 2024
SUSSEX CIVIC CENTER – BOARD ROOM 2nd FLOOR
N64W23760 MAIN STREET

1. Roll call.
2. Pledge of Allegiance.
3. Consideration and possible action on minutes of the Village Board Budget Workshop meetings held on September 4, 2024, September 10, 2024 and the Village Board meeting held on September 24, 2024.
4. Communications and Public Hearings
 - A. Village President Report. Report on meetings, communications, and recognitions.
5. Committee Reports
 - A. Board of Fire Commissioners Report on discussion and action taken at the previous meeting, future agenda items and upcoming meetings.
 - B. Community Development Authority Report on discussion and action taken at the previous meeting, future agenda items and upcoming meetings.
 - C. Finance and Personnel Committee. Report on discussion and action taken at the previous meeting, future agenda items and upcoming scheduled meetings.
 1. Recommendation and possible action on September check register and p-card.
 2. Recommendation and possible action on Ace Hardware purchases.
 - D. Park & Recreation Board. Report on discussion and action taken at the previous meeting, future agenda items and upcoming meetings.
 - E. Pauline Haass Library Board. Report on discussion and action taken at the previous meeting, future agenda items and upcoming meetings.
 - F. Plan Commission. Report on discussion and action taken at the previous meeting, future agenda items and upcoming scheduled meetings.
 1. Recommendation and possible action on a Certified Survey Map combining and dividing lands on Maple Avenue identified by Tax Key Numbers 199.989.005, 199.989.004, 199.989.003, 199.989.002.
 - G. Public Safety and Welfare. Report on discussion and action taken at the previous meeting, future agenda items and upcoming meetings.
 - H. Public Works Committee. Report on discussion and action taken at the previous meeting, future agenda items and upcoming scheduled meetings.
 1. Recommendation and possible action on Public Works bills for payment.
6. Staff Reports on upcoming events, projects, future agendas and scheduled meetings

7. Comments from citizens present.
8. Old Business.
9. New Business.
 - A. Consideration and possible action on 2025 Sussex WWTF Rehabilitation Project Intermunicipal Agreement with the Villages of Lannon, Lisbon, Menomonee Falls, and Sussex.
10. Consideration and possible action on resignations and appointments.
 - A. Swimming Pool Feasibility Study Committee appointments
11. Adjournment

Anthony LeDonne
Village President

Jeremy Smith
Village Administrator

It is possible that members of and possibly a quorum of members of other governmental bodies of the municipality may be in attendance at the above stated meeting to gather information; no action will be taken by any governmental body at the above stated meeting other than the governmental body specifically referred to above in this notice. Upon reasonable notice, efforts will be made to accommodate the needs of disabled individuals through appropriate aids and services. For additional information or to request this service, contact Jeremy Smith at 246-5200.

**DISCLAIMER – THE FOLLOWING ARE DRAFT MINUTES FROM
THE VILLAGE BOARD AND ARE
SUBJECT TO CHANGE UPON APPROVAL OF THE VILLAGE BOARD**

**VILLAGE OF SUSSEX
SUSSEX, WISCONSIN**

**Minutes of the Village Board Budget Workshop of
September 4, 2024**

1. Roll Call

The meeting was called to order by President LeDonne at 5:30pm.

Members present: Trustees Stacy Riedel, Greg Zoellick, Lee Uecker, Scott Adkins, Benjamin Jarvis, Ron Wells, and President Anthony LeDonne

Members excused: None

Also present: Assistant Village Administrator Kelsey McElroy-Anderson, Village Administrator Jeremy Smith, Finance Director Taylor Walls, Clerk/Treasurer Jennifer Moore, Chief Kristopher Grod, Captain Lisa Panas, Village Engineer Judith Neu, Community Development Director Gabe Gilbertson, Park and Recreation Director Halie Dobbeck, Library Director Adele Loria, and members of the public.

2. Presentation of the 2025 Budget

Administrator Smith presented the proposed 2025 Village budget.

3. Adjournment

A motion by LeDonne, seconded by Uecker to adjourn at 6:30PM.

Motion carried 7-0

Respectfully submitted,
Jennifer Moore
Village Clerk

**DISCLAIMER – THE FOLLOWING ARE DRAFT MINUTES FROM
THE VILLAGE BOARD AND ARE
SUBJECT TO CHANGE UPON APPROVAL OF THE VILLAGE BOARD**

**VILLAGE OF SUSSEX
SUSSEX, WISCONSIN**

**Minutes of the Village Board Budget Workshop of
September 10, 2024**

1. Roll Call

The meeting was called to order by President LeDonne at 5:30pm.

Members present: Trustees Stacy Riedel, Greg Zoellick, Lee Uecker, Scott Adkins, Benjamin Jarvis, Ron Wells, and President Anthony LeDonne

Members excused: None

Also present: Assistant Village Administrator Kelsey McElroy-Anderson, Village Administrator Jeremy Smith, Finance Director Taylor Walls, Clerk/Treasurer Jennifer Moore, Chief Kristopher Grod, Captain Lisa Panas, Village Engineer Judith Neu, Community Development Director Gabe Gilbertson, Park and Recreation Director Halie Dobbeck, and members of the public.

2. Tour of CIP Projects

Administrator Smith led a tour of the community and presented information at various stops including the 2025 Road Program, Public Works Garage, Armory Park, and Village Park.

3. 2025 Budget

Administrator Smith presented the proposed 2025 CIP Projects and other items relating to the 2025 Village budget.

Motion by LeDonne, seconded by Jarvis to approve inclusion of the 2025 Road Program in the 2025 Village Budget.
(Zoellick voted no) Motion carried 6-1

Motion by LeDonne, seconded by Jarvis to approve inclusion of the CIP for signs and lights in the 2025 Village budget.
(Adkins, Jarvis, Riedel, LeDonne, Zoellick, and Wells voted no) Motion failed 1-6

Motion by LeDonne, seconded by Uecker to approve inclusion of a new park shop in the 2025 Village budget.
Motion carried 7-0

Motion by LeDonne, seconded by Uecker to approve inclusion of The Ridge Pavilion at Village Park in the 2025 Village budget. (Riedel, Adkins, and Zoellick voted no) Motion carried 4-3

Motion by LeDonne, seconded by Uecker to approve raising the fire inspection fees beginning in 2025.
Motion carried 7-0

Motion by LeDonne, seconded by Riedel to approve a wheel tax beginning in 2025.
(Adkins, Jarvis, LeDonne, Zoellick, Wells, and Uecker voted no) Motion failed 1-6

4. Adjournment

A motion by Adkins, seconded by Zoellick to adjourn at 8:20PM. Motion carried 7-0

Respectfully submitted,
Jennifer Moore
Village Clerk

**DISCLAIMER – THE FOLLOWING ARE DRAFT MINUTES FROM
THE VILLAGE BOARD AND ARE
SUBJECT TO CHANGE UPON APPROVAL OF THE VILLAGE BOARD**

**VILLAGE OF SUSSEX
SUSSEX, WISCONSIN**

**Minutes of the Village Board Meeting of
September 24, 2024**

1. Roll Call

The meeting was called to order by President LeDonne at 6:04pm.

Members present: Trustees Stacy Riedel, Greg Zoellick, Lee Uecker, Scott Adkins, Benjamin Jarvis, Ron Wells, and President Anthony LeDonne

Members excused: None

Also present: Assistant Village Administrator Kelsey McElroy-Anderson, Village Administrator Jeremy Smith, Village Attorney John Macy, Clerk/Treasurer Jennifer Moore, and members of the Public.

2. Pledge of Allegiance

President LeDonne led the pledge of allegiance.

3. Meeting Minutes

A motion by Jarvis, seconded by Zoellick to approve the August 27, 2024 Village Board meeting minutes.

Motion carried 7-0.

4. Communications and Public Hearings

A. Village President Report

The Village President listed several upcoming meetings and events in the Village of Sussex including:

10/3 – Celebration of Artists Opening Night 5:00 – 7:00pm

10/15 – Plan Commission meeting

10/15 – Park and Recreation Board meeting

10/18 – Spooky Sussex

10/22 – Village Board meeting

10/26 – Village Trick or Treat 6:00 – 8:00pm

5. Committee Reports

A. Board of Fire Commissioners Report

Interviewed and approved full time candidates and acknowledged resignations.

B. Community Development Authority

Nothing to report.

C. Finance and Personnel Committee Report

1. Motion by Jarvis, seconded by Zoellick to approve the August Check Register and P-card Statement in the amount of \$1,787,411.91. Motion carried 7-0

2. Motion by Jarvis, seconded by Riedel to approve the July Ace Hardware purchases in the amount of \$537.69. Motion carried 6-0
(LeDonne Abstained)

3. Motion by Jarvis, seconded by Uecker to approve the Class “A” Retail License for the Sale of Fermented Malt Beverages & “Class A” Retail License for the Sale of Intoxicating Liquors September 25, 2024 through June 30,

2025, for VAM United, Inc, W232N6116 Waukesha Avenue, Sussex, 53089, for Quick Corners, Agent: Poojaben Patel subject to the standard conditions of the liquor license approval, approval by the Plan Commission of the conditional use permit to operate, and transfer of the operations to the above entity from the current license holder. Motion carried 7-0

4. Motion by Jarvis, seconded by Wells to approve Amusement Device Licenses September 25, 2024 through June 30, 2025, for VAM United, Inc. for Quick Corners (W232N6116 Waukesha Avenue) – 4 permits subject to the standard conditions of license approvals and transfer of the operations to the above entity from the current license holder. Motion carried 7-0

D. Park & Recreation Board Report

1. Motion by Wells, seconded by Adkins to approve the Special Event Rental: Disc Golf for Life. The event is Saturday October 12, 2024 from 8am-2pm and will use the North Open Air and Disc Golf Course. Motion carried 7-0
2. Motion by Wells, seconded by Adkins to approve the Village Sign Policy Updates as proposed. Motion carried 7-0

E. Pauline Haass Library Board Report

1. Trustee Zoellick presented an update from the previous Library Board meeting.

F. Plan Commission Report

1. Motion by Zoellick, seconded by LeDonne to approve and grant Vista Run LLC a waiver from Section 18.0902(B) to establish 35 lots in the Vista Run VI phase of the Vista Run subdivision based on the consideration of numerous factors listed in the agenda packet and that the public improvements are established prior to the plat recording and that the plat shall not be recorded until the year 2025. Motion carried 7-0
2. Motion by Zoellick, seconded by Wells to approve the Final Plat for Vista Run Phase VI subject to the following conditions:
 - a. The standard conditions of Plat approval that are not in conflict with Wis. Stats. 236.13.
 - b. Payment of all fees and subject to the standard conditions of Exhibit A.
 - c. The Floodplain line shown on this plat will likely change as part of a permit to fill the wetland / floodplain and remove lots 145, 146 and 148-150 from the floodplain. The LOMR shall be finalized before the plat is recorded.
 - d. Obtain all necessary Village permits for filling/disturbing any wetlands.
 - e. Final review and conditions from Waukesha County and the Wisconsin DOA being addressed.
 - f. Completion of the Public Improvements per the Developer's Agreement and compliance with the other terms of the Developer's Agreement.Motion carried 7-0

G. Public Safety and Welfare Report

1. Motion by Riedel, seconded by Wells to approve the 2025-2027 Contract Police Citation Services with the Village of Lisbon, Village of Merton, and Town of Delafield. Motion carried 7-0
2. Motion by Riedel, seconded by Zoellick to approve Resolution 24-15 Approving Damage Assessment MOU with Waukesha County. Motion carried 7-0
3. Motion by Riedel, seconded by Uecker to approve the annual request by the Sled Bugs to use Village trails for the upcoming snowmobile season. Motion carried 7-0

H. Public Works Committee Report

1. Motion by Adkins, seconded by Jarvis to approve the August invoices in the amount of \$51,866.35. Motion carried 7-0

2. Motion by Adkins, seconded by Riedel to approve the Salt Contract with Waukesha County for the 2024/2025 season. Motion carried 7-0

6. Staff Reports

Ms. McElroy – Anderson: This will be her last meeting with the Village of Sussex. Sussex has a lot to be proud of both residents and staff.

Mr. Smith: There were 30 applicants for the Assistant Village Administrator position. Staff will conduct eight first round interviews and second round interview for the three to four finalists.

October 18 is Spooky Sussex and volunteers are still needed.

The Village received a DNR \$100,000 grant for the Corky Curtis trail and made the initial cut list for a \$1 million grant also.

Mr. Macy: Is in the process of writing opinion letters for license denials and the use of personal email.

Ms. Moore: The Clerk’s office has sent almost 1,000 absentee ballots and we expect about 2,000 total in person absentee voters to come through during the two weeks of in person absentee voting that begins on October 22. Voter registration is also up by approximately 200 since the August election.

7. Comments from Citizens Present

None

8. Old Business

None

9. New Business

None

10. Consideration on resignation and appointments

None

11. Adjournment

A motion by LeDonne, seconded by Wells to adjourn at 6:30PM.

Motion carried 7-0

Respectfully submitted,
Jennifer Moore
Clerk/Treasurer

MEMORANDUM

To: Village Board
From: Jennifer Moore
Re: Village Board Meeting- October 22, 2024
Date: October 17, 2024

N64W23760 Main Street
Sussex, Wisconsin 53089
Phone (262) 246-5211
FAX (262) 246-5222
Email: info@villagesussex.org
Website: www.villagesussex.org

4.A. Village President Report- report on meetings attending and upcoming communications.

5.C.1. The Finance and Personnel Committee recommends approval of August Check Register and P-card Statement in the amount of \$943,788.42. Please see the disbursement summary and registers for additional information.

5.C.2. The Finance and Personnel Committee recommends approval of the August Ace Hard, ware purchases in the amount of \$1,248.68. Please see the disbursement summary for additional information.

5.F.1. The Plan Commission recommends approval to the Village Board of a Certified Survey Map combining and dividing lands on Maple Avenue identified by Tax Key Numbers a Certified Survey Map combining and dividing lands on Maple Avenue identified by Tax Key Numbers 199.989.005, 199.989.004, 199.989.003, 199.989.002 subject to compliance with comments and conditions in the Memo from the Village Engineer dated October 3, 2024 and the standard conditions of CSM approval and Exhibit A. The applicant owns four lots along Maple Avenue. This CSM would create two lots out of those 4. Lot 1 contains the owner's house and pond (roughly 2.93 acres). Lot 2 contains the rental house and roughly .6 acres.

5.H.1. The Public Works Committee recommends approval of the September invoices in the amount of \$34,764.89. Please see the bills for more information.

9.A Staff recommends approval of the 2025 Sussex Wastewater Treatment Facility Rehabilitation Project Agreement between the Village of Sussex, the Village of Lannon, the Village of Lisbon, and the Village of Menomonee Falls. This agreement outlines the cost share for all the contributing communities. All of the other communities have already adopted the agreement. The work will be completed in 2025. Please see the agreement for more information.

10.A. The Village President has nominations for the Swimming Pool Feasibility Study Committee. This group will spend 2025 looking at options and making a recommendation back to the Park Board and Village Board on aquatic facilities. The study and committee was adopted by the Village Board. Please see the list of proposed members for more information.

**Village of Sussex
Village Board Payment Approvals
Sep-2024**

Payroll Registers

| | | |
|--------------------------------------|-----------------------------|---------------------|
| First Pay Period - Regular + Board | \$ 157,783.06 | |
| Second Pay Period - Regular + Board | <u>\$ 155,710.27</u> | |
| | | |
| Total Payroll | <u>\$ 155,710.27</u> | |
| | | |
| Check Register (09/01/24 - 98/30/24) | <u>\$ 788,078.15</u> | (less Ace Hardware) |
| | | |
| Grand Total | <u>\$ 943,788.42</u> | |

Report Criteria:

Report type: GL detail
 Vendor.Vendor number = {<>} 2
 Check.Type = {<>} "Adjustment"

| Check Issue Date | Check Number | Merchant Name | Description | Amount | Invoice GL Account | Invoice GL Account Title |
|------------------|--------------|------------------------------------|---|-----------|--------------------|-----------------------------|
| 09/05/2024 | 20964 | ABT, CHARLOTTE - ACH | REIMBURSEMENT - MILEAGE - 8/5-19/2024 | 15.68 | 100-55350-100-390 | DAY CAMP Expenses |
| 09/05/2024 | 20965 | BOEHM, JENNIFER - ACH | REIMBURSEMENT - WMCA CONFERENCE EXPE | 95.43 | 100-51420-000-390 | Expenses |
| 09/05/2024 | 20965 | BOEHM, JENNIFER - ACH | REIMBURSEMENT - WMCA CONFERENCE EXPE | 47.73 | 610-53700-000-930 | Misc General Expenses |
| 09/05/2024 | 20965 | BOEHM, JENNIFER - ACH | REIMBURSEMENT - WMCA CONFERENCE EXPE | 47.73 | 620-53610-100-345 | Supplies |
| 09/05/2024 | 20966 | BOUND TREE MEDICAL LLC | ELECTRODES, TEST STRIPS, CURAPLEX SET, B | 426.93 | 100-52200-000-342 | Medical Supplies |
| 09/05/2024 | 20967 | CARRICO AQUATIC RESOURCES - ACH | BULK PH DOWN | 369.50 | 100-55200-000-394 | Splashpad Operations |
| 09/05/2024 | 20968 | DOBBECK, HALIE - ACH | REIMBUSEMENT - MILEAGE - 6/24-9/4/2024 | 68.94 | 100-55300-000-390 | Expenses |
| 09/05/2024 | 20969 | E.H. WOLF & SONS INC-SLINGER | GAS PUMP REPAIR - TYPE D REPAIR PARTS KIT | 3.39 | 610-53700-000-933 | Transportation Expenses |
| 09/05/2024 | 20969 | E.H. WOLF & SONS INC-SLINGER | GAS PUMP REPAIR - TYPE D REPAIR PARTS KIT | 3.39 | 100-53311-000-239 | Gasoline & Diesel |
| 09/05/2024 | 20969 | E.H. WOLF & SONS INC-SLINGER | GAS PUMP REPAIR - TYPE D REPAIR PARTS KIT | 3.39 | 100-55200-000-239 | Gasoline & Diesel |
| 09/05/2024 | 20969 | E.H. WOLF & SONS INC-SLINGER | GAS PUMP REPAIR - TYPE D REPAIR PARTS KIT | 3.39 | 100-52200-000-239 | Gasoline & Diesel |
| 09/05/2024 | 20969 | E.H. WOLF & SONS INC-SLINGER | GAS PUMP REPAIR - TYPE D REPAIR PARTS KIT | 3.39 | 620-53610-100-330 | Transportation |
| 09/05/2024 | 20970 | HAWKINS INC - ACH | AZONE, MANGANESE SULFATE, SODIUM PERM | 13,561.70 | 610-53700-000-631 | Treatment-Chemicals |
| 09/05/2024 | 20971 | LANNON STONE PRODUCTS - ACH | 3/" & 3/4" BASE COURSE - VISTA PARK | 1,686.75 | 100-57620-000-820 | Improvements |
| 09/05/2024 | 20972 | LDK STUDIO FITNESS LLC - ACH | JAZZERCISE CLASSES 1/1-8/31/2024 | 3,724.60 | 100-55350-000-140 | Program Instructors |
| 09/05/2024 | 20973 | MOORE, JENNIFER - ACH | REIMBURSEMENT - WMCA CONFERENCE EXPE | 93.76 | 100-51420-000-390 | Expenses |
| 09/05/2024 | 20973 | MOORE, JENNIFER - ACH | REIMBURSEMENT - WMCA CONFERENCE EXPE | 46.89 | 610-53700-000-930 | Misc General Expenses |
| 09/05/2024 | 20973 | MOORE, JENNIFER - ACH | REIMBURSEMENT - WMCA CONFERENCE EXPE | 46.89 | 620-53610-100-345 | Supplies |
| 09/05/2024 | 20974 | PULVERMACHER, ANNE - ACH | REIMBURSEMENT - MILEAGE - METER READ | 77.05 | 610-53700-000-930 | Misc General Expenses |
| 09/05/2024 | 20975 | RUEKERT & MIELKE - ACH | 2024 GIS - 2021 & 2025 ROAD PROGRAMS | 2,268.75 | 410-57331-000-216 | Engineering |
| 09/05/2024 | 20976 | SCENIC VIEW MAINTENANCE - ACH | LAWN MOWING, TRIMMING & BLOWING-AUG 20 | 3,120.00 | 100-55200-000-399 | Horticulture |
| 09/11/2024 | 20977 | ASSOCIATED APPRAISAL CONSULT - ACH | ASSESSOR FEES-SEPT 2024 | 4,500.00 | 100-51530-000-218 | Assessor--Fees |
| 09/11/2024 | 20978 | BOUND TREE MEDICAL LLC | MEDICAL SUPPLIES | 400.94 | 100-52200-000-342 | Medical Supplies |
| 09/11/2024 | 20979 | CURALINC LLC - ACH | CURALINC | .49 | 280-54910-000-135 | Employee Insurance |
| 09/11/2024 | 20979 | CURALINC LLC - ACH | CURALINC | 39.12 | 100-14500 | Due from Haass Library |
| 09/11/2024 | 20979 | CURALINC LLC - ACH | CURALINC | 31.93 | 610-53700-000-926 | Employee Pension & Benefits |
| 09/11/2024 | 20979 | CURALINC LLC - ACH | CURALINC | 32.18 | 620-53610-100-135 | Employee Insurance |
| 09/11/2024 | 20979 | CURALINC LLC - ACH | CURALINC | 1.96 | 100-51491-000-135 | Employee Insurance |
| 09/11/2024 | 20979 | CURALINC LLC - ACH | CURALINC | 10.37 | 640-53650-000-135 | Employee Insurance |
| 09/11/2024 | 20979 | CURALINC LLC - ACH | CURALINC | 4.16 | 100-51410-000-135 | Employee Insurance |
| 09/11/2024 | 20979 | CURALINC LLC - ACH | CURALINC | 11.40 | 100-51420-000-135 | Employee Insurance |
| 09/11/2024 | 20979 | CURALINC LLC - ACH | CURALINC | 8.95 | 100-51510-000-135 | Employee Insurance |
| 09/11/2024 | 20979 | CURALINC LLC - ACH | CURALINC | 6.94 | 100-51430-000-135 | Employee Insurance |
| 09/11/2024 | 20979 | CURALINC LLC - ACH | CURALINC | 13.20 | 100-51600-000-135 | Employee Insurance |
| 09/11/2024 | 20979 | CURALINC LLC - ACH | CURALINC | 13.69 | 100-53311-000-135 | Employee Insurance |

| Check Issue Date | Check Number | Merchant Name | Description | Amount | Invoice GL Account | Invoice GL Account Title |
|------------------|--------------|-----------------------------------|---|-----------|--------------------|--------------------------------|
| 09/11/2024 | 20979 | CURALINC LLC - ACH | CURALINC | 2.30 | 100-53635-000-135 | Employee Insurance |
| 09/11/2024 | 20979 | CURALINC LLC - ACH | CURALINC | 4.83 | 100-52400-000-135 | Employee Insurance |
| 09/11/2024 | 20979 | CURALINC LLC - ACH | CURALINC | 4.40 | 100-56700-000-135 | Employee Insurance |
| 09/11/2024 | 20979 | CURALINC LLC - ACH | CURALINC | 24.94 | 100-55200-000-135 | Employee Insurance |
| 09/11/2024 | 20979 | CURALINC LLC - ACH | CURALINC | 7.50 | 100-52100-000-135 | Employee Insurance |
| 09/11/2024 | 20979 | CURALINC LLC - ACH | CURALINC | 178.65 | 100-52200-000-135 | Employee Insurance |
| 09/11/2024 | 20979 | CURALINC LLC - ACH | CURALINC | 5.38 | 100-54600-000-135 | Employee Insurance |
| 09/11/2024 | 20979 | CURALINC LLC - ACH | CURALINC | 8.95 | 100-55202-000-135 | Employee Insurance |
| 09/11/2024 | 20979 | CURALINC LLC - ACH | CURALINC | 8.80 | 100-55350-000-135 | Employee Insurance |
| 09/11/2024 | 20979 | CURALINC LLC - ACH | CURALINC | 10.18 | 100-55300-000-135 | Employee Insurance |
| 09/11/2024 | 20980 | DAN PLAUTZ CLEANING SERVICE - ACH | CLEANING SERVICE - THE GROVE - 6/1-8/31/202 | 1,924.00 | 100-55200-000-242 | Maint--Bldg & Facilities |
| 09/11/2024 | 20981 | E.H. WOLF & SONS INC-SLINGER | NO LEAD GASOLINE | 609.61 | 100-16110 | Inventory |
| 09/11/2024 | 20981 | E.H. WOLF & SONS INC-SLINGER | DIESEL FUEL | 984.38 | 100-16120 | Diesel Inventory |
| 09/11/2024 | 20982 | GOODYEAR, KITTY ACH | REFUND MAD SCIENCE CLASS CANCELLED | 304.00 | 100-000-46710 | Registration Fees |
| 09/17/2024 | 20982 | GOODYEAR, KITTY ACH | REFUND MAD SCIENCE CLASS CANCELLED | 304.00 | 100-000-46710 | Registration Fees |
| 09/11/2024 | 20983 | HAWKINS INC - ACH | AQUA HAWK - WWTP | 18,004.40 | 620-53610-300-411 | Phosphorus Removal Chemical |
| 09/11/2024 | 20984 | HELLER SAFETY SOLUTIONS LLC | SAFE SITTER ESSENTIALS | 368.00 | 100-55350-000-140 | Program Instructors |
| 09/11/2024 | 20985 | KAHLER SLATER INC.-ACH | VP BLDG DESIGN-PROF SERV 7/28-8/31/2024 | 4,718.75 | 100-57620-000-820 | Improvements |
| 09/11/2024 | 20986 | LANNON STONE PRODUCTS - ACH | 3/4" BASE COURSE - VISTA PARK | 2,500.06 | 100-57620-000-820 | Improvements |
| 09/11/2024 | 20987 | NORTH SHORE BANK FSB - ACH | DEFERRED COMPENSATION | 61.92 | 100-14500 | Due from Haass Library |
| 09/11/2024 | 20987 | NORTH SHORE BANK FSB - ACH | DEFERRED COMPENSATION | 1,823.23 | 100-21520 | North Shore Withheld |
| 09/11/2024 | 20988 | PROFESSIONAL FIRE FIGHTERS | UNION DUES - SEPT 2024 | 901.19 | 100-21550 | Union Dues Withheld |
| 09/11/2024 | 20989 | RIVER RUN COMPUTERS INC - ACH | IT SOFTWARE-CLOUD SERVICES - SEPT 2024 | 1,821.34 | 100-51430-000-397 | Licensing Costs |
| 09/11/2024 | 20989 | RIVER RUN COMPUTERS INC - ACH | IT SOFTWARE-CLOUD SERVICES - SEPT 2024 | 528.48 | 610-53700-000-923 | Outside Services Employed |
| 09/11/2024 | 20989 | RIVER RUN COMPUTERS INC - ACH | IT SOFTWARE-CLOUD SERVICES - SEPT 2024 | 507.58 | 620-53610-100-212 | Outside Services |
| 09/11/2024 | 20989 | RIVER RUN COMPUTERS INC - ACH | IT SOFTWARE-CLOUD SERVICES - SEPT 2024 | 128.39 | 640-53650-000-340 | Data Processing Services |
| 09/19/2024 | 20990 | E.H. WOLF & SONS INC-SLINGER | DIESEL GASOLINE - MOWERS | 400.84 | 100-55200-000-239 | Gasoline & Diesel |
| 09/19/2024 | 20990 | E.H. WOLF & SONS INC-SLINGER | NO LEAD GASOLINE | 264.32 | 100-16110 | Inventory |
| 09/19/2024 | 20990 | E.H. WOLF & SONS INC-SLINGER | DIESEL GASOLINE | 572.02 | 100-16120 | Diesel Inventory |
| 09/19/2024 | 20990 | E.H. WOLF & SONS INC-SLINGER | NO LEAD GASOLINE | 595.51 | 100-16110 | Inventory |
| 09/19/2024 | 20991 | HELLER SAFETY SOLUTIONS LLC | SAFE SITTER ESSENTIALS W/CPR | 230.00 | 100-55350-000-140 | Program Instructors |
| 09/19/2024 | 20992 | INFOSEND INC - ACH | UB PROCESSING - JULY 2024 | 666.74 | 610-53700-000-903 | Accounting Supplies & Expenses |
| 09/19/2024 | 20992 | INFOSEND INC - ACH | UB PROCESSING - JULY 2024 | 666.55 | 620-53610-100-215 | Accountant |
| 09/19/2024 | 20992 | INFOSEND INC - ACH | UB PROCESSING - JULY 2024 | 666.55 | 640-53650-000-310 | Office Supplies |
| 09/19/2024 | 20993 | SCENIC VIEW MAINTENANCE - ACH | LANDSCAPING BED MAINTENANCE INCLUDING | 2,535.00 | 100-55200-000-395 | Weed Control |
| 09/19/2024 | 20994 | WIPFLI LLP - ACH | FINAL AUDIT BILLING 2023 | 1,841.40 | 100-51510-000-215 | Accountant |
| 09/19/2024 | 20994 | WIPFLI LLP - ACH | FINAL AUDIT BILLING 2023 | 1,102.15 | 620-53610-100-212 | Outside Services |
| 09/19/2024 | 20994 | WIPFLI LLP - ACH | FINAL AUDIT BILLING 2023 | 1,102.15 | 610-53700-000-923 | Outside Services Employed |
| 09/19/2024 | 20994 | WIPFLI LLP - ACH | FINAL AUDIT BILLING 2023 | 954.30 | 640-53650-000-215 | Accountant |
| 09/26/2024 | 20995 | BOUND TREE MEDICAL LLC | MEDICAL SUPPLIES | 251.69 | 100-52200-000-342 | Medical Supplies |

| Check Issue Date | Check Number | Merchant Name | Description | Amount | Invoice GL Account | Invoice GL Account Title |
|------------------|--------------|-----------------------------------|--|-----------|--------------------|------------------------------|
| 09/26/2024 | 20996 | E.H. WOLF & SONS INC-SLINGER | NO LEAD GASOLINE | 387.26 | 100-16110 | Inventory |
| 09/26/2024 | 20996 | E.H. WOLF & SONS INC-SLINGER | DIESEL GASOLINE | 441.82 | 100-16120 | Diesel Inventory |
| 09/26/2024 | 20997 | FAMILY STRONG INC. - ACH | SKILLZ MARTIAL ARTS 9/3-17/2024 | 783.75 | 100-55350-000-140 | Program Instructors |
| 09/26/2024 | 20998 | HAWKINS INC - ACH | AZONE, MANGANESE SULFATE | 6,725.29 | 610-53700-000-631 | Treatment-Chemicals |
| 09/26/2024 | 20999 | MERKEL, JACOB - ACH | REIMBURSEMENT - SAFETY TRAINING - MERKE | 180.08 | 610-53700-000-930 | Misc General Expenses |
| 09/26/2024 | 21000 | GRGIC, MARKO - ACH | PICKLEBALL INSTRUCTION 09/09-23/2024 | 420.00 | 100-55350-000-140 | Program Instructors |
| 09/26/2024 | 21001 | NASSCO INC. - ACH | WIPES, TOWELS, PLATES | 49.62 | 100-53311-000-345 | Supplies |
| 09/26/2024 | 21001 | NASSCO INC. - ACH | WIPES, TOWELS, PLATES | 223.32 | 610-53700-000-953 | Pumping-Supplies & Expenses |
| 09/26/2024 | 21001 | NASSCO INC. - ACH | WIPES, TOWELS, PLATES | 223.32 | 620-53610-100-249 | Maint--General Plant |
| 09/26/2024 | 21001 | NASSCO INC. - ACH | LOTION SOAP | 6.13 | 100-53311-000-345 | Supplies |
| 09/26/2024 | 21001 | NASSCO INC. - ACH | LOTION SOAP | 27.56 | 610-53700-000-953 | Pumping-Supplies & Expenses |
| 09/26/2024 | 21001 | NASSCO INC. - ACH | LOTION SOAP | 27.56 | 620-53610-100-249 | Maint--General Plant |
| 09/26/2024 | 21002 | NORTH SHORE BANK FSB - ACH | DEFERRED COMPENSATION | 1,823.23 | 100-21520 | North Shore Withheld |
| 09/26/2024 | 21002 | NORTH SHORE BANK FSB - ACH | DEFERRED COMPENSATION | 61.92 | 100-14500 | Due from Haass Library |
| 09/26/2024 | 21003 | RIVER RUN COMPUTERS INC - ACH | HPE POINTNEXT TECH CARE BASIC SERVICE | 979.48 | 100-51430-000-397 | Licensing Costs |
| 09/26/2024 | 21003 | RIVER RUN COMPUTERS INC - ACH | HPE POINTNEXT TECH CARE BASIC SERVICE | 284.21 | 610-53700-000-923 | Outside Services Employed |
| 09/26/2024 | 21003 | RIVER RUN COMPUTERS INC - ACH | HPE POINTNEXT TECH CARE BASIC SERVICE | 272.97 | 620-53610-100-212 | Outside Services |
| 09/26/2024 | 21003 | RIVER RUN COMPUTERS INC - ACH | HPE POINTNEXT TECH CARE BASIC SERVICE | 69.04 | 640-53650-000-340 | Data Processing Services |
| 09/26/2024 | 21004 | TREETOP EXPLORER LLC - ACH | PARK/REC REC CLIMB 9/18/2024 | 152.00 | 100-55350-000-140 | Program Instructors |
| 09/05/2024 | 68268 | AUTOMATIC ENTRANCES OF WI | INSTALL STANLEY MAGIC FORCE & ACCESS DO | 6,390.00 | 100-52100-000-242 | Maint--Bldg & Facilities |
| 09/05/2024 | 68269 | BELMAN HOMES | OCC BD REF:W254N5523 CRESCENT HILL DR, S | 100.00 | 100-23230 | Occupancy Deposits |
| 09/05/2024 | 68270 | CITY OF OCONOMOWOC | MIDDLE SCHOOL USTA REGISTRATION | 96.00 | 100-55350-000-390 | Expenses |
| 09/05/2024 | 68271 | FALLS AUTO PARTS & SUPPLIES | WHIPLASH | 29.98 | 100-53311-000-240 | Maint--Equipment |
| 09/05/2024 | 68271 | FALLS AUTO PARTS & SUPPLIES | OIL FILTER | 7.10 | 610-53700-000-933 | Transportation Expenses |
| 09/05/2024 | 68271 | FALLS AUTO PARTS & SUPPLIES | CLOTH, ADJ WRENCH | 94.15 | 610-53700-000-655 | Maint of Other Plant/Equ |
| 09/05/2024 | 68271 | FALLS AUTO PARTS & SUPPLIES | MOTOR TUNE UP | 8.99 | 610-53700-000-651 | Maint of Mains |
| 09/05/2024 | 68272 | GILES ENGINEERING ASSOCIATES | 2025 ROAD & PARKING LOTS | 12,680.00 | 410-57331-000-216 | Engineering |
| 09/05/2024 | 68273 | GUETZKE & ASSOCIATES INC | REPL FIRE ALARM CONTROL PANEL | 4,426.00 | 100-53311-000-242 | Maint--Bldg & Facilities |
| 09/05/2024 | 68273 | GUETZKE & ASSOCIATES INC | WELL 8 ANNUAL MONITORING FIRE ALARM SYS | 435.00 | 610-53700-000-955 | Pumping-Maint of Equipment |
| 09/05/2024 | 68274 | LIESENER SOILS INC. | BASEBALL MIX - 24 YARDS | 792.00 | 100-55200-000-391 | Baseball Diamonds |
| 09/05/2024 | 68275 | KOZLOWSKI, MICHELLE | WATER SOFTENER REPLACEMENT | 200.00 | 620-53610-300-247 | Maint-- Softener Replacement |
| 09/05/2024 | 68276 | PEWAUKEE PARK & RECREATION | 2024 SUMMER PROGRAM - NINJA WARRIOR CA | 306.00 | 100-55350-000-140 | Program Instructors |
| 09/05/2024 | 68277 | PRO BARK | TOP SOIL - COLDWATER | 188.00 | 100-57620-000-820 | Improvements |
| 09/05/2024 | 68277 | PRO BARK | TOP SOIL - COLDWATER | 94.00 | 100-57620-000-820 | Improvements |
| 09/05/2024 | 68278 | KATHLEEN A DOWNEY DBA: | CHAIR YOGA - AUGUST 2024 | 200.00 | 100-55350-000-140 | Program Instructors |
| 09/05/2024 | 68279 | STARK PAVEMENT CORP. | 5/8 TB ASPHALT CRUSHED-DRIVE | 333.17 | 610-53700-000-955 | Pumping-Maint of Equipment |
| 09/05/2024 | 68280 | THE CLAUSON FAMILY MUSIC SHOW LLC | BALANCE DUE - SHOW TICKETS | 2,510.84 | 100-55350-000-404 | Adult Trips |
| 09/05/2024 | 68281 | JOHNSON, THOMAS | WATER SOFTENER REPLACEMENT REBATE | 200.00 | 620-53610-300-247 | Maint-- Softener Replacement |
| 09/05/2024 | 68282 | WI DEPT OF JUSTICE - 93970 | BACKGROUND CHECKS | 70.00 | 100-000-44120 | Operator s Licenses |
| 09/05/2024 | 68282 | WI DEPT OF JUSTICE - 93970 | BACKGROUND CHECKS | 67.00 | 100-55350-000-180 | Human Resources Expense |

| Check Issue Date | Check Number | Merchant Name | Description | Amount | Invoice GL Account | Invoice GL Account Title |
|------------------|--------------|-------------------------------|--|----------|--------------------|----------------------------|
| 09/05/2024 | 68283 | YOUNG REMBRANDTS | ELEMENTARY SUMMER CAMP - BABY ANIMALS | 756.00 | 100-55350-000-140 | Program Instructors |
| 09/05/2024 | 68283 | YOUNG REMBRANDTS | ELEMENTARY ARTRAGEOUS CAMP | 180.00 | 100-55350-000-140 | Program Instructors |
| 09/10/2024 | 68284 | WPRA - NEW | 2024 SUMMER TICKET - JET BOAT ADULT | 322.50 | 100-23451 | WPRA Ticket Sales |
| 09/10/2024 | 68284 | WPRA - NEW | 2024 SUMMER TICKET - JET BOAT CHILD | 71.00 | 100-23451 | WPRA Ticket Sales |
| 09/10/2024 | 68284 | WPRA - NEW | 2024 SUMMER TICKET - MKE ZOO - ADULT | 233.75 | 100-23451 | WPRA Ticket Sales |
| 09/10/2024 | 68284 | WPRA - NEW | 2024 SUMMER TICKET - MKE ZOO - CHILD | 64.50 | 100-23451 | WPRA Ticket Sales |
| 09/10/2024 | 68284 | WPRA - NEW | 2024 SUMMER TICKET - MT OLYMPUS | 1,296.75 | 100-23451 | WPRA Ticket Sales |
| 09/10/2024 | 68284 | WPRA - NEW | 2024 SUMMER TICKET - NOAH'S ARK | 5,754.00 | 100-23451 | WPRA Ticket Sales |
| 09/10/2024 | 68284 | WPRA - NEW | 2024 SUMMER TICKET - PIRATE'S COVE | 159.50 | 100-23451 | WPRA Ticket Sales |
| 09/10/2024 | 68284 | WPRA - NEW | 2024 SUMMER TICKET - UPPER DELLS ADULT | 64.50 | 100-23451 | WPRA Ticket Sales |
| 09/10/2024 | 68284 | WPRA - NEW | 2024 SUMMER TICKET - WI DUCKS ADULT | 96.75 | 100-23451 | WPRA Ticket Sales |
| 09/10/2024 | 68284 | WPRA - NEW | 2024 SUMMER TICKET - WI DUCKS CHILD | 17.75 | 100-23451 | WPRA Ticket Sales |
| 09/11/2024 | 68286 | DELUXE CORP DBA: PTM DOCUMENT | W2 - 2024 | 5.68 | 100-51410-000-310 | Office Supplies |
| 09/11/2024 | 68286 | DELUXE CORP DBA: PTM DOCUMENT | W2 - 2024 | 32.45 | 100-51420-000-310 | Office Supplies |
| 09/11/2024 | 68286 | DELUXE CORP DBA: PTM DOCUMENT | W2 - 2024 | 12.17 | 100-51491-000-310 | Office Supplies |
| 09/11/2024 | 68286 | DELUXE CORP DBA: PTM DOCUMENT | W2 - 2024 | 5.68 | 100-51510-000-310 | Office Supplies |
| 09/11/2024 | 68286 | DELUXE CORP DBA: PTM DOCUMENT | W2 - 2024 | 3.25 | 100-52200-000-345 | Supplies |
| 09/11/2024 | 68286 | DELUXE CORP DBA: PTM DOCUMENT | W2 - 2024 | 12.17 | 100-52400-000-390 | Expenses |
| 09/11/2024 | 68286 | DELUXE CORP DBA: PTM DOCUMENT | W2 - 2024 | 5.68 | 100-53311-000-345 | Supplies |
| 09/11/2024 | 68286 | DELUXE CORP DBA: PTM DOCUMENT | W2 - 2024 | 4.06 | 100-55200-000-310 | Office Supplies |
| 09/11/2024 | 68286 | DELUXE CORP DBA: PTM DOCUMENT | W2 - 2024 | 32.44 | 100-55300-000-310 | Office Supplies |
| 09/11/2024 | 68286 | DELUXE CORP DBA: PTM DOCUMENT | W2 - 2024 | 21.10 | 610-53700-000-921 | Office Supplies & Expenses |
| 09/11/2024 | 68286 | DELUXE CORP DBA: PTM DOCUMENT | W2 - 2024 | 21.10 | 620-53610-100-310 | Office Supplies |
| 09/11/2024 | 68286 | DELUXE CORP DBA: PTM DOCUMENT | W2 - 2024 | 6.49 | 640-53650-000-310 | Office Supplies |
| 09/11/2024 | 68286 | DELUXE CORP DBA: PTM DOCUMENT | W2 - 2024 | 26.42 | 100-14500 | Due from Haass Library |
| 09/11/2024 | 68287 | GS SYSTEMS, INC | FIRST SUPPORT RENEWAL - SCADA | 4,220.00 | 620-53610-100-212 | Outside Services |
| 09/11/2024 | 68287 | GS SYSTEMS, INC | FIRST SUPPORT RENEWAL - SCADA | 4,220.00 | 610-53700-000-923 | Outside Services Employed |
| 09/11/2024 | 68288 | GUETZKE & ASSOCIATES INC | ANNUAL MONITORING OF FIRE ALARM SYSTEM | 365.00 | 100-51600-000-242 | Maint--Bldg & Facilities |
| 09/11/2024 | 68288 | GUETZKE & ASSOCIATES INC | REMOVE FIRE ALARM SYS FROM PHONE LINES | 875.00 | 100-57140-000-820 | Improvements |
| 09/11/2024 | 68289 | HAMILTON HIGH SCHOOL ALUMNI | REFUND - DEPOSIT HAMILTON HS ALUM PICNIC | 120.00 | 100-26110 | Unearned Revenue |
| 09/11/2024 | 68290 | HARBOR HOMES | OCC BD REF:W228N7703 WOODLAND CT, SUSS | 100.00 | 100-23230 | Occupancy Deposits |
| 09/11/2024 | 68291 | J.F. AHERN CO. | FIRE EQUIPMENT INSP - WWTP | 136.10 | 620-53610-100-249 | Maint--General Plant |
| 09/11/2024 | 68291 | J.F. AHERN CO. | RECHARGE - FIRE EXTINGUISHERS | 156.14 | 100-52200-000-242 | Maint--Bldg & Facilities |
| 09/11/2024 | 68292 | MISSION SQUARE | DEFERRED COMPENSATION #302052 PHPL | 308.41 | 100-14500 | Due from Haass Library |
| 09/11/2024 | 68292 | MISSION SQUARE | DEFERRED COMPENSATION #302052 VILLAGE | 2,511.50 | 100-21521 | ICMA Withheld |
| 09/11/2024 | 68293 | MUNICIPAL LAW & LITIGATION | ATTORNEY FEES | 2,761.00 | 100-51300-000-211 | Legal Fees--Opinions |
| 09/11/2024 | 68293 | MUNICIPAL LAW & LITIGATION | ATTORNEY FEES | 2,970.00 | 100-51300-000-210 | Legal Fees--Traffic |
| 09/11/2024 | 68294 | PAUL'S CERTIFIED AUTO REPAIR | TIRE SERVICE | 17.00 | 100-53311-000-244 | Maint--Vehicle |
| 09/11/2024 | 68295 | PIGGLY WIGGLY - NEW | DAY CAMP SUPPLIES | 8.04 | 100-55350-100-390 | DAY CAMP Expenses |
| 09/11/2024 | 68295 | PIGGLY WIGGLY - NEW | ICE - 100 YEAR CELEBRATION | 119.70 | 100-55202-000-403 | Special Events |

| Check Issue Date | Check Number | Merchant Name | Description | Amount | Invoice GL Account | Invoice GL Account Title |
|------------------|--------------|--------------------------------|--|-----------|--------------------|-------------------------------|
| 09/11/2024 | 68295 | PIGGLY WIGGLY - NEW | ICE REFUND - 100 YEAR CELEBRATION | 52.40 | 100-55202-000-403 | Special Events |
| 09/11/2024 | 68295 | PIGGLY WIGGLY - NEW | DAY CAMP SUPPLIES | 30.43 | 100-55350-100-390 | DAY CAMP Expenses |
| 09/11/2024 | 68295 | PIGGLY WIGGLY - NEW | DAY CAMP SUPPLIES | 8.99 | 100-55350-100-390 | DAY CAMP Expenses |
| 09/11/2024 | 68295 | PIGGLY WIGGLY - NEW | ICE - 100 YEAR CELEBRATION | 39.92 | 100-55202-000-403 | Special Events |
| 09/11/2024 | 68295 | PIGGLY WIGGLY - NEW | ICE BEER TENT - 100 YEAR CELEBRATION | 69.86 | 100-55202-000-403 | Special Events |
| 09/11/2024 | 68295 | PIGGLY WIGGLY - NEW | ICE BEER TENT - 100 YEAR CELEBRATION | 59.88 | 100-55202-000-403 | Special Events |
| 09/11/2024 | 68295 | PIGGLY WIGGLY - NEW | ICE BEER TENT - 100 YEAR CELEBRATION | 59.88 | 100-55202-000-403 | Special Events |
| 09/11/2024 | 68295 | PIGGLY WIGGLY - NEW | ELECTION SUPPLIES | 78.53 | 100-51440-000-390 | Expenses |
| 09/11/2024 | 68295 | PIGGLY WIGGLY - NEW | DAY CAMP SUPPLIES | 7.04 | 100-55350-100-390 | DAY CAMP Expenses |
| 09/11/2024 | 68295 | PIGGLY WIGGLY - NEW | DAY CAMP SUPPLIES | 80.16 | 100-55350-100-390 | DAY CAMP Expenses |
| 09/11/2024 | 68295 | PIGGLY WIGGLY - NEW | ICE, CUPS - TESTING SUPPLIES | 6.78 | 610-53700-000-632 | Treatment-Supplies & Expenses |
| 09/11/2024 | 68296 | RITTER TECHNOLOGY LLC | CRIMP HOSE ASSEMBLIES | 285.69 | 640-53650-000-244 | Maint--Vehicle |
| 09/11/2024 | 68297 | SCHINDLER ELEVATOR CORPORATION | 2024 UPDATED CONTRACT CIVIC CENTER | 5,400.00 | 100-51600-000-242 | Maint--Bldg & Facilities |
| 09/11/2024 | 68298 | SUSSEX ANTIQUE POWER ASSOC | REFUND - DEPOSIT | 150.00 | 100-23410 | Rent Deposits |
| 09/11/2024 | 68299 | TRAWICKI ELECTRIC INC. | ELECTRICAL WORK - DOOR OPERATORS - POLI | 1,470.00 | 100-52200-000-242 | Maint--Bldg & Facilities |
| 09/11/2024 | 68300 | UNEMPLOYMENT INSURANCE | UNEMPLOYMENT COUPON 13409164 | 48.63 | 100-55350-000-155 | Unemployment Compensation |
| 09/11/2024 | 68301 | VILLAGE OF RICHFIELD | SEPT 2024 BUILDING INSPECTION CONTRACT | 10,128.51 | 100-52400-000-290 | Contractual Fees |
| 09/11/2024 | 68302 | WAUKESHA CTY TREAS-RM148 | 2024 2ND QTR POLICE SERVICES - OT | 8,362.11 | 100-52100-000-290 | Contractual Fees |
| 09/17/2024 | 68303 | GOODYEAR, KITTY ACH | REFUND MAD SCIENCE CLASS CANCELLED | 304.00 | 100-000-46710 | Registration Fees |
| 09/19/2024 | 68304 | ASPEN HOMES INC. | OCC BD REF:W254N6692 ASPEN LN, SUSSEX | 100.00 | 100-23230 | Occupancy Deposits |
| 09/19/2024 | 68305 | CIVIC SYSTEMS LLC | NEW LICENSE - J SMITH | 153.72 | 100-51430-000-397 | Licensing Costs |
| 09/19/2024 | 68305 | CIVIC SYSTEMS LLC | NEW LICENSE - J SMITH | 44.60 | 610-53700-000-923 | Outside Services Employed |
| 09/19/2024 | 68305 | CIVIC SYSTEMS LLC | NEW LICENSE - J SMITH | 42.84 | 620-53610-100-212 | Outside Services |
| 09/19/2024 | 68305 | CIVIC SYSTEMS LLC | NEW LICENSE - J SMITH | 10.84 | 640-53650-000-340 | Data Processing Services |
| 09/19/2024 | 68306 | CONVERGENT SOLUTIONS | FAX PROBLEM PSB | 34.75 | 100-52100-000-220 | Utilities--Telephone |
| 09/19/2024 | 68306 | CONVERGENT SOLUTIONS | FAX PROBLEM PSB | 34.75 | 100-52200-000-220 | Utilities--Telephone |
| 09/19/2024 | 68307 | DOUSMAN TRANSPORT CO. INC. | DAY CAMP BUSSING - SHALOM & LITTLE AMERI | 1,935.80 | 100-55350-100-390 | DAY CAMP Expenses |
| 09/19/2024 | 68308 | FAITH EV LUTHERAN CHURCH | REFUND - DEPOSIT | 150.00 | 100-23410 | Rent Deposits |
| 09/19/2024 | 68309 | FERGUSON WATERWORKS #1476 | CURB BOX LID W/PLUG | 212.10 | 610-53700-000-652 | Maint of Services (Lat) |
| 09/19/2024 | 68310 | GUETZKE & ASSOCIATES INC | CLEANED DETECTOR HEADS & REWIRED | 270.00 | 100-55200-000-242 | Maint--Bldg & Facilities |
| 09/19/2024 | 68311 | HARBOR HOMES | OCC BD REF:W254N6692 ASPEN LN, SUSSEX | 100.00 | 100-23230 | Occupancy Deposits |
| 09/19/2024 | 68311 | HARBOR HOMES | L/S BD REF:W226N7865 TIMBERLAND DR, SUSS | 400.00 | 100-23240 | Landscaping/Erosion Deposits |
| 09/19/2024 | 68311 | HARBOR HOMES | ST BD REF:W226N7865 TIMBERLAND DR, SUSS | 2,000.00 | 100-23220 | Road Cleaning Deposits |
| 09/19/2024 | 68311 | HARBOR HOMES | L/S BD REF:W226N7857 TIMBERLAND DR, SUSS | 400.00 | 100-23240 | Landscaping/Erosion Deposits |
| 09/19/2024 | 68311 | HARBOR HOMES | ST BD REF:W226N7857 TIMBERLAND DR, SUSS | 2,000.00 | 100-23220 | Road Cleaning Deposits |
| 09/19/2024 | 68311 | HARBOR HOMES | L/S BD REF:W226N7833 TIMBERLAND DR, SUSS | 400.00 | 100-23240 | Landscaping/Erosion Deposits |
| 09/19/2024 | 68311 | HARBOR HOMES | ST BD REF:W226N7833 TIMBERLAND DR, SUSS | 2,000.00 | 100-23220 | Road Cleaning Deposits |
| 09/19/2024 | 68311 | HARBOR HOMES | L/S BD REF:W226N7888 TIMBERLAND DR, SUSS | 400.00 | 100-23240 | Landscaping/Erosion Deposits |
| 09/19/2024 | 68311 | HARBOR HOMES | ST BD REF:W226N7888 TIMBERLAND DR, SUSS | 2,000.00 | 100-23220 | Road Cleaning Deposits |
| 09/19/2024 | 68311 | HARBOR HOMES | L/S BD REF:W226N7834 TIMBERLAND DR, SUSS | 400.00 | 100-23240 | Landscaping/Erosion Deposits |

| Check Issue Date | Check Number | Merchant Name | Description | Amount | Invoice GL Account | Invoice GL Account Title |
|------------------|--------------|-------------------------------|--|----------|--------------------|------------------------------|
| 09/19/2024 | 68311 | HARBOR HOMES | ST BD REF:W226N7834 TIMBERLAND DR, SUSS | 2,000.00 | 100-23220 | Road Cleaning Deposits |
| 09/19/2024 | 68311 | HARBOR HOMES | L/S BD REF:W227N7862 TIMBERLAND DR, SUSS | 400.00 | 100-23240 | Landscaping/Erosion Deposits |
| 09/19/2024 | 68311 | HARBOR HOMES | ST BD REF:W227N7862 TIMBERLAND DR, SUSS | 2,000.00 | 100-23220 | Road Cleaning Deposits |
| 09/19/2024 | 68311 | HARBOR HOMES | L/S BD REF:W227N7984 TAMARACK CT, SUSSEX | 400.00 | 100-23240 | Landscaping/Erosion Deposits |
| 09/19/2024 | 68311 | HARBOR HOMES | ST BD REF:W227N7984 TAMARACK CT, SUSSEX | 2,000.00 | 100-23220 | Road Cleaning Deposits |
| 09/19/2024 | 68311 | HARBOR HOMES | L/S BD REF:W228N7859 TIMBERLAND DR, SUSS | 400.00 | 100-23240 | Landscaping/Erosion Deposits |
| 09/19/2024 | 68311 | HARBOR HOMES | ST BD REF:W228N7859 TIMBERLAND DR, SUSS | 2,000.00 | 100-23220 | Road Cleaning Deposits |
| 09/19/2024 | 68311 | HARBOR HOMES | L/S BD REF:W227N7652 WOODLAND CT, SUSSE | 400.00 | 100-23240 | Landscaping/Erosion Deposits |
| 09/19/2024 | 68311 | HARBOR HOMES | ST BD REF:W227N7652 WOODLAND CT, SUSSE | 2,000.00 | 100-23220 | Road Cleaning Deposits |
| 09/19/2024 | 68311 | HARBOR HOMES | L/S BD REF:N67W25394 ASPEN LN, SUSSEX | 400.00 | 100-23240 | Landscaping/Erosion Deposits |
| 09/19/2024 | 68311 | HARBOR HOMES | ST BD REF:N67W25394 ASPEN LN, SUSSEX | 2,000.00 | 100-23220 | Road Cleaning Deposits |
| 09/19/2024 | 68311 | HARBOR HOMES | L/S BD REF:N67W25352 ASPEN LN, SUSSEX | 400.00 | 100-23240 | Landscaping/Erosion Deposits |
| 09/19/2024 | 68311 | HARBOR HOMES | ST BD REF:N67W25352 ASPEN LN, SUSSEX | 2,000.00 | 100-23220 | Road Cleaning Deposits |
| 09/19/2024 | 68312 | HOME PATH FINANCIAL | OCC BD REF:W237N6991 RED OAK KNOLL, SUS | 100.00 | 100-23230 | Occupancy Deposits |
| 09/19/2024 | 68312 | HOME PATH FINANCIAL | L/S BD REF:N69W23510 DONNA DR, SUSSEX | 400.00 | 100-23240 | Landscaping/Erosion Deposits |
| 09/19/2024 | 68312 | HOME PATH FINANCIAL | ST BD REF:N69W23510 DONNA DR, SUSSEX | 2,000.00 | 100-23220 | Road Cleaning Deposits |
| 09/19/2024 | 68313 | J. K. LEE BLACK BELT ACADEMY | MARTIAL ARTS SUMMER CLASSES | 875.00 | 100-55350-000-140 | Program Instructors |
| 09/19/2024 | 68314 | JX ENTERPRISES INC - ACH | CLAMP | 285.70 | 100-53311-000-244 | Maint--Vehicle |
| 09/19/2024 | 68315 | KILLER B'S TOTAL PEST CONTROL | QUARTERLY PEST CONTROL - POLICE | 75.00 | 100-52100-000-242 | Maint--Bldg & Facilities |
| 09/19/2024 | 68315 | KILLER B'S TOTAL PEST CONTROL | MONTHLY PEST CONTROL - POLICE | 150.00 | 100-52100-000-242 | Maint--Bldg & Facilities |
| 09/19/2024 | 68316 | KORNDORFER HOMES | OCC BD REF:W247N7575 OVERLAND RD, SUSS | 100.00 | 100-23230 | Occupancy Deposits |
| 09/19/2024 | 68317 | L F GEORGE INC | KEY, IGNITION | 10.20 | 100-53311-000-240 | Maint--Equipment |
| 09/19/2024 | 68318 | MOODYS INVESTORS SERVICE | WI WATER ENT ANNUAL FEE | 500.00 | 610-53700-000-923 | Outside Services Employed |
| 09/19/2024 | 68319 | PITNEY BOWES BANK INC | POSTAGE | 105.00 | 100-51410-000-310 | Office Supplies |
| 09/19/2024 | 68319 | PITNEY BOWES BANK INC | POSTAGE | 600.00 | 100-51420-000-310 | Office Supplies |
| 09/19/2024 | 68319 | PITNEY BOWES BANK INC | POSTAGE | 225.00 | 100-51491-000-310 | Office Supplies |
| 09/19/2024 | 68319 | PITNEY BOWES BANK INC | POSTAGE | 105.00 | 100-51510-000-310 | Office Supplies |
| 09/19/2024 | 68319 | PITNEY BOWES BANK INC | POSTAGE | 60.00 | 100-52200-000-345 | Supplies |
| 09/19/2024 | 68319 | PITNEY BOWES BANK INC | POSTAGE | 225.00 | 100-52400-000-390 | Expenses |
| 09/19/2024 | 68319 | PITNEY BOWES BANK INC | POSTAGE | 105.00 | 100-53311-000-345 | Supplies |
| 09/19/2024 | 68319 | PITNEY BOWES BANK INC | POSTAGE | 75.00 | 100-55200-000-310 | Office Supplies |
| 09/19/2024 | 68319 | PITNEY BOWES BANK INC | POSTAGE | 600.00 | 100-55300-000-310 | Office Supplies |
| 09/19/2024 | 68319 | PITNEY BOWES BANK INC | POSTAGE | 390.00 | 610-53700-000-921 | Office Supplies & Expenses |
| 09/19/2024 | 68319 | PITNEY BOWES BANK INC | POSTAGE | 390.00 | 620-53610-100-310 | Office Supplies |
| 09/19/2024 | 68319 | PITNEY BOWES BANK INC | POSTAGE | 120.00 | 640-53650-000-310 | Office Supplies |
| 09/19/2024 | 68320 | STARK PAVEMENT CORP. | 3/8" SURFACE - WATER MAIN BREAK | 137.02 | 610-53700-000-651 | Maint of Mains |
| 09/19/2024 | 68320 | STARK PAVEMENT CORP. | 3/8" SURFACE - TOUCH A TRUCK EVENT | 128.54 | 100-55202-000-403 | Special Events |
| 09/19/2024 | 68321 | STATE FARM | SURETY BOND - K ANGELROTH | 25.00 | 100-51420-000-390 | Expenses |
| 09/19/2024 | 68321 | STATE FARM | SURETY BOND - K ANGELROTH | 12.50 | 610-53700-000-930 | Misc General Expenses |
| 09/19/2024 | 68321 | STATE FARM | SURETY BOND - K ANGELROTH | 12.50 | 620-53610-100-345 | Supplies |

| Check Issue Date | Check Number | Merchant Name | Description | Amount | Invoice GL Account | Invoice GL Account Title |
|------------------|--------------|--------------------------|--|------------|--------------------|------------------------------|
| 09/19/2024 | 68322 | STRAND ASSOCIATES INC | FIREWALL SECURITY SERVICE CONFIGERATIO | 61.90 | 610-53700-000-923 | Outside Services Employed |
| 09/19/2024 | 68322 | STRAND ASSOCIATES INC | FIREWALL SECURITY SERVICE CONFIGERATIO | 61.90 | 620-53610-100-212 | Outside Services |
| 09/19/2024 | 68323 | THE DISC GOLF EXPERIENCE | REFUND - DEPOSIT VP DISC GOLF COURSE 6/2 | 150.00 | 100-23410 | Rent Deposits |
| 09/19/2024 | 68324 | TIM O'BRIEN HOMES | OCC BD REF:W240N5628 DAISY CT, SUSSEX | 100.00 | 100-23230 | Occupancy Deposits |
| 09/19/2024 | 68324 | TIM O'BRIEN HOMES | OCC BD REF:N55W24210 PEPPERTREE DR S, S | 100.00 | 100-23230 | Occupancy Deposits |
| 09/19/2024 | 68324 | TIM O'BRIEN HOMES | L/S BD REF:W254N6532 ASPEN CT, SUSSEX | 400.00 | 100-23240 | Landscaping/Erosion Deposits |
| 09/19/2024 | 68324 | TIM O'BRIEN HOMES | ST BD REF:W254N6532 ASPEN CT, SUSSEX | 2,000.00 | 100-23220 | Road Cleaning Deposits |
| 09/19/2024 | 68324 | TIM O'BRIEN HOMES | L/S BD REF:N65W25603 BEAVER CREEK LN, SU | 400.00 | 100-23240 | Landscaping/Erosion Deposits |
| 09/19/2024 | 68324 | TIM O'BRIEN HOMES | ST BD REF:N65W25603 BEAVER CREEK LN, SUS | 2,000.00 | 100-23220 | Road Cleaning Deposits |
| 09/19/2024 | 68325 | TRAWICKI ELECTRIC INC. | LIGHT POLE ELECTRICAL TROUBLESHOOT-GR | 146.00 | 100-55200-000-396 | Playgrounds |
| 09/19/2024 | 68326 | VERIZON WIRELESS | HOT SPOT - PK GARAGE | 40.05 | 100-55200-000-220 | Utilities--Telephone |
| 09/19/2024 | 68326 | VERIZON WIRELESS | HOT SPOT - ARMORY PK | 40.01 | 100-55200-000-220 | Utilities--Telephone |
| 09/19/2024 | 68326 | VERIZON WIRELESS | HOT SPOT - MADELINE PK | 40.01 | 100-55200-000-220 | Utilities--Telephone |
| 09/19/2024 | 68327 | WAUKESHA CTY TREAS-RM148 | OCT 2024 POLICE SERVICES | 176,399.85 | 100-52100-000-290 | Contractual Fees |
| 09/19/2024 | 68328 | WISCONSIN DNR #93192 | ENVIRONMENTAL FEES - STORMWATER | 1,500.00 | 640-53650-000-397 | Licensing Costs |
| 09/19/2024 | 68329 | WRWA | CONSOLIDATED SAFETY TRAINING -WTR | 82.10 | 610-53700-000-930 | Misc General Expenses |
| 09/26/2024 | 68330 | GRAVES, ADAM | WATER SOFTENER REPLACEMENT REBATE | 200.00 | 620-53610-300-247 | Maint-- Softener Replacement |
| 09/26/2024 | 68331 | AL MOROS LAWN CUTTING | LAWN CUTTING - AUG 2024 | 720.00 | 280-54910-000-290 | Contractual Fees |
| 09/26/2024 | 68332 | WILLHITE, ALAN | REFUND - DEPOSIT | 150.00 | 100-26110 | Unearned Revenue |
| 09/26/2024 | 68333 | GALLO, CHERYL | WATER SOFTENER REPL REBATE | 200.00 | 620-53610-300-247 | Maint-- Softener Replacement |
| 09/26/2024 | 68334 | CRAIG D CHILDS PHD S.C. | PSYCH EVALUATOIN - BRENNAN | 500.00 | 100-52200-000-390 | Expenses |
| 09/26/2024 | 68335 | HARBOR HOMES | L/S BD REF:N66W25590 ALPINE DR, SUSSEX | 400.00 | 100-23240 | Landscaping/Erosion Deposits |
| 09/26/2024 | 68335 | HARBOR HOMES | ST BD REF:N66W25590 ALPINE DR, SUSSEX | 2,000.00 | 100-23220 | Road Cleaning Deposits |
| 09/26/2024 | 68335 | HARBOR HOMES | L/S BD REF:W255N6665 ASPEN LN, SUSSEX | 400.00 | 100-23240 | Landscaping/Erosion Deposits |
| 09/26/2024 | 68335 | HARBOR HOMES | ST BD REF:W255N6665 ASPEN LN, SUSSEX | 2,000.00 | 100-23220 | Road Cleaning Deposits |
| 09/26/2024 | 68335 | HARBOR HOMES | L/S BD REF:W255N6667 ASPEN LN, SUSSEX | 400.00 | 100-23240 | Landscaping/Erosion Deposits |
| 09/26/2024 | 68335 | HARBOR HOMES | ST BD REF:W255N6667 ASPEN LN, SUSSEX | 2,000.00 | 100-23220 | Road Cleaning Deposits |
| 09/26/2024 | 68335 | HARBOR HOMES | L/S BD REF:W255N6753 ASPEN LN, SUSSEX | 400.00 | 100-23240 | Landscaping/Erosion Deposits |
| 09/26/2024 | 68335 | HARBOR HOMES | ST BD REF:W255N6753 ASPEN LN, SUSSEX | 2,000.00 | 100-23220 | Road Cleaning Deposits |
| 09/26/2024 | 68335 | HARBOR HOMES | L/S BD REF:W254N6686 ASPEN LN, SUSSEX | 400.00 | 100-23240 | Landscaping/Erosion Deposits |
| 09/26/2024 | 68335 | HARBOR HOMES | ST BD REF:W254N6686 ASPEN LN, SUSSEX | 2,000.00 | 100-23220 | Road Cleaning Deposits |
| 09/26/2024 | 68335 | HARBOR HOMES | L/S BD REF:W228N7869 TIMBERLAND DR, SUSS | 400.00 | 100-23240 | Landscaping/Erosion Deposits |
| 09/26/2024 | 68335 | HARBOR HOMES | ST BD REF:W228N7869 TIMBERLAND DR, SUSS | 2,000.00 | 100-23220 | Road Cleaning Deposits |
| 09/26/2024 | 68335 | HARBOR HOMES | L/S BD REF:W227N7684 WOODLAND CT, SUSSE | 400.00 | 100-23240 | Landscaping/Erosion Deposits |
| 09/26/2024 | 68335 | HARBOR HOMES | ST BD REF:W227N7684 WOODLAND CT, SUSSE | 2,000.00 | 100-23220 | Road Cleaning Deposits |
| 09/26/2024 | 68335 | HARBOR HOMES | L/S BD REF:W227N7602 WOODLAND CT, SUSSE | 400.00 | 100-23240 | Landscaping/Erosion Deposits |
| 09/26/2024 | 68335 | HARBOR HOMES | ST BD REF:W227N7602 WOODLAND CT, SUSSE | 2,000.00 | 100-23220 | Road Cleaning Deposits |
| 09/26/2024 | 68336 | HELM SERVICE | REPAIR LEAK-CIRCUIT B CONDENSING UNIT | 2,371.10 | 100-14500 | Due from Haass Library |
| 09/26/2024 | 68337 | ZIEGLER, JESSICA | WATER SOFTENER REPLACEMENT REBATE | 200.00 | 620-53610-300-247 | Maint-- Softener Replacement |
| 09/26/2024 | 68338 | KAEREK HOMES INC. | OCC BD REF:N75W24638 OVERLAND RD, SUSS | 100.00 | 100-23230 | Occupancy Deposits |

| Check Issue Date | Check Number | Merchant Name | Description | Amount | Invoice GL Account | Invoice GL Account Title |
|------------------|--------------|-----------------------------------|---|----------|--------------------|------------------------------|
| 09/26/2024 | 68338 | KAEREK HOMES INC. | L/S BD REF:N55W23797 FIELDSTONE PASS CIR, | 400.00 | 100-23240 | Landscaping/Erosion Deposits |
| 09/26/2024 | 68338 | KAEREK HOMES INC. | ST BD REF:N55W23797 FIELDSTONE PASS CIR, | 2,000.00 | 100-23220 | Road Cleaning Deposits |
| 09/26/2024 | 68339 | KILLER B'S TOTAL PEST CONTROL | QUARTERLY PEST CONTROL - CIVIC CENTER | 75.00 | 100-51600-000-242 | Maint--Bldg & Facilities |
| 09/26/2024 | 68339 | KILLER B'S TOTAL PEST CONTROL | MONTHLY PEST CONTROL - CIVIC CENTER | 150.00 | 100-51600-000-242 | Maint--Bldg & Facilities |
| 09/26/2024 | 68340 | KENNEY, MARK | ENTERTAINMENT - PINTS IN THE PARK | 500.00 | 100-55202-000-403 | Special Events |
| 09/26/2024 | 68341 | MISSION SQUARE | DEF COMP #302052 VILLAGE OF SUSSEX | 308.41 | 100-14500 | Due from Haass Library |
| 09/26/2024 | 68341 | MISSION SQUARE | DEF COMP #302052 VILLAGE OF SUSSEX | 2,511.50 | 100-21521 | ICMA Withheld |
| 09/26/2024 | 68342 | NORTH SHORE ANALYTICAL | MERCURY SAMPLES | 250.00 | 620-53610-300-212 | Outside Services |
| 09/26/2024 | 68343 | PFEIFER, JASON D DBA: | OPENER ARM & J - REPAIR LEFT FRONT DOOR | 265.00 | 100-53311-000-242 | Maint--Bldg & Facilities |
| 09/26/2024 | 68343 | PFEIFER, JASON D DBA: | CHAIN & SPRING REPAIRS FRONT LEFT DOOR | 685.00 | 100-53311-000-242 | Maint--Bldg & Facilities |
| 09/26/2024 | 68344 | SERWE IMPLEMENT MUNICIPAL SALES | V-BELTS | 547.16 | 640-53650-000-244 | Maint--Vehicle |
| 09/26/2024 | 68345 | TIM O'BRIEN HOMES | L/S BD REF:W254N6512 ASPEN CT, SUSSEX | 400.00 | 100-23240 | Landscaping/Erosion Deposits |
| 09/26/2024 | 68345 | TIM O'BRIEN HOMES | ST BD REF:W254N6512 ASPEN CT, SUSSEX | 2,000.00 | 100-23220 | Road Cleaning Deposits |
| 09/26/2024 | 68345 | TIM O'BRIEN HOMES | L/S BD REF:W254N6509 ASPEN CT, SUSSEX | 400.00 | 100-23240 | Landscaping/Erosion Deposits |
| 09/26/2024 | 68345 | TIM O'BRIEN HOMES | ST BD REF:W254N6509 ASPEN CT, SUSSEX | 2,000.00 | 100-23220 | Road Cleaning Deposits |
| 09/26/2024 | 68345 | TIM O'BRIEN HOMES | L/S BD REF:N66W25574 BEAVER CREEK LN, SU | 400.00 | 100-23240 | Landscaping/Erosion Deposits |
| 09/26/2024 | 68345 | TIM O'BRIEN HOMES | ST BD REF:N66W25574 BEAVER CREEK LN, SUS | 2,000.00 | 100-23220 | Road Cleaning Deposits |
| 09/26/2024 | 68345 | TIM O'BRIEN HOMES | L/S BD REF:W256N6609 BEAVER CREEK LN, SU | 400.00 | 100-23240 | Landscaping/Erosion Deposits |
| 09/26/2024 | 68345 | TIM O'BRIEN HOMES | ST BD REF:W256N6609 BEAVER CREEK LN, SUS | 2,000.00 | 100-23220 | Road Cleaning Deposits |
| 09/26/2024 | 68345 | TIM O'BRIEN HOMES | OCC BD REF:N55W24206 PEPPERTREE DR S, S | 100.00 | 100-23230 | Occupancy Deposits |
| 09/26/2024 | 68346 | WAUKESHA CTY TREAS-RM148 | VEHICLE MAINT & REPAIR | 7,823.31 | 100-53311-000-244 | Maint--Vehicle |
| 09/26/2024 | 68347 | WRWA | CONSOLIDATED SAFETY TRAINING CONFINED | 78.63 | 610-53700-000-930 | Misc General Expenses |
| 09/30/2024 | 800253 | SPECTRUM | DIGITAL ADAPTERS | 7.39 | 100-53311-000-220 | Utilities--Telephone |
| 09/30/2024 | 800253 | SPECTRUM | DIGITAL ADAPTERS | 7.38 | 100-55200-000-220 | Utilities--Telephone |
| 09/30/2024 | 800253 | MID-AMERICAN RESEARCH CHE | WALLOP WATERLESS HAND CLEANER - B/O ITE | 178.91 | 620-53610-100-249 | Maint--General Plant |
| 09/30/2024 | 800253 | PRO INDUSTRIAL CONT | PARTS | 34.71 | 620-53610-100-249 | Maint--General Plant |
| 09/30/2024 | 800253 | AMZN MKTP US | Well 8 Generator Maint | 51.88 | 610-53700-000-955 | Pumping-Maint of Equipment |
| 09/30/2024 | 800253 | PORT-A-JOHN -CLV | SEASONAL RR - YARD WASTE SITE | 90.00 | 100-53635-000-298 | Contract--Misc Sanitation |
| 09/30/2024 | 800253 | PORT-A-JOHN -CLV | SEASONAL RR - WWTP | 100.00 | 620-53610-100-249 | Maint--General Plant |
| 09/30/2024 | 800253 | OFFICEVIBE/WORKLEAP PLATFORM INC. | 4 ADDL LICENSES | 71.72 | 100-51410-000-180 | Human Resources Expense |
| 09/30/2024 | 800253 | BIG JIMS SMALL ENGINE SVC | Fuel for Small Engines | 118.78 | 100-52200-000-239 | Gasoline & Diesel |
| 09/30/2024 | 800253 | CINTAS CORP PCARD | CLEANING SUPPLIES - AUG 2024 | 155.92 | 100-52200-000-242 | Maint--Bldg & Facilities |
| 09/30/2024 | 800253 | CINTAS CORP PCARD | UNIFORMS - AUG 2024 | 470.13 | 100-53311-000-345 | Supplies |
| 09/30/2024 | 800253 | CINTAS CORP PCARD | UNIFORMS - AUG 2024 | 524.09 | 610-53700-000-930 | Misc General Expenses |
| 09/30/2024 | 800253 | CINTAS CORP PCARD | UNIFORMS - AUG 2024 | 524.09 | 620-53610-100-349 | Other Operating Supplies |
| 09/30/2024 | 800253 | SPECTRUM | ROADRUNNER | 64.99 | 100-53311-000-220 | Utilities--Telephone |
| 09/30/2024 | 800253 | SPECTRUM | ROADRUNNER | 65.00 | 100-55200-000-220 | Utilities--Telephone |
| 09/30/2024 | 800253 | SPECTRUM | ROADRUNNER | 149.98 | 620-53610-100-310 | Office Supplies |
| 09/30/2024 | 800253 | SPECTRUM | ROADRUNNER | 75.00 | 100-52100-000-220 | Utilities--Telephone |
| 09/30/2024 | 800253 | SPECTRUM | ROADRUNNER | 74.99 | 100-52200-000-220 | Utilities--Telephone |

| Check Issue Date | Check Number | Merchant Name | Description | Amount | Invoice GL Account | Invoice GL Account Title |
|------------------|--------------|--------------------------------------|---|-----------|--------------------|-------------------------------|
| 09/30/2024 | 800253 | SPECTRUM | BASIC TV CIVIC CENTER | 107.44 | 100-51600-000-220 | Utilities--Telephone |
| 09/30/2024 | 800253 | IN *BUSINESS TELEPHONE & | RAN 3 CAT 6 CABLES - WTR | 390.00 | 100-57190-000-810 | Equipment |
| 09/30/2024 | 800253 | PAYROLLORG PCARD | MEMBERSHIP KIT - DE | 74.75 | 620-53610-100-345 | Supplies |
| 09/30/2024 | 800253 | PAYROLLORG PCARD | MEMBERSHIP KIT - DE | 149.50 | 100-51510-000-390 | Expenses |
| 09/30/2024 | 800253 | PAYROLLORG PCARD | MEMBERSHIP KIT - DE | 74.75 | 610-53700-000-930 | Misc General Expenses |
| 09/30/2024 | 800253 | SALAMONE SUPPLIES INC | CLEANING SUPPLIES | 78.41 | 100-55200-000-298 | Contract--Misc Sanitation |
| 09/30/2024 | 800253 | SALAMONE SUPPLIES INC | CLEANING SUPPLIES | 319.98 | 100-51600-000-242 | Maint--Bldg & Facilities |
| 09/30/2024 | 800253 | SALAMONE SUPPLIES INC | DISINFECTANT | 38.34 | 100-51600-000-242 | Maint--Bldg & Facilities |
| 09/30/2024 | 800253 | MAD SCIENCE OF MILWAUK | NASA ACADEMY SPACE EXPLORERS CAMP | 2,673.00 | 100-55350-000-140 | Program Instructors |
| 09/30/2024 | 800253 | R A SMITH NATIONAL INC | VISTA RUN PHASE 3 - PROF SERV JULY 2024 | 11,644.17 | 100-51491-000-216 | Engineering |
| 09/30/2024 | 800253 | TALLGRASS RESTORATION LLC - PCARD | VISTA RUN PRAIRIE TRMT #2 | 1,570.00 | 100-57620-000-820 | Improvements |
| 09/30/2024 | 800253 | TRIMBLE INC | Plan & Zone Software | 366.45 | 100-56700-000-390 | Expenses |
| 09/30/2024 | 800253 | NORTHERN LAKE SERVICE- IN PCARD | TOTAL COLIFORM BACTERIA | 137.50 | 610-53700-000-632 | Treatment-Supplies & Expenses |
| 09/30/2024 | 800253 | NORTHERN LAKE SERVICE- IN PCARD | TOTAL COLIFORM BACTERIA | 137.50 | 610-53700-000-632 | Treatment-Supplies & Expenses |
| 09/30/2024 | 800253 | NORTHERN LAKE SERVICE- IN PCARD | TOTAL COLIFORM BACTERIA | 137.50 | 610-53700-000-632 | Treatment-Supplies & Expenses |
| 09/30/2024 | 800253 | EUROFINS S-F ANALYTICAL LABS - PCARD | FINAL EFFLUENT | 423.04 | 620-53610-300-212 | Outside Services |
| 09/30/2024 | 800253 | EUROFINS S-F ANALYTICAL LABS - PCARD | SST #2 | 313.09 | 620-53610-300-212 | Outside Services |
| 09/30/2024 | 800253 | EUROFINS S-F ANALYTICAL LABS - PCARD | FINAL EFFLUENT | 168.52 | 620-53610-300-212 | Outside Services |
| 09/30/2024 | 800253 | EUROFINS S-F ANALYTICAL LABS - PCARD | SST #2 BIOSOLIDS | 76.28 | 620-53610-300-212 | Outside Services |
| 09/30/2024 | 800253 | EUROFINS S-F ANALYTICAL LABS - PCARD | FINAL EFFLUENT | 168.52 | 620-53610-300-212 | Outside Services |
| 09/30/2024 | 800253 | EUROFINS S-F ANALYTICAL LABS - PCARD | FINAL EFFLUENT | 423.04 | 620-53610-300-212 | Outside Services |
| 09/30/2024 | 800253 | AMZN MKTP US | WATERPROOF WORK GLOVES | 18.98 | 100-53311-000-345 | Supplies |
| 09/30/2024 | 800253 | ATT* BILL PAYMENT | PHONES | 19.46 | 100-51600-000-220 | Utilities--Telephone |
| 09/30/2024 | 800253 | ATT* BILL PAYMENT | PHONES | 19.46 | 100-52100-000-220 | Utilities--Telephone |
| 09/30/2024 | 800253 | ATT* BILL PAYMENT | PHONES | 77.85 | 100-53311-000-220 | Utilities--Telephone |
| 09/30/2024 | 800253 | ATT* BILL PAYMENT | PHONES | 38.93 | 610-53700-000-921 | Office Supplies & Expenses |
| 09/30/2024 | 800253 | ATT* BILL PAYMENT | PHONES | 19.47 | 610-53700-000-953 | Pumping-Supplies & Expenses |
| 09/30/2024 | 800253 | ATT* BILL PAYMENT | PHONES | 19.46 | 620-53610-100-310 | Office Supplies |
| 09/30/2024 | 800253 | ATT* BILL PAYMENT | PHONES | 58.39 | 620-53610-200-243 | Maint--Collection Pump Equip |
| 09/30/2024 | 800253 | THE HOME DEPOT | MATERIALS-REPAIR BACK WALL & DOOR SHERI | 48.05 | 100-52100-000-242 | Maint--Bldg & Facilities |
| 09/30/2024 | 800253 | SHERWIN WILLIAMS | PAINT - POLICE DEPT | 87.46 | 100-52100-000-242 | Maint--Bldg & Facilities |
| 09/30/2024 | 800253 | AMZN MKTP US | BINDER POCKET FOLDERS | 24.79 | 100-53311-000-345 | Supplies |
| 09/30/2024 | 800253 | AMAZON RETA | Civic Build Maint Cleaning Supplies | 33.14 | 100-51600-000-242 | Maint--Bldg & Facilities |
| 09/30/2024 | 800253 | MENARDS PEWAUKEE WI | CLEANING SUPPLIES | 88.72 | 100-53311-000-345 | Supplies |
| 09/30/2024 | 800253 | MENARDS PEWAUKEE WI | BRIGHTON 2X2 | 67.04 | 100-14500 | Due from Haass Library |
| 09/30/2024 | 800253 | MENARDS PEWAUKEE WI | DRILL BIT | 11.16 | 100-55200-000-348 | Tools |
| 09/30/2024 | 800253 | MENARDS PEWAUKEE WI | WATER, TEKS PFH WING | 85.86 | 100-55200-000-298 | Contract--Misc Sanitation |
| 09/30/2024 | 800253 | MENARDS PEWAUKEE WI | SEWER PIPE | 19.99 | 610-53700-000-652 | Maint of Services (Lat) |
| 09/30/2024 | 800253 | MENARDS PEWAUKEE WI | THICK DECK WOOD | 281.40 | 100-55200-000-240 | Maint--Equipment |
| 09/30/2024 | 800253 | MENARDS PEWAUKEE WI | TOWEL EXCALIBUR, SHEET MINERAL BLUE | 22.75 | 610-53700-000-653 | Maint of Meters |

| Check Issue Date | Check Number | Merchant Name | Description | Amount | Invoice GL Account | Invoice GL Account Title |
|------------------|--------------|---------------------------------|--|-----------|--------------------|----------------------------|
| 09/30/2024 | 800253 | MENARDS PEWAUKEE WI | ALUMINUM 2 STEP TI | 34.97 | 610-53700-000-653 | Maint of Meters |
| 09/30/2024 | 800253 | MENARDS PEWAUKEE WI | TRASH CAN, BAGS, DISPOSAL | 128.42 | 100-53311-000-242 | Maint--Bldg & Facilities |
| 09/30/2024 | 800253 | MENARDS PEWAUKEE WI | MATERIALS PATH AT CC - DONATION HAMILTON | 483.60 | 100-55200-000-298 | Contract--Misc Sanitation |
| 09/30/2024 | 800253 | SUPERIOR CHEMICAL CORP | BUZZ SAW POWER CLEANER | 177.04 | 100-53311-000-345 | Supplies |
| 09/30/2024 | 800253 | ICMA ONLINE | Job Posting | 450.00 | 100-51410-000-180 | Human Resources Expense |
| 09/30/2024 | 800253 | AMZN MKTP US | Sewer Defib Machine | 129.99 | 620-53610-100-345 | Supplies |
| 09/30/2024 | 800253 | AMZN MKTP US | BINDER POCKET FOLDERS | 27.97 | 100-53311-000-345 | Supplies |
| 09/30/2024 | 800253 | AMZN MKTP US | RETURN - BINDER POCKET FOLDERS | 19.99 | 100-53311-000-345 | Supplies |
| 09/30/2024 | 800253 | JIMMY JOHNS | Budget Dinner - Jimmy Johns | 72.19 | 100-51100-000-390 | Expenses |
| 09/30/2024 | 800253 | AMZN MKTP US | Building Portal Desk | 69.98 | 100-52400-000-390 | Expenses |
| 09/30/2024 | 800253 | DORNER PRODUCTS, LLC | WELL 4 - PUMP SERVICE | 4,333.00 | 610-53700-000-955 | Pumping-Maint of Equipment |
| 09/30/2024 | 800253 | TST* RUMORS SPORTS BAR & | LUNCH - INTERNS DONE | 47.32 | 610-53700-000-930 | Misc General Expenses |
| 09/30/2024 | 800253 | TST* RUMORS SPORTS BAR & | LUNCH - INTERNS DONE | 47.33 | 620-53610-100-345 | Supplies |
| 09/30/2024 | 800253 | L&R LAWN EQUIPMENT & REPAIR INC | Chainsaw Bar & Chain | 101.97 | 100-52200-000-240 | Maint--Equipment |
| 09/30/2024 | 800253 | LAKESHORE RECYCLING SYST | RUBBISH SERVICE - SEPT 2024 | 35,525.00 | 100-53620-000-290 | Contractual Fees |
| 09/30/2024 | 800253 | LAKESHORE RECYCLING SYST | RECYCLING SERVICE - SEPT 2024 | 14,595.00 | 100-53635-000-290 | Contractual Fees |
| 09/30/2024 | 800253 | WISCONSIN WASTEWATER OPER | MEMBERSHIP - JB | 30.00 | 620-53610-100-345 | Supplies |
| 09/30/2024 | 800253 | CLAREY'S SAFETY EQUIPMENT | Replace Saw Blades | 280.00 | 100-52200-000-240 | Maint--Equipment |
| 09/30/2024 | 800253 | AMZN MKTP US | 3rd Floor Office Supplies | 2.61 | 100-53311-000-345 | Supplies |
| 09/30/2024 | 800253 | AMZN MKTP US | 3rd Floor Office Supplies | 2.61 | 100-51410-000-310 | Office Supplies |
| 09/30/2024 | 800253 | AMZN MKTP US | 3rd Floor Office Supplies | 5.60 | 100-51491-000-310 | Office Supplies |
| 09/30/2024 | 800253 | AMZN MKTP US | 3rd Floor Office Supplies | 2.61 | 100-51510-000-310 | Office Supplies |
| 09/30/2024 | 800253 | AMZN MKTP US | 3rd Floor Office Supplies | 1.49 | 100-52200-000-345 | Supplies |
| 09/30/2024 | 800253 | AMZN MKTP US | 3rd Floor Office Supplies | 5.59 | 100-52400-000-390 | Expenses |
| 09/30/2024 | 800253 | AMZN MKTP US | 3rd Floor Office Supplies | 7.64 | 610-53700-000-921 | Office Supplies & Expenses |
| 09/30/2024 | 800253 | AMZN MKTP US | 3rd Floor Office Supplies | 7.64 | 620-53610-100-310 | Office Supplies |
| 09/30/2024 | 800253 | AMZN MKTP US | 3rd Floor Office Supplies | 1.49 | 640-53650-000-310 | Office Supplies |
| 09/30/2024 | 800253 | TEST EQUIPMENT DEPOT | IT EQUIP | 2,531.00 | 100-51430-000-390 | Expenses |
| 09/30/2024 | 800253 | AMZN MKTP US | Toner for Finance Printer | 4.40 | 100-51410-000-310 | Office Supplies |
| 09/30/2024 | 800253 | AMZN MKTP US | Toner for Finance Printer | 25.20 | 100-51420-000-310 | Office Supplies |
| 09/30/2024 | 800253 | AMZN MKTP US | Toner for Finance Printer | 9.45 | 100-51491-000-310 | Office Supplies |
| 09/30/2024 | 800253 | AMZN MKTP US | Toner for Finance Printer | 4.41 | 100-51510-000-310 | Office Supplies |
| 09/30/2024 | 800253 | AMZN MKTP US | Toner for Finance Printer | 2.52 | 100-52200-000-345 | Supplies |
| 09/30/2024 | 800253 | AMZN MKTP US | Toner for Finance Printer | 9.45 | 100-52400-000-390 | Expenses |
| 09/30/2024 | 800253 | AMZN MKTP US | Toner for Finance Printer | 4.41 | 100-53311-000-345 | Supplies |
| 09/30/2024 | 800253 | AMZN MKTP US | Toner for Finance Printer | 3.15 | 100-55200-000-310 | Office Supplies |
| 09/30/2024 | 800253 | AMZN MKTP US | Toner for Finance Printer | 25.20 | 100-55300-000-310 | Office Supplies |
| 09/30/2024 | 800253 | AMZN MKTP US | Toner for Finance Printer | 16.38 | 610-53700-000-921 | Office Supplies & Expenses |
| 09/30/2024 | 800253 | AMZN MKTP US | Toner for Finance Printer | 16.38 | 620-53610-100-310 | Office Supplies |
| 09/30/2024 | 800253 | AMZN MKTP US | Toner for Finance Printer | 5.04 | 640-53650-000-310 | Office Supplies |

| Check Issue Date | Check Number | Merchant Name | Description | Amount | Invoice GL Account | Invoice GL Account Title |
|------------------|--------------|---------------------------------------|---|-----------|--------------------|-------------------------------|
| 09/30/2024 | 800253 | A/E GRAPHICS, INC. | PLOTTER MAINT. & COPIES | 6.86 | 100-14500 | Due from Haass Library |
| 09/30/2024 | 800253 | A/E GRAPHICS, INC. | PLOTTER MAINT. & COPIES | 6.86 | 100-51491-000-310 | Office Supplies |
| 09/30/2024 | 800253 | A/E GRAPHICS, INC. | PLOTTER MAINT. & COPIES | 11.45 | 100-55300-000-310 | Office Supplies |
| 09/30/2024 | 800253 | A/E GRAPHICS, INC. | PLOTTER MAINT. & COPIES | 6.86 | 100-56700-000-390 | Expenses |
| 09/30/2024 | 800253 | A/E GRAPHICS, INC. | PLOTTER MAINT. & COPIES | 4.57 | 610-53700-000-921 | Office Supplies & Expenses |
| 09/30/2024 | 800253 | A/E GRAPHICS, INC. | PLOTTER MAINT. & COPIES | 4.57 | 620-53610-100-310 | Office Supplies |
| 09/30/2024 | 800253 | A/E GRAPHICS, INC. | PLOTTER MAINT. & COPIES | 4.57 | 640-53650-000-310 | Office Supplies |
| 09/30/2024 | 800253 | WMH RETAIL PHARMACY | MEDICAL SUPPLIES | 18.45 | 100-52200-000-342 | Medical Supplies |
| 09/30/2024 | 800253 | TYCOINTEGRATEDSECURITY | SECURITY ALARM - WOODSIDE TOWER | 84.41 | 610-53700-000-650 | Maint of Distribution System |
| 09/30/2024 | 800253 | TYCOINTEGRATEDSECURITY | SECURITY ALARM - WELL 5 | 90.02 | 610-53700-000-650 | Maint of Distribution System |
| 09/30/2024 | 800253 | TYCOINTEGRATEDSECURITY | SECURITY ALARM - WELL 5 | 90.02 | 610-53700-000-955 | Pumping-Maint of Equipment |
| 09/30/2024 | 800253 | TYCOINTEGRATEDSECURITY | SECURITY ALARM - WELL 4 | 106.25 | 610-53700-000-955 | Pumping-Maint of Equipment |
| 09/30/2024 | 800253 | TYCOINTEGRATEDSECURITY | SECURITY ALARM - WELL 6 & 7 | 136.98 | 610-53700-000-955 | Pumping-Maint of Equipment |
| 09/30/2024 | 800253 | COMMUNITY HOSP GENERAL | MEDICAL SUPPLIES | 22.26 | 100-52200-000-342 | Medical Supplies |
| 09/30/2024 | 800253 | COMPLETE OFFICE OF WISCON | Toilet bowl cleaner | 40.62 | 100-52200-000-242 | Maint--Bldg & Facilities |
| 09/30/2024 | 800253 | COMPLETE OFFICE OF WISCON | Cleaning Supplies Sheriff Side | 265.46 | 100-52100-000-390 | Expenses |
| 09/30/2024 | 800253 | AMZN MKTP US | IT EQUIP-Being Returned | 43.98 | 100-51430-000-390 | Expenses |
| 09/30/2024 | 800253 | AMZN MKTP US | IT EQUIP | 43.98 | 100-51430-000-390 | Expenses |
| 09/30/2024 | 800253 | BADGER METER PCARD | BEACON HOSTING SERVICE- AUG 2024 | 275.73 | 610-53700-000-935 | Maint--Genl Plant & Equip |
| 09/30/2024 | 800253 | BELL WELL SALES CO - PCARD | NUTS & BOLTS | 358.87 | 610-53700-000-651 | Maint of Mains |
| 09/30/2024 | 800253 | BELL WELL SALES CO - PCARD | NUTS & BOLTS | 179.44 | 610-53700-000-653 | Maint of Meters |
| 09/30/2024 | 800253 | BELL WELL SALES CO - PCARD | NUTS & BOLTS | 179.44 | 610-53700-000-654 | Maint of Hydrants |
| 09/30/2024 | 800253 | SERVICE SANITATION WI | RESTROOMS - 100 YR CELEBRATION | 2,110.00 | 100-55202-000-403 | Special Events |
| 09/30/2024 | 800253 | SERVICE SANITATION WI | PORT A JOHN - VP | 520.15 | 100-55200-000-298 | Contract--Misc Sanitation |
| 09/30/2024 | 800253 | SERVICE SANITATION WI | PORT A JOHN - AP - EXTRA UNIT ADDED SOCCE | 211.15 | 100-55200-000-298 | Contract--Misc Sanitation |
| 09/30/2024 | 800253 | SERVICE SANITATION WI | PORT A JOHN - MW | 113.30 | 100-55200-000-298 | Contract--Misc Sanitation |
| 09/30/2024 | 800253 | AMAZON.COM | Building Portal Desk | 117.95 | 100-52400-000-390 | Expenses |
| 09/30/2024 | 800253 | BELL WELL SALES CO - PCARD | HATCH BOLTS - STANDPIPE | 133.25 | 610-53700-000-650 | Maint of Distribution System |
| 09/30/2024 | 800253 | AMZN MKTP US | Civic Build Maint Cleaning Supplies | 47.04 | 100-51600-000-242 | Maint--Bldg & Facilities |
| 09/30/2024 | 800253 | NORTHWEST RIVER SUPPLIES | Capital Fire Fight Equip. | 1,255.50 | 100-57220-000-810 | Equipment |
| 09/30/2024 | 800253 | SJ ELECTRO SYSTEMS, LLC | CLACK VALVE W/GASKET & SPACERS GASKET | 1,080.36 | 620-53610-300-249 | Maint--General Plant |
| 09/30/2024 | 800253 | SJ ELECTRO SYSTEMS, LLC | NEW EFFLUENT FLOW METER MAINT | 2,873.52 | 620-18335 | Advance Treatment Equipment |
| 09/30/2024 | 800253 | SJ ELECTRO SYSTEMS, LLC | NEW EFFLUENT FLOW METER MAINT - LANNON | 293.25 | 620-53610-416-249 | Maint--General Plant |
| 09/30/2024 | 800253 | MILWAUKEE JOURNAL | Journal Digital | 19.99 | 100-51410-000-180 | Human Resources Expense |
| 09/30/2024 | 800253 | MILLER BRADFORD RISBERG-PCARD CURRENT | POWER RAKE | 12,635.00 | 100-57324-000-810 | Equipment |
| 09/30/2024 | 800253 | TAPCO | SPLASH PAD SIGN | 73.50 | 100-55200-000-394 | Splashpad Operations |
| 09/30/2024 | 800253 | WISCONSIN WASTEWATER OPER | Dustin and Ethan WWOA Conference Dues | 480.00 | 620-53610-100-345 | Supplies |
| 09/30/2024 | 800253 | WISCONSIN WASTEWATER OPER | Jake Fugiaso WWOA Membership | 30.00 | 620-53610-100-345 | Supplies |
| 09/30/2024 | 800253 | WISCONSIN WASTEWATER OPER | Joe Ackeret WWOA Membership | 30.00 | 620-53610-100-345 | Supplies |
| 09/30/2024 | 800253 | USA BLUE BOOK | HACH DPD 1 | 52.30 | 610-53700-000-632 | Treatment-Supplies & Expenses |

| Check Issue Date | Check Number | Merchant Name | Description | Amount | Invoice GL Account | Invoice GL Account Title |
|------------------|--------------|---------------------------|--|----------|--------------------|-------------------------------|
| 09/30/2024 | 800253 | USA BLUE BOOK | BLUE MARKING FLAGS | 93.37 | 610-53700-000-641 | Operation Supplies & Expenses |
| 09/30/2024 | 800253 | JONES LAKE MANAGEMENT | POND MANAGEMENT | 543.75 | 640-53650-000-242 | Maint--Bldg & Facilities |
| 09/30/2024 | 800253 | DAVE JONES INC | AUG 2024 ANNL FIRE SPRINKLER INSP - PHPL | 452.00 | 100-14500 | Due from Haass Library |
| 09/30/2024 | 800253 | DAVE JONES INC | AUG 2024 ANNL FIRE SPRINKLER INSP - CC | 295.00 | 100-51600-000-242 | Maint--Bldg & Facilities |
| 09/30/2024 | 800253 | DAVE JONES INC | AUG 2024 ANNL FIRE SPRINKLER INSP - POLICE | 110.00 | 100-52100-000-242 | Maint--Bldg & Facilities |
| 09/30/2024 | 800253 | DAVE JONES INC | AUG 2024 ANNL FIRE SPRINKLER INSP - FIRE | 110.00 | 100-52200-000-242 | Maint--Bldg & Facilities |
| 09/30/2024 | 800253 | DAVE JONES INC | AUG 2024 ANNL FIRE SPRINKLER INSP - THE G | 185.00 | 100-55200-000-242 | Maint--Bldg & Facilities |
| 09/30/2024 | 800253 | DAVE JONES INC | AUG 2024 ANNL FIRE SPRINKLER INSP - WELL 8 | 185.00 | 610-53700-000-955 | Pumping-Maint of Equipment |
| 09/30/2024 | 800253 | DAVE JONES INC | AUG 2024 ANNL FIRE SPRINKLER INSP - PW | 220.00 | 100-53311-000-242 | Maint--Bldg & Facilities |
| 09/30/2024 | 800253 | DAVE JONES INC | AUG 2024 ANNL FIRE SPRINKLER INSP - WWTP | 185.00 | 620-53610-100-249 | Maint--General Plant |
| 09/30/2024 | 800253 | DAVE JONES INC | AUG 2024 ANNL FIRE SPRINKLER INSP - WELL 5 | 219.00 | 610-53700-000-955 | Pumping-Maint of Equipment |
| 09/30/2024 | 800253 | DAVE JONES INC | REPLACED COMPRESSOR FOR NITRO GENERA | 2,175.00 | 100-14500 | Due from Haass Library |
| 09/30/2024 | 800253 | DAVE JONES INC | SERVICE CALL - BLDG LOST POWER - PHPL | 296.00 | 100-14500 | Due from Haass Library |
| 09/30/2024 | 800253 | BROOKS TRACTOR | EQUIPMENT RENTAL - GROGAN PARK PROJEC | 1,400.00 | 100-57620-000-820 | Improvements |
| 09/30/2024 | 800253 | AMZN MKTP US | MIRROS FOR WINE TASTING | 21.99 | 100-54600-000-405 | Program Expenses |
| 09/30/2024 | 800253 | AMZN MKTP US | WINE TASTING | 133.03 | 100-54600-000-405 | Program Expenses |
| 09/30/2024 | 800253 | SONIC WALL | Support/Updates for WWTP Firewall/Router | 74.29 | 620-53610-100-212 | Outside Services |
| 09/30/2024 | 800253 | SONIC WALL | Support/Updates for WWTP Firewall/Router | 18.79 | 640-53650-000-340 | Data Processing Services |
| 09/30/2024 | 800253 | SQ *WISCONSIN FIRE CHIEFS | WI STATE Conference | 225.00 | 100-52200-000-324 | Schooling & Dues |
| 09/30/2024 | 800253 | THE HOME DEPOT | Building Maintenance: FD | 220.30 | 100-52200-000-242 | Maint--Bldg & Facilities |
| 09/30/2024 | 800253 | UWCC REGISTRATIONS | jake artymiuk classes | 370.00 | 100-55300-000-324 | Schooling & Dues |
| 09/30/2024 | 800253 | WALGREENS | dance supplies | 14.14 | 100-55350-200-390 | DANCE Expenses |
| 09/30/2024 | 800253 | WALMART.COM | dance recital supplies | 27.30 | 100-55350-200-390 | DANCE Expenses |
| 09/30/2024 | 800253 | WCTC MARKETPLACE | Fire Inspector Practical | 80.00 | 100-52200-000-324 | Schooling & Dues |
| 09/30/2024 | 800253 | WEISSMANS THEATRICAL SU | dance supplies | 119.50 | 100-55350-200-390 | DANCE Expenses |
| 09/30/2024 | 800253 | WI DFI WS2 CFI CC EPAY | annual condo filing | 12.50 | 100-51420-000-390 | Expenses |
| 09/30/2024 | 800253 | AMZN MKTP US | ART SUPPLIES | 163.37 | 100-54600-000-405 | Program Expenses |
| 09/30/2024 | 800253 | WI DFI WS2 CFI CC EPAY | annual condo filing | 6.25 | 610-53700-000-930 | Misc General Expenses |
| 09/30/2024 | 800253 | WI DFI WS2 CFI CC EPAY | annual condo filing | 6.25 | 620-53610-100-345 | Supplies |
| 09/30/2024 | 800253 | AMZN MKTP US | day camp supplies | 15.99 | 100-55350-100-390 | DAY CAMP Expenses |
| 09/30/2024 | 800253 | AMZN MKTP US | day camp supplies | 154.32 | 100-55350-100-390 | DAY CAMP Expenses |
| 09/30/2024 | 800253 | AMZN MKTP US | day camp supplies | 63.95 | 100-55350-100-390 | DAY CAMP Expenses |
| 09/30/2024 | 800253 | AMZN MKTP US | day camp supplies | 15.98 | 100-55350-100-390 | DAY CAMP Expenses |
| 09/30/2024 | 800253 | AMZN MKTP US | day camp supplies | 34.95 | 100-55350-100-390 | DAY CAMP Expenses |
| 09/30/2024 | 800253 | AMZN MKTP US | day camp supplies | 282.11 | 100-55350-100-390 | DAY CAMP Expenses |
| 09/30/2024 | 800253 | AMZN MKTP US | day camp supplies | 78.99 | 100-55350-100-390 | DAY CAMP Expenses |
| 09/30/2024 | 800253 | AMZN MKTP US | day camp supplies | 119.45 | 100-55350-100-390 | DAY CAMP Expenses |
| 09/30/2024 | 800253 | AMZN MKTP US | day camp supplies | 17.96 | 100-55350-100-390 | DAY CAMP Expenses |
| 09/30/2024 | 800253 | AMZN MKTP US | day camp supplies | 25.99 | 100-55350-100-390 | DAY CAMP Expenses |
| 09/30/2024 | 800253 | AMZN MKTP US | RECITAL DECORATIONS | 14.99 | 100-55350-200-140 | DANCE Program Instructors |

| Check Issue Date | Check Number | Merchant Name | Description | Amount | Invoice GL Account | Invoice GL Account Title |
|------------------|--------------|---------------|---|--------|--------------------|----------------------------|
| 09/30/2024 | 800253 | AMZN MKTP US | dance recital supplies | 21.98 | 100-55350-200-390 | DANCE Expenses |
| 09/30/2024 | 800253 | AMZN MKTP US | dance recital supplies | 39.96 | 100-55350-200-390 | DANCE Expenses |
| 09/30/2024 | 800253 | AMZN MKTP US | GROWN UP AND ME | 15.28 | 100-55350-000-390 | Expenses |
| 09/30/2024 | 800253 | AMZN MKTP US | POST IT NOTEPADS | 6.54 | 100-55202-000-403 | Special Events |
| 09/30/2024 | 800253 | AMZN MKTP US | drill bit sharpener | 109.95 | 100-55200-000-348 | Tools |
| 09/30/2024 | 800253 | AMZN MKTP US | office supplies | 12.40 | 100-51420-000-310 | Office Supplies |
| 09/30/2024 | 800253 | AMZN MKTP US | office supplies | 1.55 | 100-55200-000-390 | Expenses |
| 09/30/2024 | 800253 | AMZN MKTP US | office supplies | 12.40 | 100-55300-000-310 | Office Supplies |
| 09/30/2024 | 800253 | AMZN MKTP US | dance supplies | 27.99 | 100-55350-200-390 | DANCE Expenses |
| 09/30/2024 | 800253 | AMZN MKTP US | office supplies | 1.70 | 610-53700-000-921 | Office Supplies & Expenses |
| 09/30/2024 | 800253 | AMZN MKTP US | office supplies | 1.70 | 620-53610-100-310 | Office Supplies |
| 09/30/2024 | 800253 | AMZN MKTP US | office supplies | 1.24 | 640-53650-000-310 | Office Supplies |
| 09/30/2024 | 800253 | AMZN MKTP US | IT Network Tester (Returned/Refunded) | 68.39 | 100-57190-000-810 | Equipment |
| 09/30/2024 | 800253 | AMZN MKTP US | IT Network Tester (Returned/Refunded) | 22.80 | 610-53700-000-921 | Office Supplies & Expenses |
| 09/30/2024 | 800253 | AMZN MKTP US | IT Network Tester (Returned/Refunded) | 22.80 | 620-53610-100-310 | Office Supplies |
| 09/30/2024 | 800253 | AMZN MKTP US | office supplies | 26.04 | 100-51420-000-310 | Office Supplies |
| 09/30/2024 | 800253 | AMZN MKTP US | office supplies | 3.25 | 100-55200-000-390 | Expenses |
| 09/30/2024 | 800253 | AMZN MKTP US | office supplies | 26.04 | 100-55300-000-310 | Office Supplies |
| 09/30/2024 | 800253 | AMZN MKTP US | office supplies | 3.58 | 610-53700-000-921 | Office Supplies & Expenses |
| 09/30/2024 | 800253 | AMZN MKTP US | GRASS YARD SIGNS | 28.01 | 100-55200-000-298 | Contract--Misc Sanitation |
| 09/30/2024 | 800253 | AMZN MKTP US | office supplies | 3.58 | 620-53610-100-310 | Office Supplies |
| 09/30/2024 | 800253 | AMZN MKTP US | office supplies | 2.60 | 640-53650-000-310 | Office Supplies |
| 09/30/2024 | 800253 | AMZN MKTP US | dance costumes | 27.14- | 100-55350-200-390 | DANCE Expenses |
| 09/30/2024 | 800253 | AMZN MKTP US | dance costumes | 27.14- | 100-55350-200-390 | DANCE Expenses |
| 09/30/2024 | 800253 | AMZN MKTP US | IT Network Tester Refund | 68.39- | 100-57190-000-810 | Equipment |
| 09/30/2024 | 800253 | AMZN MKTP US | IT Network Tester Refund | 22.80- | 610-53700-000-921 | Office Supplies & Expenses |
| 09/30/2024 | 800253 | AMZN MKTP US | IT Network Tester Refund | 22.80- | 620-53610-100-310 | Office Supplies |
| 09/30/2024 | 800253 | AMAZON RETA | pint sized flag football | 99.90 | 100-55350-000-390 | Expenses |
| 09/30/2024 | 800253 | AMAZON RETA | Chainsaw Chain | 72.74 | 100-52200-000-240 | Maint--Equipment |
| 09/30/2024 | 800253 | AMAZON RETA | Hair dryers for warming blankets per Dr Schultz | 35.06 | 100-52200-000-342 | Medical Supplies |
| 09/30/2024 | 800253 | AMZN MKTP US | inner tube for the zero turn | 74.99 | 100-55200-000-240 | Maint--Equipment |
| 09/30/2024 | 800253 | AMAZON.COM | RETURNED 6 FOOTBALLS FOR FLAG FOOTBAL | 45.40- | 100-55350-000-390 | Expenses |
| 09/30/2024 | 800253 | AMAZON.COM | pint sized flag football | 19.98 | 100-55350-000-390 | Expenses |
| 09/30/2024 | 800253 | AMAZON.COM | PINT SIZED FLAG FOOTBALL | 90.80 | 100-55350-000-390 | Expenses |
| 09/30/2024 | 800253 | AMAZON.COM | day camp supplies | 31.49 | 100-55350-100-390 | DAY CAMP Expenses |
| 09/30/2024 | 800253 | AMAZON.COM | day camp supplies | 9.49 | 100-55350-100-390 | DAY CAMP Expenses |
| 09/30/2024 | 800253 | AMAZON.COM | day camp supplies | 11.32 | 100-55350-100-390 | DAY CAMP Expenses |
| 09/30/2024 | 800253 | AMAZON.COM | day camp supplies | 60.97 | 100-55350-100-390 | DAY CAMP Expenses |
| 09/30/2024 | 800253 | AMAZON.COM | TENNIS | 52.30 | 100-55350-000-390 | Expenses |
| 09/30/2024 | 800253 | AMAZON.COM | Wireless access point Refund | 77.40- | 100-57190-000-810 | Equipment |

| Check Issue Date | Check Number | Merchant Name | Description | Amount | Invoice GL Account | Invoice GL Account Title |
|------------------|--------------|---------------------------|--|--------|--------------------|----------------------------|
| 09/30/2024 | 800253 | AMAZON.COM | Wireless access point Refund | 25.80- | 610-53700-000-921 | Office Supplies & Expenses |
| 09/30/2024 | 800253 | AMZN MKTP US | grove outdoor restroom | 129.80 | 100-55200-000-242 | Maint--Bldg & Facilities |
| 09/30/2024 | 800253 | AMAZON.COM | Wireless access point Refund | 25.80- | 620-53610-100-310 | Office Supplies |
| 09/30/2024 | 800253 | AMAZON.COM | Chainsaw case | 127.32 | 100-52200-000-240 | Maint--Equipment |
| 09/30/2024 | 800253 | AMAZON.COM | Monitor Mounting Arm - Permit Kiosk | 15.11 | 100-57190-000-810 | Equipment |
| 09/30/2024 | 800253 | AMAZON.COM | Monitor Mounting Arm - Permit Kiosk | 5.04 | 610-53700-000-921 | Office Supplies & Expenses |
| 09/30/2024 | 800253 | AMAZON.COM | Monitor Mounting Arm - Permit Kiosk | 5.04 | 620-53610-100-310 | Office Supplies |
| 09/30/2024 | 800253 | AMAZON.COM | Bottle Filling Station | 718.65 | 100-52100-000-390 | Expenses |
| 09/30/2024 | 800253 | AMAZON.COM | splash pad first aid kit | 18.69 | 100-55200-000-394 | Splashpad Operations |
| 09/30/2024 | 800253 | AMZN MKTP US | ART SUPPLIES FOR LOBBY EVENT | 197.81 | 100-54600-000-405 | Program Expenses |
| 09/30/2024 | 800253 | AMZN MKTP US | office supplies | 9.48 | 100-51420-000-310 | Office Supplies |
| 09/30/2024 | 800253 | AMZN MKTP US | office supplies | 1.19 | 100-55200-000-390 | Expenses |
| 09/30/2024 | 800253 | AMZN MKTP US | Speakers | 134.95 | 100-52200-000-390 | Expenses |
| 09/30/2024 | 800253 | AMZN MKTP US | office supplies | 9.50 | 100-55300-000-310 | Office Supplies |
| 09/30/2024 | 800253 | AMZN MKTP US | office supplies | 1.31 | 610-53700-000-921 | Office Supplies & Expenses |
| 09/30/2024 | 800253 | AMZN MKTP US | office supplies | 1.31 | 620-53610-100-310 | Office Supplies |
| 09/30/2024 | 800253 | AMZN MKTP US | office supplies | .95 | 640-53650-000-310 | Office Supplies |
| 09/30/2024 | 800253 | BLACKBURN MANUFACTURING | marking paint | 150.97 | 100-55200-000-298 | Contract--Misc Sanitation |
| 09/30/2024 | 800253 | CANVA | Monthly subscription for graphic design software | 15.00 | 100-51430-000-390 | Expenses |
| 09/30/2024 | 800253 | CENTRAL LANDSCAPE SUPPLY | tree protectors | 183.00 | 100-55200-000-400 | Forestry Efforts |
| 09/30/2024 | 800253 | CITY OF WAUKESHA PARKS RE | day camp field trip | 50.00- | 100-55350-100-390 | DAY CAMP Expenses |
| 09/30/2024 | 800253 | COSTCO WHSE | election food | 208.93 | 100-51440-000-390 | Expenses |
| 09/30/2024 | 800253 | COUSINS SUBS | DAY CAMP COUNSELOR LUNCH | 163.22 | 100-55350-100-390 | DAY CAMP Expenses |
| 09/30/2024 | 800253 | AMZN MKTP US | tape measures | 38.94 | 100-55200-000-298 | Contract--Misc Sanitation |
| 09/30/2024 | 800253 | DOLLAR TREE, INC. | AUGUST BINGO | 48.50 | 100-54600-000-405 | Program Expenses |
| 09/30/2024 | 800253 | HOBBY LOBBY | BINGO AND RAFFLE BASKETS FOR WINE TASTI | 56.31 | 100-54600-000-405 | Program Expenses |
| 09/30/2024 | 800253 | KWIK TRIP | election food | 44.93 | 100-51440-000-390 | Expenses |
| 09/30/2024 | 800253 | MARRIOTT MADISON WEST | wmca annual conf.-j. boehm | 239.00 | 100-51420-000-390 | Expenses |
| 09/30/2024 | 800253 | MARRIOTT MADISON WEST | wmca annual conf. j. moore | 393.00 | 100-51420-000-390 | Expenses |
| 09/30/2024 | 800253 | MARRIOTT MADISON WEST | wmca annual conf.-j. boehm | 262.00 | 100-51420-000-390 | Expenses |
| 09/30/2024 | 800253 | MENARDS PEWAUKEE WI | Building Maintenance: FD | 119.94 | 100-52200-000-242 | Maint--Bldg & Facilities |
| 09/30/2024 | 800253 | ODP BUS SOL LLC | office supplies | 206.62 | 100-51420-000-310 | Office Supplies |
| 09/30/2024 | 800253 | ODP BUS SOL LLC | office supplies | 25.83 | 100-55200-000-390 | Expenses |
| 09/30/2024 | 800253 | ODP BUS SOL LLC | office supplies | 206.62 | 100-55300-000-310 | Office Supplies |
| 09/30/2024 | 800253 | AMZN MKTP US | Paramedic class book | 223.96 | 100-52200-000-324 | Schooling & Dues |
| 09/30/2024 | 800253 | ODP BUS SOL LLC | office supplies | 28.41 | 610-53700-000-921 | Office Supplies & Expenses |
| 09/30/2024 | 800253 | ODP BUS SOL LLC | office supplies | 28.41 | 620-53610-100-310 | Office Supplies |
| 09/30/2024 | 800253 | ODP BUS SOL LLC | office supplies | 20.66 | 640-53650-000-310 | Office Supplies |
| 09/30/2024 | 800253 | POOL SUPPLY UNLIMITED | splash pad test disks | 177.57 | 100-55200-000-394 | Splashpad Operations |
| 09/30/2024 | 800253 | RESCUEDIRECT | Capital Ropes | 251.07 | 100-57220-000-810 | Equipment |

| Check Issue Date | Check Number | Merchant Name | Description | Amount | Invoice GL Account | Invoice GL Account Title |
|------------------|--------------|---------------------------------------|--|----------|--------------------|------------------------------|
| 09/30/2024 | 800253 | SAMSClub.COM | Sheriff Side Cleaning products | 56.90 | 100-52100-000-390 | Expenses |
| 09/30/2024 | 800253 | SAMSClub.COM | Laundry Detergent & Paper Towels | 35.96 | 100-52200-000-242 | Maint--Bldg & Facilities |
| 09/30/2024 | 800253 | SAMSClub.COM | Coffee | 43.96 | 100-52200-000-345 | Supplies |
| 09/30/2024 | 800253 | SONIC WALL | Support/Updates for WWTP Firewall/Router | 266.58 | 100-51430-000-397 | Licensing Costs |
| 09/30/2024 | 800253 | SONIC WALL | Support/Updates for WWTP Firewall/Router | 77.35 | 610-53700-000-923 | Outside Services Employed |
| 09/30/2024 | 800253 | MILLER BRADFORD RISBERG-PCARD CURRENT | REPAIRS - WHEEL LOADER | 4,196.45 | 100-53311-000-240 | Maint--Equipment |
| 09/30/2024 | 800253 | DSPS E SERVICE FEE COM | CONVENIENCE FEE - TESTING | 5.40 | 610-53700-000-654 | Maint of Hydrants |
| 09/30/2024 | 800253 | DSPS EPAY ISE | TESTING FEE WATER | 240.00 | 610-53700-000-654 | Maint of Hydrants |
| 09/30/2024 | 800253 | DNR WS2 EM1 EPAY DEM | Dustin Water DNR Cert | 45.00 | 610-53700-000-930 | Misc General Expenses |
| 09/30/2024 | 800253 | DNR WS2 EM1 EPAY DEM | Dustin Water Cert DNR Convience Fee | .90 | 610-53700-000-930 | Misc General Expenses |
| 09/30/2024 | 800253 | ATT* BILL PAYMENT | FIRE DEPT CELL PHONES | 470.29 | 100-52200-000-220 | Utilities--Telephone |
| 09/30/2024 | 800253 | SPECTRUM | PRI & INTERNET | 49.32 | 100-14500 | Due from Haass Library |
| 09/30/2024 | 800253 | SPECTRUM | PRI & INTERNET | 1,303.10 | 100-51600-000-220 | Utilities--Telephone |
| 09/30/2024 | 800253 | SPECTRUM | PRI & INTERNET - AUGUST 2023 | 42.26 | 100-52100-000-220 | Utilities--Telephone |
| 09/30/2024 | 800253 | SPECTRUM | PRI & INTERNET | 42.26 | 100-52200-000-220 | Utilities--Telephone |
| 09/30/2024 | 800253 | ATT* BILL PAYMENT | VOS CELL PHONES AT&T | 22.01 | 100-51420-000-220 | Utilities--Telephone |
| 09/30/2024 | 800253 | ATT* BILL PAYMENT | VOS CELL PHONES AT&T | 23.99 | 100-51600-000-220 | Utilities--Telephone |
| 09/30/2024 | 800253 | ATT* BILL PAYMENT | VOS CELL PHONES AT&T | 14.66 | 100-53311-000-220 | Utilities--Telephone |
| 09/30/2024 | 800253 | ATT* BILL PAYMENT | VOS CELL PHONES AT&T | 179.08 | 100-55200-000-220 | Utilities--Telephone |
| 09/30/2024 | 800253 | ATT* BILL PAYMENT | VOS CELL PHONES AT&T | 119.24 | 100-55300-000-220 | Utilities--Telephone |
| 09/30/2024 | 800253 | ATT* BILL PAYMENT | VOS CELL PHONES AT&T | 71.53 | 100-56700-000-390 | Expenses |
| 09/30/2024 | 800253 | ATT* BILL PAYMENT | VOS CELL PHONES AT&T | 16.24 | 610-53700-000-650 | Maint of Distribution System |
| 09/30/2024 | 800253 | ATT* BILL PAYMENT | VOS CELL PHONES AT&T - PRO 2 | 66.81 | 610-53700-000-651 | Maint of Mains |
| 09/30/2024 | 800253 | ATT* BILL PAYMENT | VOS CELL PHONES AT&T | 39.82 | 610-53700-000-921 | Office Supplies & Expenses |
| 09/30/2024 | 800253 | ATT* BILL PAYMENT | VOS CELL PHONES AT&T - MTR RD PH | 24.32 | 610-53700-000-935 | Maint--Genl Plant & Equip |
| 09/30/2024 | 800253 | ATT* BILL PAYMENT | VOS CELL PHONES AT&T | 16.28 | 610-53700-000-953 | Pumping-Supplies & Expenses |
| 09/30/2024 | 800253 | ATT* BILL PAYMENT | VOS CELL PHONES AT&T | 48.63 | 620-53610-100-310 | Office Supplies |
| 09/30/2024 | 800253 | ATT* BILL PAYMENT | VOS CELL PHONES AT&T | .84 | 640-53650-000-220 | Utilities--Telephone |
| 09/30/2024 | 800253 | ATT* BILL PAYMENT | VOS CELL PHONES - FIRST NET | 78.75 | 100-51410-000-220 | Utilities--Telephone |
| 09/30/2024 | 800253 | ATT* BILL PAYMENT | VOS CELL PHONES - FIRST NET | 19.83 | 100-51491-000-220 | Utilities--Telephone |
| 09/30/2024 | 800253 | ATT* BILL PAYMENT | VOS CELL PHONES - FIRST NET | 31.99 | 100-52400-000-390 | Expenses |
| 09/30/2024 | 800253 | ATT* BILL PAYMENT | VOS CELL PHONES - FIRST NET | 62.80 | 100-53311-000-220 | Utilities--Telephone |
| 09/30/2024 | 800253 | ATT* BILL PAYMENT | VOS CELL PHONES - FIRST NET | 65.94 | 100-55200-000-220 | Utilities--Telephone |
| 09/30/2024 | 800253 | ATT* BILL PAYMENT | VOS CELL PHONES - FIRST NET | 20.95 | 100-55300-000-220 | Utilities--Telephone |
| 09/30/2024 | 800253 | ATT* BILL PAYMENT | VOS CELL PHONES - FIRST NET | 33.56 | 610-53700-000-650 | Maint of Distribution System |
| 09/30/2024 | 800253 | ATT* BILL PAYMENT | VOS CELL PHONES - FIRST NET | 91.43 | 610-53700-000-921 | Office Supplies & Expenses |
| 09/30/2024 | 800253 | ATT* BILL PAYMENT | VOS CELL PHONES - FIRST NET | 33.66 | 610-53700-000-953 | Pumping-Supplies & Expenses |
| 09/30/2024 | 800253 | ATT* BILL PAYMENT | VOS CELL PHONES - FIRST NET | 132.83 | 620-53610-100-310 | Office Supplies |
| 09/30/2024 | 800253 | ATT* BILL PAYMENT | VOS CELL PHONES - FIRST NET | 40.79 | 640-53650-000-220 | Utilities--Telephone |
| 09/30/2024 | 800254 | AFLAC | EMPLOYEE INSURANCE | 115.80 | 100-21595 | AFLAC INS |

| Check Issue Date | Check Number | Merchant Name | Description | Amount | Invoice GL Account | Invoice GL Account Title |
|------------------|--------------|-------------------------------|-------------------------|-----------|--------------------|--------------------------------|
| 09/30/2024 | 800255 | BMO HARRIS BANK NA - PAYMENTS | DAY CAMP FIELD TRIP | 904.00 | 100-55350-100-390 | DAY CAMP Expenses |
| 09/30/2024 | 800255 | BMO HARRIS BANK NA - PAYMENTS | DAY CAMP SUPPLIES | 92.19 | 100-55350-100-390 | DAY CAMP Expenses |
| 09/30/2024 | 800255 | BMO HARRIS BANK NA - PAYMENTS | BUDGET DINNER | 161.11 | 100-51100-000-390 | Expenses |
| 09/30/2024 | 800256 | DELTA DENTAL | DENTAL INSURANCE | 5.45 | 280-54910-000-135 | Employee Insurance |
| 09/30/2024 | 800256 | DELTA DENTAL | DENTAL INSURANCE | 36.71 | 100-13800 | Other Receivables |
| 09/30/2024 | 800256 | DELTA DENTAL | DENTAL INSURANCE | 110.13 | 100-14500 | Due from Haass Library |
| 09/30/2024 | 800256 | DELTA DENTAL | DENTAL INSURANCE | 314.88 | 610-53700-000-926 | Employee Pension & Benefits |
| 09/30/2024 | 800256 | DELTA DENTAL | DENTAL INSURANCE | 277.43 | 620-53610-100-135 | Employee Insurance |
| 09/30/2024 | 800256 | DELTA DENTAL | DENTAL INSURANCE | 111.46 | 640-53650-000-135 | Employee Insurance |
| 09/30/2024 | 800256 | DELTA DENTAL | DENTAL INSURANCE | 29.94 | 100-51491-000-135 | Employee Insurance |
| 09/30/2024 | 800256 | DELTA DENTAL | DENTAL INSURANCE | 14.68 | 100-51410-000-135 | Employee Insurance |
| 09/30/2024 | 800256 | DELTA DENTAL | DENTAL INSURANCE | 54.50 | 100-51420-000-135 | Employee Insurance |
| 09/30/2024 | 800256 | DELTA DENTAL | DENTAL INSURANCE | 43.60 | 100-51510-000-135 | Employee Insurance |
| 09/30/2024 | 800256 | DELTA DENTAL | DENTAL INSURANCE | 85.48 | 100-51600-000-135 | Employee Insurance |
| 09/30/2024 | 800256 | DELTA DENTAL | DENTAL INSURANCE | 3.48 | 100-52400-000-135 | Employee Insurance |
| 09/30/2024 | 800256 | DELTA DENTAL | DENTAL INSURANCE | 34.46 | 100-54600-000-135 | Employee Insurance |
| 09/30/2024 | 800256 | DELTA DENTAL | DENTAL INSURANCE | 163.75 | 100-53311-000-135 | Employee Insurance |
| 09/30/2024 | 800256 | DELTA DENTAL | DENTAL INSURANCE | 33.09 | 100-53635-000-135 | Employee Insurance |
| 09/30/2024 | 800256 | DELTA DENTAL | DENTAL INSURANCE | 8.20 | 100-56700-000-135 | Employee Insurance |
| 09/30/2024 | 800256 | DELTA DENTAL | DENTAL INSURANCE | 19.52 | 100-51430-000-135 | Employee Insurance |
| 09/30/2024 | 800256 | DELTA DENTAL | DENTAL INSURANCE | 133.14 | 100-55200-000-135 | Employee Insurance |
| 09/30/2024 | 800256 | DELTA DENTAL | DENTAL INSURANCE | 584.35 | 100-52200-000-135 | Employee Insurance |
| 09/30/2024 | 800256 | DELTA DENTAL | DENTAL INSURANCE | 102.85 | 100-55202-000-135 | Employee Insurance |
| 09/30/2024 | 800256 | DELTA DENTAL | DENTAL INSURANCE | 120.24 | 100-55350-000-135 | Employee Insurance |
| 09/30/2024 | 800256 | DELTA DENTAL | DENTAL INSURANCE | 72.12 | 100-55300-000-135 | Employee Insurance |
| 09/30/2024 | 800256 | DELTA DENTAL | VISION INSURANCE | 208.95 | 100-21596 | Vision Insurance |
| 09/30/2024 | 800256 | DELTA DENTAL | VISION INSURANCE | 5.92 | 100-14500 | Due from Haass Library |
| 09/30/2024 | 800257 | EFTPS | Federal Taxes | 37,162.51 | 100-21512 | Federal Taxes Withheld |
| 09/30/2024 | 800258 | EMPLOYEE TRUST FUNDS | WI Retirement | 76,637.38 | 100-21511 | WI Retirement Payable |
| 09/30/2024 | 800259 | PAYMENT SERVICE NETWORK-PCARD | Utility Billing Invoice | 406.85 | 610-53700-000-903 | Accounting Supplies & Expenses |
| 09/30/2024 | 800259 | PAYMENT SERVICE NETWORK-PCARD | Utility Billing Invoice | 406.85 | 620-53610-100-310 | Office Supplies |
| 09/30/2024 | 800259 | PAYMENT SERVICE NETWORK-PCARD | Utility Billing Invoice | 406.85 | 640-53650-000-340 | Data Processing Services |
| 09/30/2024 | 800260 | RELIANCE STANDARD LIFE INS CO | LIFE INSURANCE | 81.49 | 100-14500 | Due from Haass Library |
| 09/30/2024 | 800260 | RELIANCE STANDARD LIFE INS CO | LIFE INSURANCE | 1.24 | 280-54910-000-135 | Employee Insurance |
| 09/30/2024 | 800260 | RELIANCE STANDARD LIFE INS CO | LIFE INSURANCE | 85.39 | 610-53700-000-926 | Employee Pension & Benefits |
| 09/30/2024 | 800260 | RELIANCE STANDARD LIFE INS CO | LIFE INSURANCE | 86.76 | 620-53610-100-135 | Employee Insurance |
| 09/30/2024 | 800260 | RELIANCE STANDARD LIFE INS CO | LIFE INSURANCE | 7.09 | 100-51491-000-135 | Employee Insurance |
| 09/30/2024 | 800260 | RELIANCE STANDARD LIFE INS CO | LIFE INSURANCE | 28.07 | 640-53650-000-135 | Employee Insurance |
| 09/30/2024 | 800260 | RELIANCE STANDARD LIFE INS CO | LIFE INSURANCE | 15.52 | 100-51410-000-135 | Employee Insurance |
| 09/30/2024 | 800260 | RELIANCE STANDARD LIFE INS CO | LIFE INSURANCE | 12.43 | 100-51420-000-135 | Employee Insurance |

| Check Issue Date | Check Number | Merchant Name | Description | Amount | Invoice GL Account | Invoice GL Account Title |
|------------------|--------------|-------------------------------|-------------------|----------|--------------------|-----------------------------|
| 09/30/2024 | 800260 | RELIANCE STANDARD LIFE INS CO | LIFE INSURANCE | 12.76 | 100-51510-000-135 | Employee Insurance |
| 09/30/2024 | 800260 | RELIANCE STANDARD LIFE INS CO | LIFE INSURANCE | 35.71 | 100-53311-000-135 | Employee Insurance |
| 09/30/2024 | 800260 | RELIANCE STANDARD LIFE INS CO | LIFE INSURANCE | 6.21 | 100-53635-000-135 | Employee Insurance |
| 09/30/2024 | 800260 | RELIANCE STANDARD LIFE INS CO | LIFE INSURANCE | 4.20 | 100-52400-000-135 | Employee Insurance |
| 09/30/2024 | 800260 | RELIANCE STANDARD LIFE INS CO | LIFE INSURANCE | 15.50 | 100-56700-000-135 | Employee Insurance |
| 09/30/2024 | 800260 | RELIANCE STANDARD LIFE INS CO | LIFE INSURANCE | 13.30 | 100-51430-000-135 | Employee Insurance |
| 09/30/2024 | 800260 | RELIANCE STANDARD LIFE INS CO | LIFE INSURANCE | 17.32 | 100-51600-000-135 | Employee Insurance |
| 09/30/2024 | 800260 | RELIANCE STANDARD LIFE INS CO | LIFE INSURANCE | 38.18 | 100-55200-000-135 | Employee Insurance |
| 09/30/2024 | 800260 | RELIANCE STANDARD LIFE INS CO | LIFE INSURANCE | 15.69 | 100-55202-000-135 | Employee Insurance |
| 09/30/2024 | 800260 | RELIANCE STANDARD LIFE INS CO | LIFE INSURANCE | 126.03 | 100-52200-000-135 | Employee Insurance |
| 09/30/2024 | 800260 | RELIANCE STANDARD LIFE INS CO | LIFE INSURANCE | 5.73 | 100-52100-000-135 | Employee Insurance |
| 09/30/2024 | 800260 | RELIANCE STANDARD LIFE INS CO | LIFE INSURANCE | 2.60 | 100-54600-000-135 | Employee Insurance |
| 09/30/2024 | 800260 | RELIANCE STANDARD LIFE INS CO | LIFE INSURANCE | 9.80 | 100-55350-000-135 | Employee Insurance |
| 09/30/2024 | 800260 | RELIANCE STANDARD LIFE INS CO | LIFE INSURANCE | 8.19 | 100-55300-000-135 | Employee Insurance |
| 09/30/2024 | 800261 | RHYME BUSINESS PRODUCTS | Finance Copier | 52.59 | 100-51420-000-240 | Maint--Equipment |
| 09/30/2024 | 800261 | RHYME BUSINESS PRODUCTS | Finance Copier | 37.56 | 610-53700-000-921 | Office Supplies & Expenses |
| 09/30/2024 | 800261 | RHYME BUSINESS PRODUCTS | Finance Copier | 37.56 | 620-53610-100-310 | Office Supplies |
| 09/30/2024 | 800261 | RHYME BUSINESS PRODUCTS | Finance Copier | 22.54 | 640-53650-000-310 | Office Supplies |
| 09/30/2024 | 800261 | RHYME BUSINESS PRODUCTS | One Stop Copier | 244.23 | 100-51420-000-240 | Maint--Equipment |
| 09/30/2024 | 800261 | RHYME BUSINESS PRODUCTS | 3rd Floor copier | 164.14 | 100-51491-000-390 | Expenses |
| 09/30/2024 | 800261 | RHYME BUSINESS PRODUCTS | One Stop Copier | 211.40 | 100-55300-000-310 | Office Supplies |
| 09/30/2024 | 800261 | RHYME BUSINESS PRODUCTS | 3rd Floor copier | 98.49 | 100-52400-000-390 | Expenses |
| 09/30/2024 | 800261 | RHYME BUSINESS PRODUCTS | 3rd Floor copier | 32.83 | 100-53311-000-240 | Maint--Equipment |
| 09/30/2024 | 800261 | RHYME BUSINESS PRODUCTS | PSB/Fire copier | 109.47 | 100-52200-000-345 | Supplies |
| 09/30/2024 | 800261 | RHYME BUSINESS PRODUCTS | PSB/Police copier | 268.26 | 100-52100-000-390 | Expenses |
| 09/30/2024 | 800262 | UNITED HEALTHCARE | HEALTH INSURANCE | 133.01 | 280-54910-000-135 | Employee Insurance |
| 09/30/2024 | 800262 | UNITED HEALTHCARE | HEALTH INSURANCE | 2,574.42 | 100-14500 | Due from Haass Library |
| 09/30/2024 | 800262 | UNITED HEALTHCARE | HEALTH INSURANCE | 5,586.50 | 610-53700-000-926 | Employee Pension & Benefits |
| 09/30/2024 | 800262 | UNITED HEALTHCARE | HEALTH INSURANCE | 5,568.48 | 620-53610-100-135 | Employee Insurance |
| 09/30/2024 | 800262 | UNITED HEALTHCARE | HEALTH INSURANCE | 703.68 | 100-51491-000-135 | Employee Insurance |
| 09/30/2024 | 800262 | UNITED HEALTHCARE | HEALTH INSURANCE | 2,394.21 | 640-53650-000-135 | Employee Insurance |
| 09/30/2024 | 800262 | UNITED HEALTHCARE | HEALTH INSURANCE | 1,330.12 | 100-51420-000-135 | Employee Insurance |
| 09/30/2024 | 800262 | UNITED HEALTHCARE | HEALTH INSURANCE | 486.57 | 100-51430-000-135 | Employee Insurance |
| 09/30/2024 | 800262 | UNITED HEALTHCARE | HEALTH INSURANCE | 1,064.10 | 100-51510-000-135 | Employee Insurance |
| 09/30/2024 | 800262 | UNITED HEALTHCARE | HEALTH INSURANCE | 2,879.06 | 100-51600-000-135 | Employee Insurance |
| 09/30/2024 | 800262 | UNITED HEALTHCARE | HEALTH INSURANCE | 2,661.10 | 100-53311-000-135 | Employee Insurance |
| 09/30/2024 | 800262 | UNITED HEALTHCARE | HEALTH INSURANCE | 562.08 | 100-53635-000-135 | Employee Insurance |
| 09/30/2024 | 800262 | UNITED HEALTHCARE | HEALTH INSURANCE | 257.44 | 100-52400-000-135 | Employee Insurance |
| 09/30/2024 | 800262 | UNITED HEALTHCARE | HEALTH INSURANCE | 1,724.86 | 100-56700-000-135 | Employee Insurance |
| 09/30/2024 | 800262 | UNITED HEALTHCARE | HEALTH INSURANCE | 2,711.72 | 100-55200-000-135 | Employee Insurance |

| Check Issue Date | Check Number | Merchant Name | Description | Amount | Invoice GL Account | Invoice GL Account Title |
|------------------|--------------|--------------------------|------------------------------|-----------|--------------------|----------------------------|
| 09/30/2024 | 800262 | UNITED HEALTHCARE | HEALTH INSURANCE | 14,588.38 | 100-52200-000-135 | Employee Insurance |
| 09/30/2024 | 800262 | UNITED HEALTHCARE | HEALTH INSURANCE | 429.07 | 100-54600-000-135 | Employee Insurance |
| 09/30/2024 | 800262 | UNITED HEALTHCARE | HEALTH INSURANCE | 2,504.05 | 100-55202-000-135 | Employee Insurance |
| 09/30/2024 | 800262 | UNITED HEALTHCARE | HEALTH INSURANCE | 2,316.98 | 100-55350-000-135 | Employee Insurance |
| 09/30/2024 | 800262 | UNITED HEALTHCARE | HEALTH INSURANCE | 1,527.49 | 100-55300-000-135 | Employee Insurance |
| 09/30/2024 | 800262 | UNITED HEALTHCARE | HEALTH INSURANCE | 858.14 | 100-13800 | Other Receivables |
| 09/30/2024 | 800263 | WE ENERGIES | Fire electric | 1,297.48 | 100-52200-000-224 | Utilities--Electric |
| 09/30/2024 | 800263 | WE ENERGIES | Civic Center electric | 6,147.86 | 100-51600-000-224 | Utilities--Electric |
| 09/30/2024 | 800263 | WE ENERGIES | Civic Center heat | 417.48 | 100-51600-000-222 | Utilities--Heat |
| 09/30/2024 | 800263 | WE ENERGIES | Lions club meter | 15.23 | 100-55200-000-224 | Utilities--Electric |
| 09/30/2024 | 800263 | WE ENERGIES | The Grove electric | 1,493.31 | 100-55200-000-224 | Utilities--Electric |
| 09/30/2024 | 800263 | WE ENERGIES | The Grove gas | 31.33 | 100-55200-000-222 | Utilities--Heat |
| 09/30/2024 | 800263 | WE ENERGIES | Parks Electric | 2,056.34 | 100-55200-000-224 | Utilities--Electric |
| 09/30/2024 | 800263 | WE ENERGIES | Parks gas | 19.80 | 100-55200-000-222 | Utilities--Heat |
| 09/30/2024 | 800263 | WE ENERGIES | Sewer collection electric | 437.28 | 620-53610-200-224 | Utilities--Electric |
| 09/30/2024 | 800263 | WE ENERGIES | Sewer treatment gas | 13.75 | 620-53610-300-222 | Utilities--Heat |
| 09/30/2024 | 800263 | WE ENERGIES | Sewer collection gas | 424.03 | 620-53610-200-222 | Utilities--Heat |
| 09/30/2024 | 800263 | WE ENERGIES | Sewer treatment electric | 18,046.21 | 620-53610-300-224 | Utilities--Electric |
| 09/30/2024 | 800263 | WE ENERGIES | Storm electric | 921.28 | 640-53650-000-224 | Utilities--Electric |
| 09/30/2024 | 800263 | WE ENERGIES | Traffic signals | 166.66 | 100-53311-000-224 | Utilities--Electric |
| 09/30/2024 | 800263 | WE ENERGIES | Emergency Govt electric | 74.94 | 100-52900-000-001 | Emergency Government |
| 09/30/2024 | 800263 | WE ENERGIES | Police electric | 950.28 | 100-52100-000-224 | Utilities--Electric |
| 09/30/2024 | 800263 | WE ENERGIES | Garage electric | 238.80 | 100-53311-000-224 | Utilities--Electric |
| 09/30/2024 | 800263 | WE ENERGIES | Garage electric | 117.06 | 100-55200-000-224 | Utilities--Electric |
| 09/30/2024 | 800263 | WE ENERGIES | Garage electric | 37.46 | 610-53700-000-921 | Office Supplies & Expenses |
| 09/30/2024 | 800263 | WE ENERGIES | Garage electric | 37.46 | 620-53610-100-224 | Utilities--Electric |
| 09/30/2024 | 800263 | WE ENERGIES | Garage electric | 37.46 | 640-53650-000-224 | Utilities--Electric |
| 09/30/2024 | 800263 | WE ENERGIES | Garage gas | 14.68 | 100-53311-000-222 | Utilities--Heat |
| 09/30/2024 | 800263 | WE ENERGIES | Garage gas | 7.20 | 100-55200-000-222 | Utilities--Heat |
| 09/30/2024 | 800263 | WE ENERGIES | Garage gas | 2.30 | 610-53700-000-921 | Office Supplies & Expenses |
| 09/30/2024 | 800263 | WE ENERGIES | Garage gas | 2.30 | 620-53610-100-222 | Utilities--Heat |
| 09/30/2024 | 800263 | WE ENERGIES | Garage gas | 2.30 | 640-53650-000-222 | Utilities--Heat |
| 09/30/2024 | 800263 | WE ENERGIES | Sewer other govt electric | 18.32 | 620-110-46412 | Sewer--Other Governments |
| 09/30/2024 | 800264 | WI DEPARTMENT OF REVENUE | Monthly Sales taxes - August | 102.50 | 100-51490-000-390 | Expenses |
| 09/30/2024 | 800264 | WI DEPARTMENT OF REVENUE | Monthly Sales taxes - August | 112.75 | 100-55300-000-390 | Expenses |
| 09/30/2024 | 800264 | WI DEPARTMENT OF REVENUE | Monthly Sales taxes - August | 96.24 | 100-54600-000-899 | Sales Tax Remitted |
| 09/30/2024 | 800264 | WI DEPARTMENT OF REVENUE | Monthly Sales taxes - August | 190.94 | 100-55202-000-403 | Special Events |
| 09/30/2024 | 800264 | WI DEPARTMENT OF REVENUE | Monthly Sales taxes - August | 301.23 | 100-55350-000-899 | Sales Tax Remitted |
| 09/30/2024 | 800264 | WI DEPARTMENT OF REVENUE | Monthly Sales taxes - August | 1,963.45 | 100-21101 | Sales Tax Payable |
| 09/30/2024 | 800264 | WI DEPARTMENT OF REVENUE | Monthly Sales taxes - July | 83.90 | 100-51490-000-390 | Expenses |

| Check Issue Date | Check Number | Merchant Name | Description | Amount | Invoice GL Account | Invoice GL Account Title |
|------------------|--------------|---------------------------|----------------------------|-------------------|--------------------|--------------------------|
| 09/30/2024 | 800264 | WI DEPARTMENT OF REVENUE | Monthly Sales taxes - July | 5.53 | 100-55300-000-390 | Expenses |
| 09/30/2024 | 800264 | WI DEPARTMENT OF REVENUE | Monthly Sales taxes - July | 4.40 | 100-54600-000-899 | Sales Tax Remitted |
| 09/30/2024 | 800264 | WI DEPARTMENT OF REVENUE | Monthly Sales taxes - July | 13.54 | 100-55202-000-403 | Special Events |
| 09/30/2024 | 800264 | WI DEPARTMENT OF REVENUE | Monthly Sales taxes - July | 15.06 | 100-55350-000-899 | Sales Tax Remitted |
| 09/30/2024 | 800264 | WI DEPARTMENT OF REVENUE | Monthly Sales taxes - July | 527.15 | 100-21101 | Sales Tax Payable |
| 09/30/2024 | 800264 | WI DEPARTMENT OF REVENUE | State Taxes | 6,075.31 | 100-21513 | State Taxes Withheld |
| 09/30/2024 | 800264 | WI DEPARTMENT OF REVENUE | State Taxes | 543.84 | 100-21513 | State Taxes Withheld |
| 09/30/2024 | 800265 | WI DEPT. OF TRANSP. TV&RP | Suspensions | 3.00 | 100-000-45110 | Fines & Tickets |
| Grand Totals: | | | | <u>788,078.15</u> | | |

| Posting Date | Merchant Name | Transaction Amount | Name |
|--------------|---------------------------|--------------------|--------------------|
| 8/13/2024 | AMAZON MKTPL*RM38B8KC0 | \$14.99 | CHARLOTTE ABT |
| 8/15/2024 | WALGREENS #7731 | \$14.14 | CHARLOTTE ABT |
| 8/15/2024 | COUSINSSUBS | \$163.22 | CHARLOTTE ABT |
| 8/16/2024 | AMAZON MKTPL*RU4WZ4E52 | \$39.96 | CHARLOTTE ABT |
| 8/19/2024 | AMAZON MKTPL*RU3NJ4JF0 | \$21.98 | CHARLOTTE ABT |
| 8/19/2024 | WALMART.COM | \$27.30 | CHARLOTTE ABT |
| 8/30/2024 | AMAZON MKTPLACE PMTS | (\$27.14) | CHARLOTTE ABT |
| 8/30/2024 | AMAZON MKTPLACE PMTS | (\$27.14) | CHARLOTTE ABT |
| 9/5/2024 | WEISSMAN'S THEATRICAL SU | \$119.50 | CHARLOTTE ABT |
| 9/9/2024 | AMAZON MARK* ZT951QM1 | \$27.99 | CHARLOTTE ABT |
| 8/13/2024 | FEDEX OFFIC67200006726 | \$99.99 | JENNIFER BAHNAMAN |
| 8/13/2024 | SQ *LOCA LATTE | \$60.00 | JENNIFER BAHNAMAN |
| 8/13/2024 | CULVERS OF SUSSEX | \$60.00 | JENNIFER BAHNAMAN |
| 8/14/2024 | KWIK TRIP #1124 | \$20.00 | JENNIFER BAHNAMAN |
| 8/21/2024 | AMAZON MKTPL*R46RA5152 | \$9.99 | JENNIFER BAHNAMAN |
| 8/27/2024 | AMAZON MARK* R42UD42N1 | \$31.99 | JENNIFER BAHNAMAN |
| 8/28/2024 | AMZN MKTP US*RK4V58X22 | \$20.09 | JENNIFER BAHNAMAN |
| 8/29/2024 | AMAZON MARK* RK6AA0O20 | \$9.99 | JENNIFER BAHNAMAN |
| 8/29/2024 | AMAZON MKTPL*RK4UA7O70 | \$8.95 | JENNIFER BAHNAMAN |
| 9/2/2024 | AMZN MKTP US | (\$13.66) | JENNIFER BAHNAMAN |
| 9/5/2024 | CONLEY PUBLISHING GROUP | \$270.00 | JENNIFER BAHNAMAN |
| 8/14/2024 | DSPS E SERVICE FEE COM | \$5.40 | JONATHAN S BAUMANN |
| 8/14/2024 | DSPS EPAY ISE | \$240.00 | JONATHAN S BAUMANN |
| 8/15/2024 | AMAZON MKTPL*RM9VL9IX1 | \$27.97 | JONATHAN S BAUMANN |
| 8/19/2024 | TST*RUMORS SPORTS BAR & | \$94.65 | JONATHAN S BAUMANN |
| 8/19/2024 | AMAZON MKTPLACE PMTS | (\$19.99) | JONATHAN S BAUMANN |
| 8/19/2024 | AMAZON MKTPL*RU7370I02 | \$24.79 | JONATHAN S BAUMANN |
| 8/22/2024 | PRO INDUSTRIAL CONTROLS | \$34.71 | JONATHAN S BAUMANN |
| 8/28/2024 | WISCONSIN WASTEWATER OPER | \$30.00 | JONATHAN S BAUMANN |
| 9/3/2024 | AMAZON MARK* ZT7027JU2 | \$18.98 | JONATHAN S BAUMANN |
| 8/14/2024 | WISCONSIN WASTEWATER OPER | \$480.00 | DUSTIN BECKMAN |
| 8/15/2024 | WISCONSIN WASTEWATER OPER | \$30.00 | DUSTIN BECKMAN |
| 8/15/2024 | WISCONSIN WASTEWATER OPER | \$30.00 | DUSTIN BECKMAN |
| 9/10/2024 | DNR WS2 EM1 EPAY DEM SRVF | \$0.90 | DUSTIN BECKMAN |
| 9/10/2024 | DNR WS2 EM1 EPAY DEM SALE | \$45.00 | DUSTIN BECKMAN |
| 8/15/2024 | POOL SUPPLY UNLIMITED | \$177.57 | THOMAS A BERRES |
| 8/15/2024 | AMAZON.COM*RM1OO0IE1 | \$18.69 | THOMAS A BERRES |
| 8/21/2024 | AMAZON MKTPL*R46CS40F2 | \$109.95 | THOMAS A BERRES |
| 8/21/2024 | UWCC REGISTRATIONS | \$370.00 | THOMAS A BERRES |
| 8/22/2024 | AMAZON MARK* R47VG7OV0 | \$74.99 | THOMAS A BERRES |
| 9/3/2024 | AMAZON MARK* RK9632UC0 | \$129.80 | THOMAS A BERRES |
| 9/4/2024 | BLACKBURN MANUFACTURING | \$150.97 | THOMAS A BERRES |
| 9/4/2024 | AMAZON MARK* ZT6I91MD2 | \$38.94 | THOMAS A BERRES |
| 9/9/2024 | CENTRAL LANDSCAPE SUPPLY | \$183.00 | THOMAS A BERRES |
| 8/26/2024 | BAKER & TAYLOR - BOOKS | \$1,752.42 | PHPL BOOKS |
| 8/26/2024 | BAKER & TAYLOR - BOOKS | \$696.01 | PHPL BOOKS |
| 8/26/2024 | BAKER & TAYLOR - BOOKS | \$2,153.63 | PHPL BOOKS |
| 8/26/2024 | BAKER & TAYLOR - BOOKS | \$2,513.62 | PHPL BOOKS |
| 8/26/2024 | BAKER & TAYLOR - BOOKS | \$3,054.74 | PHPL BOOKS |
| 8/26/2024 | BAKER & TAYLOR - BOOKS | \$261.94 | PHPL BOOKS |
| 8/26/2024 | BAKER & TAYLOR - BOOKS | \$914.83 | PHPL BOOKS |

| Posting Date | Merchant Name | Transaction Amount | Name |
|--------------|---------------------------|--------------------|--------------------|
| 8/26/2024 | AMAZON MARK* R422H6Q80 | \$28.01 | HALIE DOBBECK |
| 8/16/2024 | TARGET 00008649 | \$80.00 | TERESA DOUGLAS |
| 8/16/2024 | SHADY LANE GREENHOUSES | \$20.00 | TERESA DOUGLAS |
| 8/16/2024 | SALS PIZZA SUSSEX | \$20.90 | TERESA DOUGLAS |
| 8/19/2024 | BARNES & NOBLE #2213 | \$60.00 | TERESA DOUGLAS |
| 8/19/2024 | BOOKS & COMPANY | \$20.00 | TERESA DOUGLAS |
| 8/19/2024 | AMAZON MKTPL*RU25D4502 | \$72.99 | TERESA DOUGLAS |
| 8/19/2024 | AMAZON MKTPL*RU8FL15H2 | \$38.97 | TERESA DOUGLAS |
| 8/19/2024 | AMAZON MKTPL*RU8PD9181 | \$29.65 | TERESA DOUGLAS |
| 8/19/2024 | AMAZON MKTPL*RU23G1111 | \$12.99 | TERESA DOUGLAS |
| 8/19/2024 | AMAZON MKTPL*RU8UO1XK0 | \$31.17 | TERESA DOUGLAS |
| 8/19/2024 | AMAZON MKTPL*RU2HB5VR1 | \$35.04 | TERESA DOUGLAS |
| 8/26/2024 | PAYPAL *SEEDLINGSBR | \$76.75 | TERESA DOUGLAS |
| 9/6/2024 | AMAZON MKTPL*ZT5EJ3622 | \$149.76 | TERESA DOUGLAS |
| 9/9/2024 | AMAZON MKTPL*Z83XK6FA2 | \$22.98 | TERESA DOUGLAS |
| 8/27/2024 | THE HOME DEPOT #4940 | \$48.05 | MARK EESLEY |
| 9/5/2024 | PAYROLLORG | \$299.00 | DONNA M EVERS |
| 8/15/2024 | WCTC MARKETPLACE | \$80.00 | KRISTOPHER GROD |
| 8/21/2024 | NORTHWEST RIVER SUPPLIES | \$1,255.50 | KRISTOPHER GROD |
| 8/23/2024 | MENARDS PEWAUKEE WI | \$119.94 | KRISTOPHER GROD |
| 8/23/2024 | RESCUEDIRECT | \$251.07 | KRISTOPHER GROD |
| 8/26/2024 | THE HOME DEPOT #4940 | \$220.30 | KRISTOPHER GROD |
| 9/3/2024 | CLAREY'S SAFETY EQUIPMENT | \$280.00 | KRISTOPHER GROD |
| 8/30/2024 | L&R LAWN EQUIPMENT & REP | \$101.97 | KRISTOPHER GROD |
| 9/2/2024 | BIG JIMS SMALL ENGINE SER | \$118.78 | KRISTOPHER GROD |
| 9/6/2024 | SQ *WISCONSIN FIRE CHIEFS | \$225.00 | KRISTOPHER GROD |
| 8/14/2024 | AMAZON.COM*RM64E99H0 | \$52.30 | ERIK LEITZKE |
| 8/14/2024 | AMAZON.COM*RM8F50UQ0 | \$90.80 | ERIK LEITZKE |
| 8/19/2024 | AMAZON MKTPL*RU5QIOGI0 | \$15.28 | ERIK LEITZKE |
| 8/28/2024 | AMAZON.COM*RK6UF4CP0 | \$19.98 | ERIK LEITZKE |
| 8/30/2024 | AMAZON.COM | (\$45.40) | ERIK LEITZKE |
| 9/2/2024 | AMAZON RETA* RK0HP4YW2 | \$99.90 | ERIK LEITZKE |
| 8/23/2024 | AMAZON MKTPL*R45HT3LS1 | \$6.54 | CHRIS LIEDTKE |
| 8/29/2024 | AMAZON MKTPL*RK1FL2892 | \$44.19 | ADELE M LORIA |
| 8/29/2024 | AMAZON.COM*RK5OE3OP1 | \$16.99 | ADELE M LORIA |
| 8/30/2024 | AMZN MKTP US*RK28463R1 | \$8.20 | ADELE M LORIA |
| 8/30/2024 | AMAZON RETA* RK2PL3EJ1 | \$13.29 | ADELE M LORIA |
| 9/2/2024 | AMAZON MARK* RK6TZ7UW2 | \$17.31 | ADELE M LORIA |
| 9/2/2024 | ULINE *SHIP SUPPLIES | \$649.78 | ADELE M LORIA |
| 9/2/2024 | AMAZON RETA* RK2NC9ST1 | \$75.71 | ADELE M LORIA |
| 9/4/2024 | AMAZON MKTPL*PLACE PMTS | (\$22.69) | ADELE M LORIA |
| 8/29/2024 | TEST EQUIPMENT DEPOT | \$2,531.00 | K MCELROY ANDERSON |
| 8/26/2024 | TRIMBLE INC | \$366.45 | K MCELROY ANDERSON |
| 8/13/2024 | THE BUSINESS JOURNALS | \$200.00 | SANDRA A MEYER |
| 8/15/2024 | SJ ELECTRO SYSTEMS, LLC | \$4,247.13 | SANDRA A MEYER |
| 8/15/2024 | ATT* BILL PAYMENT | \$643.45 | SANDRA A MEYER |
| 8/15/2024 | NORTHERN LAKE SERVICE- IN | \$137.50 | SANDRA A MEYER |
| 8/15/2024 | SPECTRUM | \$149.99 | SANDRA A MEYER |
| 8/15/2024 | SPECTRUM | \$107.44 | SANDRA A MEYER |
| 8/15/2024 | SPECTRUM | \$1,436.94 | SANDRA A MEYER |
| 8/15/2024 | SPECTRUM | \$129.99 | SANDRA A MEYER |
| 8/15/2024 | SPECTRUM | \$149.98 | SANDRA A MEYER |
| 8/15/2024 | EUROFINS SF ANALYTICAL LA | \$904.65 | SANDRA A MEYER |
| 8/15/2024 | WMH RETAIL PHARMACY | \$18.45 | SANDRA A MEYER |
| 8/15/2024 | COMMUNITY HOSP GENERAL | \$22.26 | SANDRA A MEYER |
| 8/15/2024 | TAPCO | \$73.50 | SANDRA A MEYER |
| 8/16/2024 | SALAMONE SUPPLIES | \$78.41 | SANDRA A MEYER |

| Posting Date | Merchant Name | Transaction Amount | Name |
|--------------|---------------------------|--------------------|------------------|
| 8/16/2024 | MID-AMERICAN RESEARCH CHE | \$178.91 | SANDRA A MEYER |
| 8/16/2024 | SERVICE SANITATION WI | \$2,110.00 | SANDRA A MEYER |
| 8/16/2024 | AT&T PAYMENT | \$612.53 | SANDRA A MEYER |
| 8/19/2024 | MENARDS PEWAUKEE WI | \$166.92 | SANDRA A MEYER |
| 8/22/2024 | SUPERIOR CHEMICAL LLC | \$177.04 | SANDRA A MEYER |
| 8/22/2024 | BROOKS TRACTOR SUN PRAIRI | \$1,400.00 | SANDRA A MEYER |
| 8/22/2024 | JONES LAKE MANAGEMENT | \$543.75 | SANDRA A MEYER |
| 8/22/2024 | PORT-A-JOHN -CLV | \$90.00 | SANDRA A MEYER |
| 8/22/2024 | PORT-A-JOHN -CLV | \$100.00 | SANDRA A MEYER |
| 8/22/2024 | SPECTRUM | \$14.77 | SANDRA A MEYER |
| 8/22/2024 | IN *BUSINESS TELEPHONE & | \$390.00 | SANDRA A MEYER |
| 8/22/2024 | IN *TALLGRASS RESTORATION | \$1,570.00 | SANDRA A MEYER |
| 8/22/2024 | EUROFINS SF ANALYTICAL LA | \$76.28 | SANDRA A MEYER |
| 8/22/2024 | USABLUBOOK | \$145.67 | SANDRA A MEYER |
| 8/23/2024 | SALAMONE SUPPLIES | \$319.98 | SANDRA A MEYER |
| 8/23/2024 | MILLER BRADFORD RISBERG | \$4,196.45 | SANDRA A MEYER |
| 8/23/2024 | SERVICE SANITATION WI | \$844.60 | SANDRA A MEYER |
| 8/23/2024 | NORTHERN LAKE SERVICE- IN | \$137.50 | SANDRA A MEYER |
| 8/23/2024 | SQ *THOMAS PRESS INC. | \$267.50 | SANDRA A MEYER |
| 8/26/2024 | SALAMONE SUPPLIES | \$151.35 | SANDRA A MEYER |
| 8/26/2024 | CAVENDISHSQ | \$119.61 | SANDRA A MEYER |
| 8/26/2024 | DEMCO | \$457.08 | SANDRA A MEYER |
| 8/28/2024 | ATT* BILL PAYMENT | \$470.29 | SANDRA A MEYER |
| 8/28/2024 | JAMES IMAGING | \$250.91 | SANDRA A MEYER |
| 8/29/2024 | NORTHERN LAKE SERVICE- IN | \$137.50 | SANDRA A MEYER |
| 8/29/2024 | EUROFINS SF ANALYTICAL LA | \$591.56 | SANDRA A MEYER |
| 8/29/2024 | SHERWIN WILLIAMS 703224 | \$87.46 | SANDRA A MEYER |
| 8/30/2024 | MENARDS PEWAUKEE WI | \$444.97 | SANDRA A MEYER |
| 9/3/2024 | TYCOINTEGRATEDSECURITY | \$84.41 | SANDRA A MEYER |
| 9/3/2024 | TYCOINTEGRATEDSECURITY | \$180.04 | SANDRA A MEYER |
| 9/3/2024 | TYCOINTEGRATEDSECURITY | \$106.25 | SANDRA A MEYER |
| 9/3/2024 | TYCOINTEGRATEDSECURITY | \$136.98 | SANDRA A MEYER |
| 9/6/2024 | LAKESHORE RECYCLING SYST | \$50,120.00 | SANDRA A MEYER |
| 9/6/2024 | R A SMITH NATIONAL INC | \$11,644.17 | SANDRA A MEYER |
| 9/6/2024 | ATT* BILL PAYMENT | \$253.02 | SANDRA A MEYER |
| 9/6/2024 | CINTAS CORP | \$1,518.31 | SANDRA A MEYER |
| 9/6/2024 | CINTAS CORP | \$155.92 | SANDRA A MEYER |
| 9/6/2024 | PY *DAVE JONES, LLC | \$185.00 | SANDRA A MEYER |
| 9/6/2024 | PY *DAVE JONES, LLC | \$2,175.00 | SANDRA A MEYER |
| 9/6/2024 | PY *DAVE JONES, LLC | \$185.00 | SANDRA A MEYER |
| 9/6/2024 | PY *DAVE JONES, LLC | \$295.00 | SANDRA A MEYER |
| 9/6/2024 | PY *DAVE JONES, LLC | \$220.00 | SANDRA A MEYER |
| 9/6/2024 | PY *DAVE JONES, LLC | \$452.00 | SANDRA A MEYER |
| 9/6/2024 | PY *DAVE JONES, LLC | \$220.00 | SANDRA A MEYER |
| 9/6/2024 | PY *DAVE JONES, LLC | \$296.00 | SANDRA A MEYER |
| 9/6/2024 | PY *DAVE JONES, LLC | \$185.00 | SANDRA A MEYER |
| 9/6/2024 | PY *DAVE JONES, LLC | \$219.00 | SANDRA A MEYER |
| 9/6/2024 | OFFICEVIBE | \$71.72 | SANDRA A MEYER |
| 9/9/2024 | MILLER BRADFORD RISBERG | \$12,635.00 | SANDRA A MEYER |
| 9/9/2024 | MENARDS PEWAUKEE WI | \$612.02 | SANDRA A MEYER |
| 9/9/2024 | BADGER METER INC | \$275.73 | SANDRA A MEYER |
| 9/9/2024 | A/E GRAPHICS, INC. | \$45.74 | SANDRA A MEYER |
| 9/9/2024 | SALAMONE SUPPLIES | \$38.34 | SANDRA A MEYER |
| 9/9/2024 | DORNER PRODUCTS, LLC | \$4,333.00 | SANDRA A MEYER |
| 9/9/2024 | MAD SCIENCE OF MILWAUK | \$2,673.00 | SANDRA A MEYER |
| 8/14/2024 | COSTCO WHSE #1101 | \$208.93 | JENNIFER A MOORE |
| 8/15/2024 | KWIK TRIP #1299 | \$44.93 | JENNIFER A MOORE |

| Posting Date | Merchant Name | Transaction Amount | Name |
|--------------|---------------------------|--------------------|---------------------|
| 8/16/2024 | AMZN MKTP US*RU3HM11E2 | \$23.74 | JENNIFER A MOORE |
| 8/20/2024 | AMAZON MKTPL*RU9YX9QQ1 | \$65.09 | JENNIFER A MOORE |
| 8/22/2024 | AMAZON MKTPL*R47B595R2 | \$30.99 | JENNIFER A MOORE |
| 8/30/2024 | MARRIOTT MADISON WEST | \$239.00 | JENNIFER A MOORE |
| 9/2/2024 | MARRIOTT MADISON WEST | \$393.00 | JENNIFER A MOORE |
| 9/2/2024 | MARRIOTT MADISON WEST | \$262.00 | JENNIFER A MOORE |
| 9/9/2024 | ODP BUS SOL LLC# 106869 | \$516.55 | JENNIFER A MOORE |
| 9/10/2024 | WI DFI WS2 CFI CC EPAY | \$25.00 | JENNIFER A MOORE |
| 8/16/2024 | CANVA* 04244-60590653 | \$15.00 | LORI NISWONGER |
| 8/29/2024 | SONIC WALL | \$437.01 | LORI NISWONGER |
| 8/13/2024 | AMAZON MKTPL*RM9AZ1DY1 | \$12.09 | ANNA OLESZCZAK |
| 8/14/2024 | AMAZON.COM*RM8CO4W92 | \$142.78 | ANNA OLESZCZAK |
| 8/16/2024 | AMAZON RETA* RU6Z50PT2 | \$4.99 | ANNA OLESZCZAK |
| 8/19/2024 | AMAZON.COM*RU1I01QC2 | \$5.00 | ANNA OLESZCZAK |
| 8/19/2024 | AMAZON RETA* RU6AB7QN1 | \$23.17 | ANNA OLESZCZAK |
| 8/20/2024 | AMAZON.COM*R47CM9FH2 | \$24.65 | ANNA OLESZCZAK |
| 8/20/2024 | AMAZON.COM*RU7N96HU0 | \$24.03 | ANNA OLESZCZAK |
| 8/27/2024 | AMAZON.COM*R43L00K20 | \$49.98 | ANNA OLESZCZAK |
| 8/27/2024 | AMAZON RETA* R48PK6UU1 | \$31.90 | ANNA OLESZCZAK |
| 8/28/2024 | AMAZON RETA* RK7VL6PL2 | \$13.79 | ANNA OLESZCZAK |
| 8/29/2024 | AMAZON.COM*RK5605BN2 | \$49.98 | ANNA OLESZCZAK |
| 9/3/2024 | AMAZON.COM*RK0BA9K50 | \$20.99 | ANNA OLESZCZAK |
| 9/4/2024 | AMAZON.COM*ZT5UD1LL1 | \$9.49 | ANNA OLESZCZAK |
| 9/9/2024 | AMAZON.COM*ZT3A23RQ0 | \$19.99 | ANNA OLESZCZAK |
| 9/10/2024 | AMAZON.COM*ZT6BW5RB1 | \$10.79 | ANNA OLESZCZAK |
| 8/19/2024 | AMAZON MKTPL*RU4KD1RN2 | \$113.99 | CHRISTOPHER PERALTA |
| 8/20/2024 | AMAZON.COM | (\$129.00) | CHRISTOPHER PERALTA |
| 8/21/2024 | AMAZON MKTPLACE PMTS | (\$113.99) | CHRISTOPHER PERALTA |
| 8/21/2024 | AMAZON.COM*R433J6AS2 | \$25.19 | CHRISTOPHER PERALTA |
| 8/27/2024 | BELL-WELL SALES CO | \$717.75 | DAN PLESE |
| 9/9/2024 | BELL-WELL SALES CO | \$133.25 | DAN PLESE |
| 8/23/2024 | AMAZON RETA* R495Y56D2 | \$53.28 | LISA PONTO |
| 8/26/2024 | AMAZON RETA* R42EW83V0 | \$35.98 | LISA PONTO |
| 9/9/2024 | AMAZON MKTPL*Z80UD5LA2 | \$44.23 | LISA PONTO |
| 9/10/2024 | AMZN MKTP US*ZT8CL3UY1 | \$11.80 | LISA PONTO |
| 8/13/2024 | AMAZON MKTPL*RM1DY26T0 | \$15.99 | REC PROGRAMS |
| 8/13/2024 | AMAZON MKTPL*RM2BZ46G0 | \$154.32 | REC PROGRAMS |
| 8/13/2024 | AMAZON MKTPL*RM38727X0 | \$63.95 | REC PROGRAMS |
| 8/14/2024 | AMAZON MKTPL*RM8Y90UP0 | \$119.45 | REC PROGRAMS |
| 8/14/2024 | AMAZON MKTPL*RM5R10KE1 | \$34.95 | REC PROGRAMS |
| 8/14/2024 | AMAZON.COM*RM13N2IN0 | \$31.49 | REC PROGRAMS |
| 8/14/2024 | AMAZON MKTPL*RM4T90WT0 | \$15.98 | REC PROGRAMS |
| 8/15/2024 | AMAZON.COM*RM74A9WY1 | \$9.49 | REC PROGRAMS |
| 8/15/2024 | AMAZON MKTPL*RM7FK9I01 | \$282.11 | REC PROGRAMS |
| 8/15/2024 | AMAZON MKTPL*RM7NI6YV1 | \$78.99 | REC PROGRAMS |
| 8/16/2024 | AMAZON.COM*RU8623EV2 | \$60.97 | REC PROGRAMS |
| 8/16/2024 | AMAZON MKTPL*RU1IG9O21 | \$25.99 | REC PROGRAMS |
| 8/16/2024 | AMAZON.COM*RU0T16FM1 | \$11.32 | REC PROGRAMS |
| 8/27/2024 | CITY OF WAUKESHA PARKS RE | (\$50.00) | REC PROGRAMS |
| 9/9/2024 | AMAZON MARK* ZT1LJ5QW1 | \$17.96 | REC PROGRAMS |
| 8/14/2024 | AMAZON RETA* RU73R8442 | \$33.14 | ANNE PULVERMACHER |
| 8/15/2024 | AMAZON MKTPL*RM7M59IK1 | \$43.98 | ANNE PULVERMACHER |
| 8/15/2024 | MILWAUKEE JOURNAL | \$19.99 | ANNE PULVERMACHER |
| 8/16/2024 | AMAZON MKTPL*RU0Z85FJ1 | \$47.04 | ANNE PULVERMACHER |
| 8/20/2024 | AMAZON MKTPLACE PMTS | (\$43.98) | ANNE PULVERMACHER |
| 8/22/2024 | ICMA ONLINE | \$450.00 | ANNE PULVERMACHER |
| 8/23/2024 | AMAZON.COM*R49UL86A2 | \$117.95 | ANNE PULVERMACHER |

| Posting Date | Merchant Name | Transaction Amount | Name |
|--------------|---------------------------|---------------------|-------------------|
| 8/30/2024 | AMZN MKTP US*RK2KJ3A50 | \$51.88 | ANNE PULVERMACHER |
| 9/2/2024 | AMZN MKTP US*RK79R09N2 | \$129.99 | ANNE PULVERMACHER |
| 9/4/2024 | AMAZON MKTPL*RK7ZD7Y80 | \$125.99 | ANNE PULVERMACHER |
| 9/4/2024 | AMAZON MARK* ZT4PQ3LI1 | \$69.98 | ANNE PULVERMACHER |
| 9/6/2024 | JIMMY JOHNS 738 - ECOM | \$72.19 | ANNE PULVERMACHER |
| 9/9/2024 | AMAZON MARK* ZT2MJ9YM0 | \$37.28 | ANNE PULVERMACHER |
| 8/26/2024 | COMPLETE OFFICE OF WISCON | \$40.62 | BRENDA TENNYSON |
| 8/28/2024 | AMAZON.COM*R43238RW0 | \$127.32 | BRENDA TENNYSON |
| 8/29/2024 | SAMSCLUB.COM | \$56.90 | BRENDA TENNYSON |
| 8/29/2024 | COMPLETE OFFICE OF WISCON | \$265.46 | BRENDA TENNYSON |
| 8/30/2024 | AMAZON RETA* RK4JZ8AV1 | \$72.74 | BRENDA TENNYSON |
| 9/2/2024 | SAMSCLUB.COM | \$79.92 | BRENDA TENNYSON |
| 9/3/2024 | AMAZON.COM*RK8E22IT1 | \$718.65 | BRENDA TENNYSON |
| 9/9/2024 | AMAZON MARK* ZT74W89I0 | \$223.96 | BRENDA TENNYSON |
| 9/9/2024 | AMAZON RETA* ZT4B38721 | \$35.06 | BRENDA TENNYSON |
| 9/10/2024 | AMAZON MARK* Z82E40NU0 | \$134.95 | BRENDA TENNYSON |
| 8/14/2024 | AMAZON MKTPL*RM0Z05WA2 | \$133.03 | LYDIA VANDERPOEL |
| 8/23/2024 | AMZN MKTP US*R40UO8QY2 | \$197.81 | LYDIA VANDERPOEL |
| 8/26/2024 | HOBBY LOBBY #685 | \$56.31 | LYDIA VANDERPOEL |
| 8/28/2024 | DOLLARTREE | \$48.50 | LYDIA VANDERPOEL |
| 9/9/2024 | AMAZON MKTPL*ZT6104QL0 | \$163.37 | LYDIA VANDERPOEL |
| 9/10/2024 | AMAZON MARK* Z82AH0LW0 | \$21.99 | LYDIA VANDERPOEL |
| | GRAND TOTAL | <u>\$143,904.39</u> | |

Report Criteria:

Including employee hash and count

Pay Code Summary

| PC | Pay Code Title | Amount | PC | Pay Code Title | Amount | PC | Pay Code Title | Amount |
|-------|-----------------|-----------|-------|------------------|------------|-------|-------------------|-----------|
| 1-01 | HOURLY | 76,262.26 | 1-02 | SALARY | 58,702.81 | 15-01 | FIRE RUNS | 65.25 |
| 15-02 | FIRE TRAINING | 235.63 | 15-04 | FIRE CALL IN | 80.37 | 15-06 | FIRE OVERTIME | 328.60 |
| 15-08 | FIRE STIPEND | 581.24 | 2-00 | OVERTIME | 10,380.14 | 21-00 | INSURANCE OPT O | 2,344.49 |
| 23-00 | DEFERRED COMP | 489.44 | 29-00 | HSA DEPOSIT FOR | 1,458.07 | 4-00 | VACATION | 5,130.28 |
| 40-00 | HSA | 1,458.07- | 41-01 | MISSION SQUARE | 2,511.50- | 41-02 | NORTH SHORE | 1,823.23- |
| 42-01 | ACCIDENT INSURA | 29.19- | 42-02 | ACCIDENT AFTER T | 3.87- | 42-03 | DISABILITY | 24.84- |
| 43-00 | HEALTH INSURANC | 2,913.26- | 45-00 | VISION INSURANCE | 101.55- | 49-00 | IAFF LOCAL 5241 U | 901.19- |
| 5-00 | SICK | 3,182.55 | 50-01 | WRS GENERAL | 7,274.73- | 50-02 | WRS PROTECTIVE | 2,669.13- |
| 51-00 | WAGE GARNISHME | 543.84- | 6-00 | COMP TIME | 843.52 | 74-00 | SOCIAL SECURITY | 9,555.72- |
| 75-00 | MEDICARE | 2,234.82- | 76-00 | FEDERAL WITHHOL | 13,581.43- | 77-00 | STATE WITHHOLDI | 6,075.31- |
| 86-00 | DIRECT DEPOSIT | 108,382.9 | | | | | | |

GROSS \$157,783.06

Report Criteria:

Including employee hash and count

Pay Code Summary

| PC | Pay Code Title | Amount | PC | Pay Code Title | Amount | PC | Pay Code Title | Amount |
|-------|-------------------|-----------|-------|-----------------|------------|-------|-------------------|-----------|
| 1-01 | HOURLY | 75,924.06 | 1-02 | SALARY | 58,702.81 | 1-03 | VILLAGE BOARD | 2,890.28 |
| 15-01 | FIRE RUNS | 81.56 | 15-02 | FIRE TRAINING | 163.13 | 15-03 | FIRE HOLIDAY 1.5X | 297.72 |
| 15-05 | HOLIDAY 2X | 3,460.23 | 15-08 | FIRE STIPEND | 581.24 | 2-00 | OVERTIME | 1,217.29 |
| 20-00 | TAXABLE LIFE INSU | 161.06 | 21-00 | INSURANCE OPT O | 2,344.49 | 23-00 | DEFERRED COMP | 489.44 |
| 29-00 | HSA DEPOSIT FOR | 1,458.07 | 4-00 | VACATION | 1,174.99 | 40-00 | HSA | 1,458.07- |
| 41-01 | MISSION SQUARE | 2,511.50- | 41-02 | NORTH SHORE | 1,823.23- | 42-01 | ACCIDENT INSURA | 29.19- |
| 42-02 | ACCIDENT AFTER T | 3.87- | 42-03 | DISABILITY | 24.84- | 43-00 | HEALTH INSURANC | 2,913.26- |
| 45-00 | VISION INSURANCE | 101.55- | 5-00 | SICK | 3,205.86 | 50-01 | WRS GENERAL | 7,260.84- |
| 50-02 | WRS PROTECTIVE | 2,479.44- | 6-00 | COMP TIME | 204.49 | 74-00 | SOCIAL SECURITY | 9,387.57- |
| 75-00 | MEDICARE | 2,195.53- | 76-00 | FEDERAL WITHHOL | 13,337.75- | 77-00 | STATE WITHHOLDI | 6,036.03- |
| 8-00 | HOLIDAY | 5,016.11 | 86-00 | DIRECT DEPOSIT | 107,649.1 | | | |

GROSS \$155,710.27

Report Criteria:
 Report type: GL detail
 Vendor.Vendor number = 2
 Check.Type = {<-} "Adjustment"

| Check Issue Date | Check Number | Payee | Description | Amount | Check GL Account | Invoice GL Account Title |
|------------------|--------------|--------------|---|--------|------------------|---------------------------|
| 09/11/2024 | 68285 | ACE HARDWARE | ROLLER COVER | 14.38 | 100-21100 | Due from Haass Library |
| 09/11/2024 | 68285 | ACE HARDWARE | SAND DISC, SCREWS, BRUSH, SPACKLE | 62.96 | 100-21100 | Maint--Bldg & Facilities |
| 09/11/2024 | 68285 | ACE HARDWARE | LED LIGHTS | 21.56 | 100-21100 | Due from Haass Library |
| 09/11/2024 | 68285 | ACE HARDWARE | SEALANT-BOOSTER BLDG | 5.39 | 610-21100 | Maint of Other Plant/Equ |
| 09/11/2024 | 68285 | ACE HARDWARE | DOOR HOLDS, SCREWS-THE GROVE | 18.18 | 100-21100 | Maint--Bldg & Facilities |
| 09/11/2024 | 68285 | ACE HARDWARE | SPACKLE, SCREWS | 15.56 | 100-21100 | Maint--Bldg & Facilities |
| 09/11/2024 | 68285 | ACE HARDWARE | H/W, COUPLING | 5.53 | 610-21100 | Maint of Mains |
| 09/11/2024 | 68285 | ACE HARDWARE | UNION BRASS COMP | 4.13 | 610-21100 | Maint of Mains |
| 09/11/2024 | 68285 | ACE HARDWARE | SCREWS | 3.39 | 610-21100 | Trtmt-Maint of Equipment |
| 09/11/2024 | 68285 | ACE HARDWARE | DETAILING TOWELS | 12.59 | 610-21100 | Maint of Meters |
| 09/11/2024 | 68285 | ACE HARDWARE | KEYS | 10.75 | 100-21100 | Maint--Bldg & Facilities |
| 09/11/2024 | 68285 | ACE HARDWARE | INSECT SPRAY, SEALANT | 22.25 | 610-21100 | Maint of Other Plant/Equ |
| 09/11/2024 | 68285 | ACE HARDWARE | INSECT SPRAY | 24.07 | 610-21100 | Maint of Other Plant/Equ |
| 09/11/2024 | 68285 | ACE HARDWARE | TRAY SET, ROLLERS | 16.72 | 100-21100 | Maint--Bldg & Facilities |
| 09/11/2024 | 68285 | ACE HARDWARE | SEALANT | 7.19 | 100-21100 | Maint--Bldg & Facilities |
| 09/11/2024 | 68285 | ACE HARDWARE | DOOR STOP | 6.29 | 100-21100 | Maint--Bldg & Facilities |
| 09/11/2024 | 68285 | ACE HARDWARE | ROLLERS | 8.99 | 100-21100 | Maint--Bldg & Facilities |
| 09/11/2024 | 68285 | ACE HARDWARE | WELD EPOXY | 8.63 | 620-21100 | Maint--General Plant |
| 09/11/2024 | 68285 | ACE HARDWARE | SEALANT | 5.39 | 610-21100 | Maint of Other Plant/Equ |
| 09/11/2024 | 68285 | ACE HARDWARE | NOTIONS & MISC | 4.93 | 610-21100 | Maint of Other Plant/Equ |
| 09/11/2024 | 68285 | ACE HARDWARE | SHUTOFF VALVE | 11.69 | 100-21100 | Contract--Misc Sanitation |
| 09/11/2024 | 68285 | ACE HARDWARE | TAP LIGHT | 20.94 | 100-21100 | Contract--Misc Sanitation |
| 09/11/2024 | 68285 | ACE HARDWARE | PRUNER, LOPPER | 70.18 | 100-21100 | Horticulture |
| 09/11/2024 | 68285 | ACE HARDWARE | UTIL KNIFE, VELCRO, KEY STEM, NOZZLE, HOS | 107.23 | 100-21100 | Contract--Misc Sanitation |
| 09/11/2024 | 68285 | ACE HARDWARE | H/W | 21.48 | 100-21100 | Maint--Equipment |
| 09/11/2024 | 68285 | ACE HARDWARE | DRILL BITS | 17.72 | 100-21100 | Maint--Equipment |
| 09/11/2024 | 68285 | ACE HARDWARE | P/U TOOL, TAPE, HITCH PIN, PAIL | 112.44 | 100-21100 | Contract--Misc Sanitation |
| 09/11/2024 | 68285 | ACE HARDWARE | DRILL BIT, TUBE STRAP | 33.76 | 100-21100 | Maint--Equipment |
| 09/11/2024 | 68285 | ACE HARDWARE | SCREWS | 14.99 | 100-21100 | Maint--Equipment |
| 09/11/2024 | 68285 | ACE HARDWARE | LAMP CLAMPS, LED LIGHTS | 57.56 | 100-21100 | Special Events |
| 09/11/2024 | 68285 | ACE HARDWARE | FERTILIZER | 30.59 | 100-21100 | Horticulture |
| 09/11/2024 | 68285 | ACE HARDWARE | ROD, H/W | 32.85 | 100-21100 | Maint--Equipment |
| 09/11/2024 | 68285 | ACE HARDWARE | DRILL BIT | 23.19 | 100-21100 | Maint--Equipment |
| 09/11/2024 | 68285 | ACE HARDWARE | CLEAN CLOTH | 20.69 | 100-21100 | Contract--Misc Sanitation |
| 09/11/2024 | 68285 | ACE HARDWARE | OIL | 37.67 | 100-21100 | Maint--Equipment |

| Check Issue Date | Check Number | Payee | Description | Amount | Check GL Account | Invoice GL Account Title |
|------------------|--------------|--------------|--------------------------|----------|------------------|---------------------------|
| 09/11/2024 | 68285 | ACE HARDWARE | SCREWS | 12.49 | 100-21100 | Contract--Misc Sanitation |
| 09/11/2024 | 68285 | ACE HARDWARE | DRILL BIT | 30.92 | 100-21100 | Maint--Equipment |
| 09/11/2024 | 68285 | ACE HARDWARE | LOCK LEVER | 67.49 | 100-21100 | Maint--Bldg & Facilities |
| 09/11/2024 | 68285 | ACE HARDWARE | LOCK LEVER | 40.49 | 100-21100 | Maint--Bldg & Facilities |
| 09/11/2024 | 68285 | ACE HARDWARE | TAPE | 6.83 | 100-21100 | Contract--Misc Sanitation |
| 09/11/2024 | 68285 | ACE HARDWARE | FLOOR CLEANER | 12.59 | 100-21100 | Contract--Misc Sanitation |
| 09/11/2024 | 68285 | ACE HARDWARE | POST HOLE DIGGER, SHOVEL | 70.18 | 100-21100 | Tools |
| 09/11/2024 | 68285 | ACE HARDWARE | HOSE HOT WTR | 71.98 | 100-21100 | Maint--Bldg & Facilities |
| 09/11/2024 | 68285 | ACE HARDWARE | SCREWS | 6.30 | 100-21100 | Maint--Bldg & Facilities |
| 09/11/2024 | 68285 | ACE HARDWARE | SCREWS, RETURN SCREWS | .70 | 100-21100 | Maint--Bldg & Facilities |
| 09/11/2024 | 68285 | ACE HARDWARE | BUSHING PVC | 36.85 | 100-21100 | Maint--Bldg & Facilities |
| Grand Totals: | | | | 1,248.68 | | |

MEMORANDUM

To: Gabe Gilbertson, Community Development Director
From: Judith A. Neu, Village Engineer
Date: October 3, 2024
Re: Hackbarth CSM – Maple Avenue

Following are comments and concerns of Engineering and Community Development staff regarding the CSM dated September 27, 2024, that was created by Surveyor Hilmer & Associates, LLC, for Curtis and Sharon Hackbarth Living Trust (W239N7456 Maple Avenue) and received in this office on October 2, 2024.

1. The following setbacks need to be dimensioned on the CSM:
 - a. Shed on Lot 1 to Maple Avenue.
 - b. Residence on Lot 2 to the north, south and east lot lines.
 - c. Residence on Lot 30, Pine Ridge Addition #1 to the south lot line of CSM.
2. There are two existing storm easements (PLE's) within this CSM that need to be shown on the CSM per 18.0602(O) of the Municipal Code. One is on Lot 1, the other is on Lot 2.
3. The owner may want to consider using this CSM to create an easement on Lot 2 for the benefit of Lot 1 from the end of the Storm Easement to the east lot line to preserve the discharge point for the pond. Otherwise, the owners of lot 2 could inadvertently fill in a corner of their lot and block the flow path.
4. The Hackbarth family has two of the existing lots within the ownership of an entity called Maple Pond LLC. Therefore, that entity must be listed as an owner on page 1 of the CSM and have an owners certificate similar to that shown on page 3 of the CSM.
5. The lines labeled "Environmental Corridor" are actually the Isolated Natural Resource Area boundaries. Please relabel. It matters because INRA rules are less restrictive than other environmental corridor rules.
6. The 2 foot strip of land south of this CSM is actually Outlot 2, Hidden Hills, not Outlot 1.
7. Per 18.0602(B) the owners phone number must also be listed on the CSM.
8. Pere 236.20(4)(b) please label the Maple Avenue right of way "Dedicated to the Public".
9. On the Surveyor's Certificate, in the call regarding Outlot 1 of Hidden Hills, please remove reference to the north line of Outlot 1. The CSM only touches the south and west lines of Outlot 1.
10. In the Notes below the Surveyor's Certificate:
 - a. Please change "environmental corridor" to "Isolated Natural Resource Area".
 - b. Capitalize GIS.



Celebrating 100 YEARS | 1924-2024

- c. Add the following sentence: “Any proposed structures or construction may require a wetland delineation be completed.”
11. The signature date on the Surveyor’s Certificate should match the revision date at the bottom of the page.
12. On sheet 4, please review the Wetland/Floodplain/Primary Environmental Corridor restrictions to reflect the fact that there is no primary corridor on this property. I’d just change PEC to INRA.
13. The Basement Restriction – Groundwater needs to be revised. I’ve attached an example of both bedrock and groundwater typical language for review. The language on the CSM references Waukesha County codes, which do not apply, and Town of Merton, which is not where this CSM is located. In addition, there is a typographical error – the word regarding is missing a “d”.

If you have any questions or comments, please respond in writing.

Certified Survey Map

being a part of the Northwest Quarter of the Southwest Quarter of Section 14, Town 8 North, Range 19 East in the Village of Sussex, Waukesha County, Wisconsin.

Prepared for:
The Curtis and Sharon Hackbarth
Living Trust
W239N7456 Maple Ave.
Lisbon, WI. 53089
(262)366-2428

Prepared for:
Maple Pond, LLC
Curt Hackbarth, Member
W239N7456 Maple Ave.
Sussex, WI. 53089
(262)366-2428

Legend:

- indicates 1" iron pipe found.
- ⊕ indicates 2" iron pipe found.
- indicates 1" x 18" iron pipe set, weighing 1.68 lbs./ft.
- ⊙ indicates 3/4" iron rod found.
- ⊠ indicates Mon. w/brass cap found.

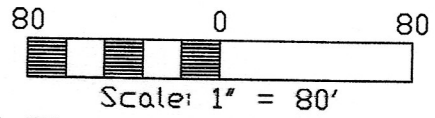

NOTES:

- bearings are based on the West line of the SW 1/4 of Section 14-8-19 as S 00°01'34" W, Wisconsin State Plane Coordinates, South Zone.
- See additional Notes on Sheet 2.

W 1/4 Corner, Sec. 14-8-19
Conc. Mon. w/brass cap.
N=426178.64, E= 2427031.34

Prepared by:
Hilmer & Associates LLC
Paul J. Hilmer, PLS
W217 Vista Drive
Oconomowoc, WI. 53066
(262) 567-5893

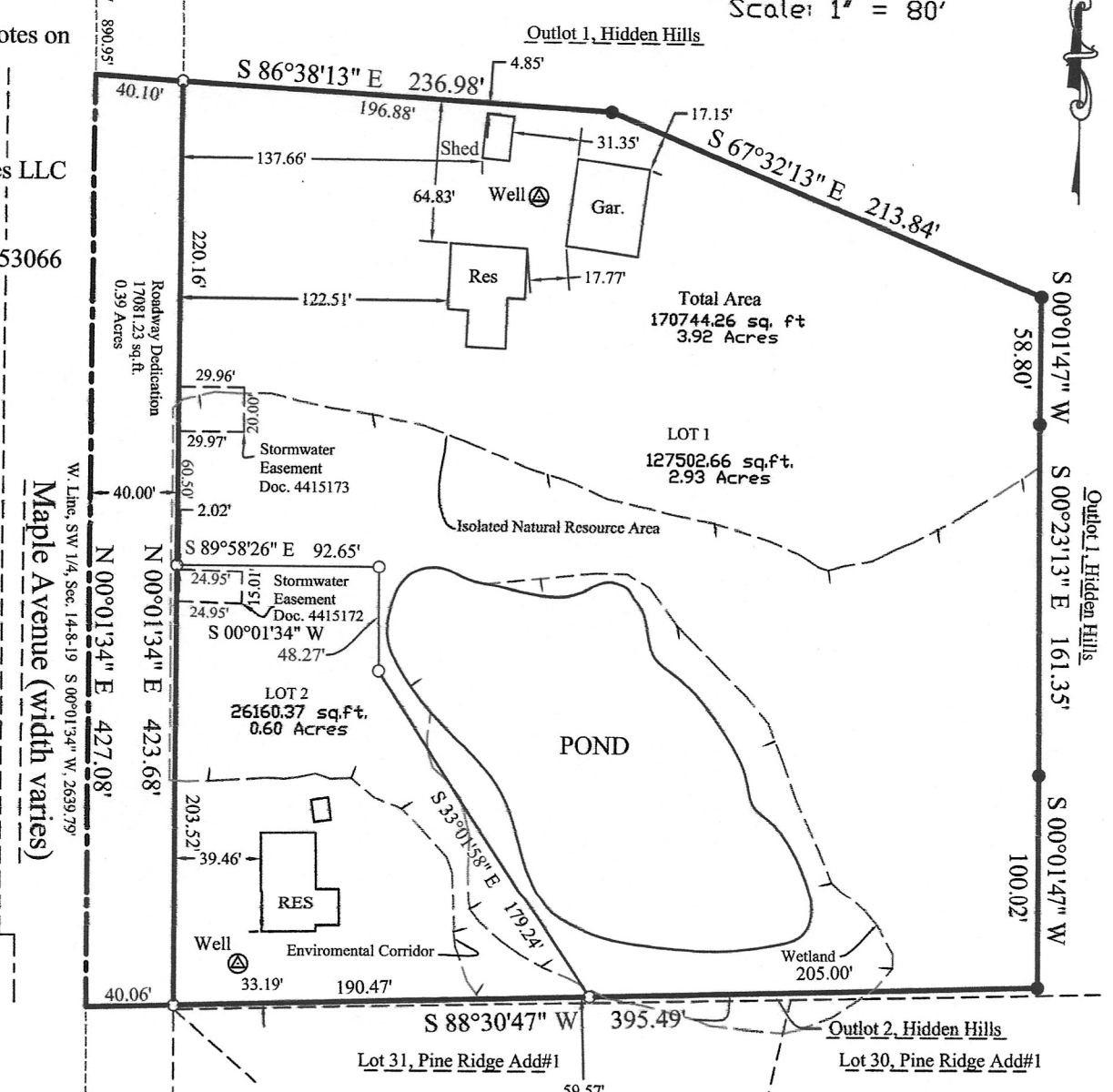

Maple Avenue (width varies)

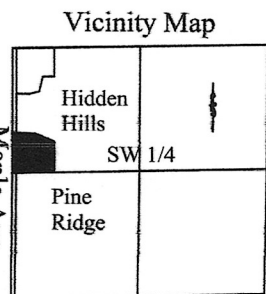

SW Cor., SW 1/4, Sec. 14-8-19
Conc. Mon. w/brass cap.
N= 423539.13, E= 2427030.15

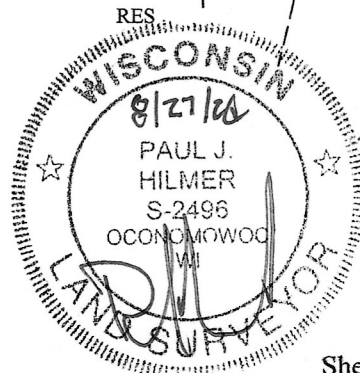

SW 1/4, Sec. 14-8-19
SCALE: 1" = 2000'

Rev. 10/13/24
Rev. 9/27/24

This instrument drafted by Paul J. Hilmer

Certified Survey Map

being a part of the Northwest Quarter of the Southwest Quarter of Section 14, Town 8 North, Range 19 East in the Village of Sussex, Waukesha County, Wisconsin.

SURVEYORS CERTIFICATE

State of Wisconsin)
County of Jefferson) SS

I, Paul J. Hilmer, Professional Land Surveyor, do hereby certify: That I have surveyed, divided, mapped and dedicated a parcel of land being in the Northwest Quarter of the Southwest Quarter of Section 14, Town 8 North, Range 19 East, in the Village of Sussex, Waukesha County, Wisconsin, bounded and described as follows: Commencing at the West Quarter corner of said Section 14, thence S 00°01'34" W, along the West line of said Southwest Quarter and the Centerline of Maple Ave., 890.95 feet to the point of beginning of the lands hereinafter described: Thence along the South, West and lines of Outlot 1, Hidden Hills the following courses; S 86°38'13" E, 236.98', thence S 67°32'13" E, 213.84 feet; thence S 00°01'47" W, 58.80 feet; thence S 00°23'13" E, 161.35 feet; thence S 00°01'47" W, 100.02 feet; thence S 88°30'47" W along the North line of Outlot 2, Hidden Hills, 395.49 feet to the West line of said Southwest Quarter and the Centerline of Maple Ave., thence N 00°01'34" E, 427.08 feet to the point of beginning.

Said lands containing 170744.26 square feet or 3.92 Acres of land.

That I have made such survey and map by the direction of The Curtis and Sharon Hackbarth Living Trust and Maple Pond, LLC, owners of said land.

That such map is a correct representation of all exterior boundaries of the land surveyed and the land divisions thereof made.

That I have fully complied with the provisions of Chapter 236.34 of the Wisconsin Statutes and the subdivision regulations of the Village of Sussex in surveying, dividing and mapping the same.

Dated this 27th day of AUGUST 20 24 .

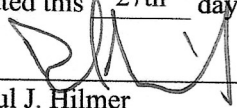
Paul J. Hilmer
Professional Land Surveyor # 2496
Hilmer & Associates, LLC

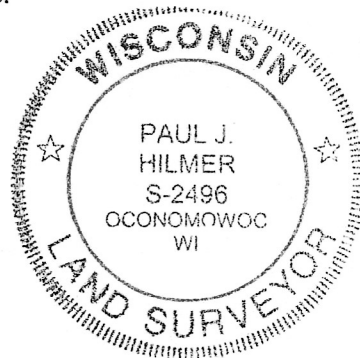

NOTES:

- The Isolated Natural Resource Area and wetland locations have been traced from the Waukesha County Gis mapping system and are shown for informational purposes only.
- Any proposed structures or construction may require a wetland delineation be completed.

Certified Survey Map _____

being a part of the Northwest Quarter of the Southwest Quarter of Section 14, Town 8 North, Range 19 East in the Village of Sussex, Waukesha County, Wisconsin.

OWNER'S CERTIFICATE

As owner, The Curtis and Sharon Hackbarth Living Trust, Curtis and Sharon Hackbarth, Trustees, do hereby certify that we have caused the land described on this map to be surveyed, divided, mapped and dedicated as represented on this map. We also certify that this map is required by Chapter 236.34 of the Wisconsin Statutes and the Subdivision Regulations of the Village of Sussex and must be submitted to the following for approval:

1) Village of Sussex

Witness the hand and seal of said owner this _____ day of _____, 20__.

Curtis Hackbarth, Trustee

Sharon Hackbarth, Trustee

State of Wisconsin)

_____ Wisconsin) SS

Personally came before me this _____ day of _____, 20__, The Curtis and Sharon Hackbarth Living Trust, Curtis and Sharon Hackbart, Trustees, to be known to be the persons whom executed the foregoing instrument and acknowledged the same.

(Notary seal) _____

Notary Public, _____, Wisconsin.

My commission expires _____.

CONSENT OF CORPORATE MORTGAGEE

_____, a corporation duly organized and existing under and by virtue of the laws of the State of Wisconsin, mortgagee of the above described land, does hereby consent to the surveying, dividing and mapping of the land described on this map, and does hereby consent to the above certificate of _____ owners.

IN WITNESS WHEREOF, the said _____, has caused these presents to be signed by _____, its _____, and countersigned by _____, its _____, at _____, Wisconsin, and its corporate seal to be hereunto affixed this _____, day of _____, 20__.

In the presence of

Corporate name

Countersigned (Corporate seal)

State of Wisconsin)

_____ County) SS

Personally came before me this _____ day of _____, 20__, _____, _____, and _____, of said corporation, and acknowledged that they executed the foregoing instrument as such officers as the deed of said corporation, by its authority.

(Notary Seal) _____

Notary Public, _____, Wisconsin.

My commission expires _____.

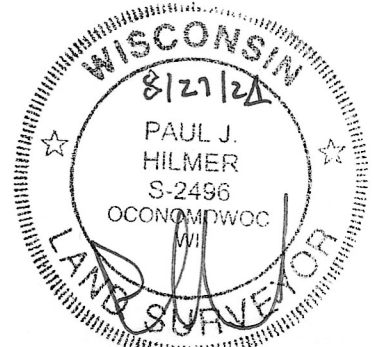

Certified Survey Map _____

being a part of the Northwest Quarter of the Southwest Quarter of Section 14, Town 8 North, Range 19 East in the Village of Sussex, Waukesha County, Wisconsin.

OWNER'S CERTIFICATE

As owner, Maple Pond, LLC, Curtis and Sharon Hackbarth, members, do hereby certify that we have caused the land described on this map to be surveyed, divided, mapped and dedicated as represented on this map. We also certify that this map is required by Chapter 236.34 of the Wisconsin Statutes and the Subdivision Regulations of the Village of Sussex and must be submitted to the following for approval:

1) Village of Sussex

Witness the hand and seal of said owner this _____ day of _____, 20____.

Curtis Hackbarth, Member

Sharon Hackbarth, Member

State of Wisconsin)

Wisconsin) SS

Personally came before me this _____ day of _____, 20____, Maple Pond, LLC, Curtis and Sharon Hackbart, Members, to be known to be the persons whom executed the foregoing instrument and acknowledged the same.

(Notary seal) _____
Notary Public, _____, Wisconsin.
My commission expires _____.

BASEMENT RESTRICTION- BEDROCK NOTE:

Although all lots in this Certified Survey Map have been reviewed and approved for development of single family residential use in accordance with Section 236 Wisconsin Statutes, some lots contain soil conditions that, due to the possible presence of bedrock near the ground surface, may require additional soil engineering and foundation design with regard to basement construction. It is recommended that a licensed professional engineer design a basement and foundation that will be suitable to withstand the various problems associated with saturated soil condition on basement walls or floors or that other special measures be taken. Soil conditions should be subject to each owner's special investigation prior to construction and no specific representation is made herein.

Per the Village of Sussex Storm Water Management Ordinance under subsurface drainage. Basement Floor surfaces shall be built a minimum of one (1) foot above the seasonal high groundwater table elevation, as Documented in the submitted soil evaluations, and shall avoid Hydric soils as much as possible.

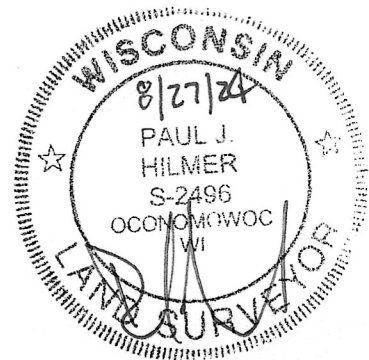

Rev. 10/13/24
Rev. 9/27/24

This instrument drafted by Paul J. Hilmer

Sheet 4 of 5 sheets.

Certified Survey Map _____

being a part of the Northwest Quarter of the Southwest Quarter of Section 14, Town 8 North, Range 19 East in the Village of Sussex, Waukesha County, Wisconsin.

VILLAGE PLAN COMMISSION APPROVAL

Approved by the Plan Commission of the Village of Sussex on this _____ day of _____, 20__.

Anthony LeDonne, Chairperson

Jennifer Moore- Clerk

VILLAGE BOARD APPROVAL

Approved by the Village Board of the Village of Sussex on this _____ day of _____, 20__.

Anthony LeDonne, Village President

Jennifer Moore, Clerk

ISOLATED NATURAL RESOURCE AREA RESTRICTIONS

Those areas of land identified as Isolated Natural Resource Area on Page 1 of 4 of this Certified Survey Map shall be subject to the following restrictions:

1. Grading, filling, removal of topsoil or other earthen materials are prohibited, unless specifically authorized by the municipality in which this land is located and, if applicable, the Village of Sussex, the Wisconsin Department of Natural Resources and the Army Corps of Engineers.
2. The removal or destruction of any invasive vegetative cover, i.e., trees, shrubs, grasses, etc., is prohibited, with the exception that dead, diseased, or dying vegetation may be removed, at the discretion of the landowner and with approval from the Village of Sussex. Silvicultural thinning, upon the recommendation of a forester or naturalist and with the approval from the Village of Sussex, shall also be permitted.
3. Grazing by domesticated animals, i.e., horses, cows, etc., is prohibited.
4. The introduction of plant material not indigenous to the existing environment is prohibited.
5. Ponds may be permitted subject to the approval of the municipality in which they are located and if applicable, the Wisconsin Department of Natural Resources and the Army Corps of Engineers.
6. The construction of buildings is prohibited.

BASEMENT RESTRICTION- GROUNDWATER

Although all lots in this Certified Survey Map have been reviewed and approved for development of single family residential use in accordance with Section 236 Wisconsin Statutes, some lots contain soil conditions that, due to the possible presence of groundwater near the surface, may require additional soil engineering and foundation design with regard to basement construction. It is recommended that a licensed professional engineer design a basement and foundation that will be suitable to withstand the various problems associated with saturated soil condition on basement walls or floors or that other special measures be taken. Soil conditions should be subject to each owner's special investigation prior to construction and no specific representation is made herein.

Per the Village of Sussex Storm Water Management Ordinance under subsurface drainage. Basement Floor surfaces shall be built a minimum of one (1) foot above the seasonal high groundwater table elevation, as Documented in the submitted soil evaluations, and shall avoid Hydric soils as much as possible.

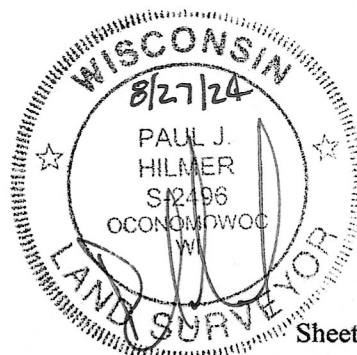

Rev. 10/13/24
Rev. 9/27/24

This instrument drafted by Paul J. Hilmer

Sheet 5 of 5 sheets.

VILLAGE OF SUSSEX

PUBLIC WORKS COMMITTEE

BILLS FOR PAYMENT

10/22/2024

| VENDOR | AMOUNT | | %COMPLETED | NOTES |
|---------------------------|--------------|--|------------|------------------------------------|
| CEDAR CORPORATION | \$ 1,918.75 | VILLAGE PARK PROJECTS - PROF. SERV. THRU 9/21/2024 | 9% | |
| CEDAR CORPORATION | \$ 1,273.23 | CAPITAL - ASSOCIATED BANK PATH SURVEY - PROF. SERV. THRU 9/21/2024 (2025 ROAD PROGRAM) | 100% | |
| CEDAR CORPORATION | \$ 7,920.36 | GOLDEN FIELDS - PROF. SERV. THRU 9/21/2024 | ONGOING | BILL TO DEVELOPER: KAEREK HOMES |
| POWRTEK ENGINEERING, INC. | \$ 1,475.00 | VOS EMERGENCY GENERATOR DESIGN - PROF. SERV. SEPT 2024 | 70.0% | |
| POWRTEK ENGINEERING, INC. | \$ 5,308.55 | VOS EMERGENCY GENERATOR DESIGN - PROF. SERV. AUG 2024 | 65.6% | |
| R. A. SMITH | \$ 16,127.61 | VISTA RUN PHASE 3 - PROF. SERV. AUG 2024 | ONGOING | BILL TO DEVELOPER: NEUMANN |
| RUEKERT & MIELKE, INC. | \$ 117.00 | 2024 GIS - PROF SERV. THRU 9/6/2024 - 2025 ROAD PROGRAM | ONGOING | |
| RUEKERT & MIELKE, INC. | \$ 624.39 | REDFORD HILLS SUBDIVISION - PROF. SERV. 8/10-9/6/2024 | ONGOING | BILL TO DEVELOPER: CAS INVESTMENTS |
| TOTAL | \$ 34,764.89 | | | |

2025 SUSSEX WASTEWATER TREATMENT FACILITY

REHABILITATION PROJECT AGREEMENT

BETWEEN THE VILLAGE OF SUSSEX, THE VILLAGE OF LANNON, THE VILLAGE OF LISBON AND THE VILLAGE OF MENOMONEE FALLS

This Agreement entered upon full execution by all Contract Communities and effective the ____ day of _____, 2024, by and between the Village of Sussex, hereinafter referred to as "Sussex", a municipal corporation organized and existing under the laws of the State of Wisconsin, and the Villages of Lannon, Lisbon, and Menomonee Falls, all being a municipal corporation organized and existing under the laws of the State of Wisconsin, hereinafter individually referred to as "Lannon", "Lisbon", "Menomonee Falls" and individually and together referred to respectively as "Contract Community" or "Contract Communities".

WITNESSETH:

WHEREAS, Sussex owns and operates a wastewater treatment facility, ("SWTF") which has been designated as an area wide regional treatment facility by the Southeastern Wisconsin Regional Planning Commission and the Wisconsin Department of Natural Resources, and;

WHEREAS, the Contract Communities utilize the SWTF and have bought capacity in the SWTF for both today's future needs, and;

WHEREAS, the SWTF was last upgraded in 2008 and some components of the SWTF have not been upgraded for over 40 years, and;

WHEREAS, the SWTF is in need of significant maintenance and rehabilitation work; accordingly, Sussex has planned for the project known as the 2025 SWTF Rehabilitation Project (the "2025 SWTF Rehab Project"), and;

WHEREAS, the Contract Communities and Sussex are entering into this Agreement for the joint governmental purpose of maintenance and rehabbing the SWTF so that it may continue to provide sewerage treatment services to Sussex and the Contract Communities, and;

WHEREAS, the Contract Communities and Sussex have through previous agreements and projects provided for and implemented cost sharing for expansion and or large maintenance/rehab projects such as the 2025 SWTF Rehab Project.

NOW, THEREFORE, pursuant to 66.0301 of the Wisconsin Statutes and upon the mutual covenants and agreements of the parties contained herein and the mutual benefits to be derived from this Agreement, the parties hereto agree as follows:

I. DEFINITIONS

- 1.1 AGREEMENT. "AGREEMENT" SHALL MEAN THIS DOCUMENT TOGETHER WITH THE EXHIBITS ATTACHED HERETO.
- 1.2 PREVIOUS AGREEMENTS. "PREVIOUS AGREEMENTS" SHALL MEAN THE VARIOUS AND MULTIPLE AGREEMENTS IN EFFECT BETWEEN SUSSEX AND THE CONTRACT COMMUNITIES WITH RESPECT TO OPERATION AND PREVIOUS CAPITAL PROJECTS FOR THE SWTF.
- 1.3 CAPACITY ALLOCATION. "CAPACITY ALLOCATION" SHALL MEAN THE RIGHT TO DISCHARGE WASTEWATER TO THE SUSSEX WASTEWATER TREATMENT FACILITY UP TO THE LIMITS SET FORTH IN PREVIOUS AGREEMENTS, WHICH FOR PURPOSES OF THIS AGREEMENT IS BASED ON GALLONS PER DAY AVERAGE DAILY FLOW "GPD ADF".
- 1.4 PROJECT. "PROJECT" SHALL MEAN THE 2025 SWTF REHAB PROJECT. A GENERAL OUTLINE OF THE REHAB WORK NECESSARY IS ATTACHED AS EXHIBIT A, ENTITLED REHAB WORK.
- 1.5 PROJECT COSTS. "PROJECT COSTS" SHALL MEAN ANY PLANNING, DESIGN, REGULATORY APPROVAL, MATERIALS/EQUIPMENT, CONSTRUCTION, PROJECT MANAGEMENT, INSPECTION COSTS, AND INTERNAL STAFF TIME FOR THE PROJECT. SOME OF THESE PROJECT COSTS PRE-DATE THE AGREEMENT AND ARE INTENDED TO BE INCLUDED.
- 1.6 SUSSEX WASTEWATER TREATMENT FACILITY. "SWTF" SHALL MEAN THE SUSSEX REGIONAL WASTEWATER TREATMENT FACILITY AND ALL OF ITS EQUIPMENT, BUILDINGS, AND COMPONENTS WHICH IS SOLELY OWNED BY SUSSEX.

II. CONTINUATION OF SERVICE

- 2.1 Sussex will continue to operate and maintain the SWTF and bill the Contract Communities for treatment services based upon the rates established and updated from time to time per PREVIOUS AGREEMENTS between Sussex and the Contract Communities.

2.2. This AGREEMENT shall modify the PREVIOUS AGREEMENTS SECTION 7.3 (LANNON) or 7.4 (LISBON AND MENOMONEE FALLS) as appropriate to extend the PREVIOUS AGREEMENTS Term of Contract date from 2025 to 2040 for all Contract Communities.

III. INTENT OF AGREEMENT.

Sussex has entered into design engineering contract(s) to evaluate and prepare specifications for bid for the PROJECT to ensure the SWTF can treat wastewater for Sussex and its Contract Communities. Sussex intends to bid the PROJECT for construction management by Sussex and /or outside inspection services with completion of the PROJECT by late 2025. The Contract Communities have obligations to pay for their pro-rata share of costs of the PROJECT based upon the percentage of the CAPACITY ALLOCATION in the SWTF.

III. CAPACITY ALLOCATION, PROJECT COST, AND BILLING

3.1 CAPACITY ALLOCATIONS

Lannon has 300,000 GPD ADF CAPACITY ALLOCATION which is 5.88% of the SWTF.

Lisbon has 931,140 GPD ADF CAPACITY ALLOCATION which is 18.25% of the SWTF.

Menomonee Falls has 1,100,000 GPD ADF CAPACITY ALLOCATION which is 21.57% of the SWTF

Sussex has 2,277,000 GPD ADF CAPACITY ALLOCATION which is 54.30% of the SWTF.

Each of the Contract Communities shall owe to SUSSEX its pro-rata CAPACITY ALLOCATION SHARE which is the Percentage from this section for Each Contract Community multiplied by the total cost of the PROJECT COSTS.

3.2 PROJECT COSTS

The estimate of the PROJECT COST at the time of the AGREEMENT is \$3.5 million. It is understood by the Contract Communities and Sussex that due to unknown factors and the variability of bidding climates and factors beyond the control of Sussex that the PROJECT COST is subject to change and the Contract Communities will be billed based upon actual costs of the PROJECT. Sussex shall update the estimated PROJECT cost once a bid for the PROJECT has been accepted which shall be used for payments by the Contract Communities.

3.3. TIMING OF PAYMENTS

Each party shall secure its own financing and make payments on time to Sussex and in accordance with this AGREEMENT.

Contract Communities shall pay Sussex its share of the first payment which shall be equal to 60% of the estimated Project cost after acceptance of the bid for construction of the PROJECT by Sussex. It is anticipated that the first payment invoice will be sent around February 2025.

Contract Communities shall pay Sussex its share of the second payment which shall be equal to 35% of the estimated PROJECT cost after substantial completion of the PROJECT. It is anticipated that this second payment invoice will be sent around August 2025.

Contract Communities shall pay Sussex its share of the third payment, which shall be its share of the remaining actual PROJECT cost after Final completion of the PROJECT. It is anticipated that this third payment invoice will be sent around October 2025.

3.4 BILLING PROCEDURES

Sussex is managing the PROJECT on behalf of the Contract Communities and each Contract Community shall be liable for payment of all charges invoiced to it. Sussex shall bill each Contract Community for charges described in section III. Invoices shall be paid in full within 30 days after the date of billing, and if not so paid, the account shall be considered delinquent. Delinquent payments shall be subject to a late payment charge of 1.5% per month. Before any Contract Community can contest any charge or billing, the charge or billing shall first be paid in full.

IV. ADMINISTRATION OF AGREEMENT

4.1 TECHNICAL ADVISORY COMMITTEE

As a vehicle for dealing with the technical and financial details of this AGREEMENT and PREVIOUS AGREEMENTS, a Technical Advisory Committee (TAC) shall be maintained. This committee shall be composed of a single representative from Sussex and each Contract Community who shall inform and make recommendations to the respective governing body of the member communities. The TAC shall be informed of, and shall review, technical updates on the PROJECT as maybe necessary.

4.2 BOOKS AND RECORDS

Each Contract Community shall keep accurate books, records, and accounts of costs, expenses, expenditures, and receipts as they pertain to this AGREEMENT. Upon reasonable notice, any Contract Community shall be entitled to examine any such books and records of any of or all other Contract Communities.

4.3 DISPUTES

Discussion before dispute resolution. At least sixty (60) days before initiating dispute resolution to enforce this agreement, a Contract Community contemplating such dispute resolution shall so notify in writing to the opposing Contract Community and or Sussex and request a meeting to discuss and resolve the matter in contention. Prior to initiating any dispute resolution, all outstanding charges due and owing shall be satisfied. The Contract Community receiving such notification shall make itself available at reasonable times and places for such discussions and attempted resolution. The Contract Communities represent that they will each make a good faith effort to resolve any disputes that may arise between them.

4.4 ACCOUNTING METHODS

To the extent any provision of this AGREEMENT requires calculations involving accounting principles, those generally accepted accounting principles and practices utilized in maintenance of municipal and utility records, as determined by a certified public accounting firm practicing in Southeastern Wisconsin shall be utilized.

4.5 NOTICES

All notices required or permitted by this AGREEMENT shall be deemed given if made in writing and deposited in the United States mail, addressed as follows:

Village of Lannon, Clerk
20399 W. Main Street
Lannon, WI 53046

Village of Lisbon, Clerk
W234 N8676 Woodside Road
Sussex, WI 53089

Village of Sussex, Clerk
N64W23760 Main Street
Sussex, WI 53089

Village of Menomonee Falls, Clerk
W156N8480 Pilgrim Road
Menomonee Falls, WI 53051

V. MISCELLANEOUS

5.1 ENTIRE AGREEMENT

This AGREEMENT contains the entire agreement of the parties and may not be modified unless such a modification is in writing, approved by the governing body of each party, and duly executed by the authorized representative.

5.2 EFFECTIVE DATE

The effective date of this AGREEMENT is the date of signature from the last signing party.

5.3 EFFECT OF CONTRACT

Lannon and the Contract Communities recognize that this AGREEMENT is the product of a unique set of circumstances. Accordingly, it is mutually acknowledged that many of the provisions contained herein are unique unto themselves and should not be seen as precedent for any future Agreement between Sussex and other entities.

5.4 SEVERABILITY

If any clause, provision, or section of this AGREEMENT be declared invalid by any Court of competent jurisdiction, the invalidity of such clause, provision or section shall not affect any of the remaining provisions of this AGREEMENT.

5.5 BINDING AGREEMENT

This AGREEMENT is binding upon the parties hereto and their respective successors and assigns.

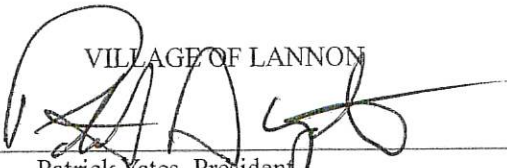
By: 
VILLAGE OF LANNON
Patrick Yates, President

By: 
VILLAGE OF MENOMONEE FALLS
Jeremy Walz, President

Date: 10/14/24

Date: 10-7-24

Attest: 
Brenda Klemmer, Clerk/Treasurer

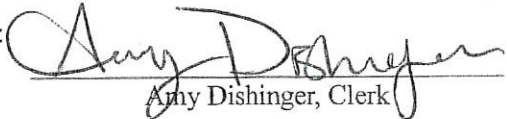
Attest: 
Amy Dishinger, Clerk

By: _____
VILLAGE OF SUSSEX
Anthony LeDonne, President

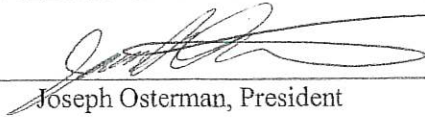
By: 
VILLAGE OF LISBON
Joseph Osterman, President

Date: _____

Date: September 11, 2024

Attest:

Jennifer Moore, Clerk

Attest:

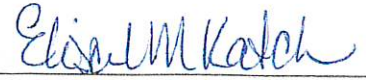

Elisa Cappozzo Katch, Clerk



N64W23760 Main Street
Sussex, Wisconsin 53089
(262) 246-5200
info@sussexwi.gov
villagesussex.org

TO: Village Board
FROM: Charlotte Abt, Recreation Coordinator
RE: Swimming Pool Feasibility Study Committee
DATE: October 18, 2024

The Village Board approved the Swimming Pool Feasibility Study Committee Structure at the August 27, 2024 meeting. This group will spend 2025 looking at options and making a recommendation to the Park Board and Village Board on aquatic facilities.

| Name | Address |
|-----------------|---|
| Jessica Zank | N65W24385 Elm Ave Sussex WI 53089 |
| Zachary Mathe | N62w23774 Sunset Drive, Sussex WI 53089 |
| Scott J Thomsen | N77W23171 Red Fox Cove, Sussex, WI 53089 |
| Kaitlin Thomas | N58W23777 HASTINGS CT UNIT 17, SUSSEX, WI 53089 |
| Chad Weber | W236N6564 Cotey Ct Sussex WI 53089 |
| Jin Pack | N71W23795 Lorraine Ct., Sussex, WI, 53089 |
| Bill Klockow | W228N7621 Woodland Ct, Sussex, WI 53089 |
| Zachary Werginz | W236N6564 Cotey Ct Sussex WI 53089 |